









HPI International Trading

-  HPI- Floor Plan- 132,500.00 SF
(include B3, Extension, Break Room, Offices and lobby)
-  Extension (office , conferences) 4,376.75 SF
-  Break Room 583.83 SF
-  Office area 5,363.40 SF
-  Lobby (lobby, conferences) 3,160.35 SF
-  Mezzanie - 7,000 SF
-  Generators Room - 1,050 SF.
-  Mechanical Room (1st Floor)- 3,284 SF
have a mezzanie

Right Elevation

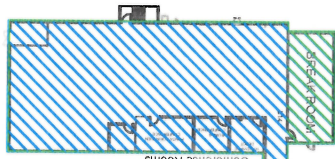

Front Elevation

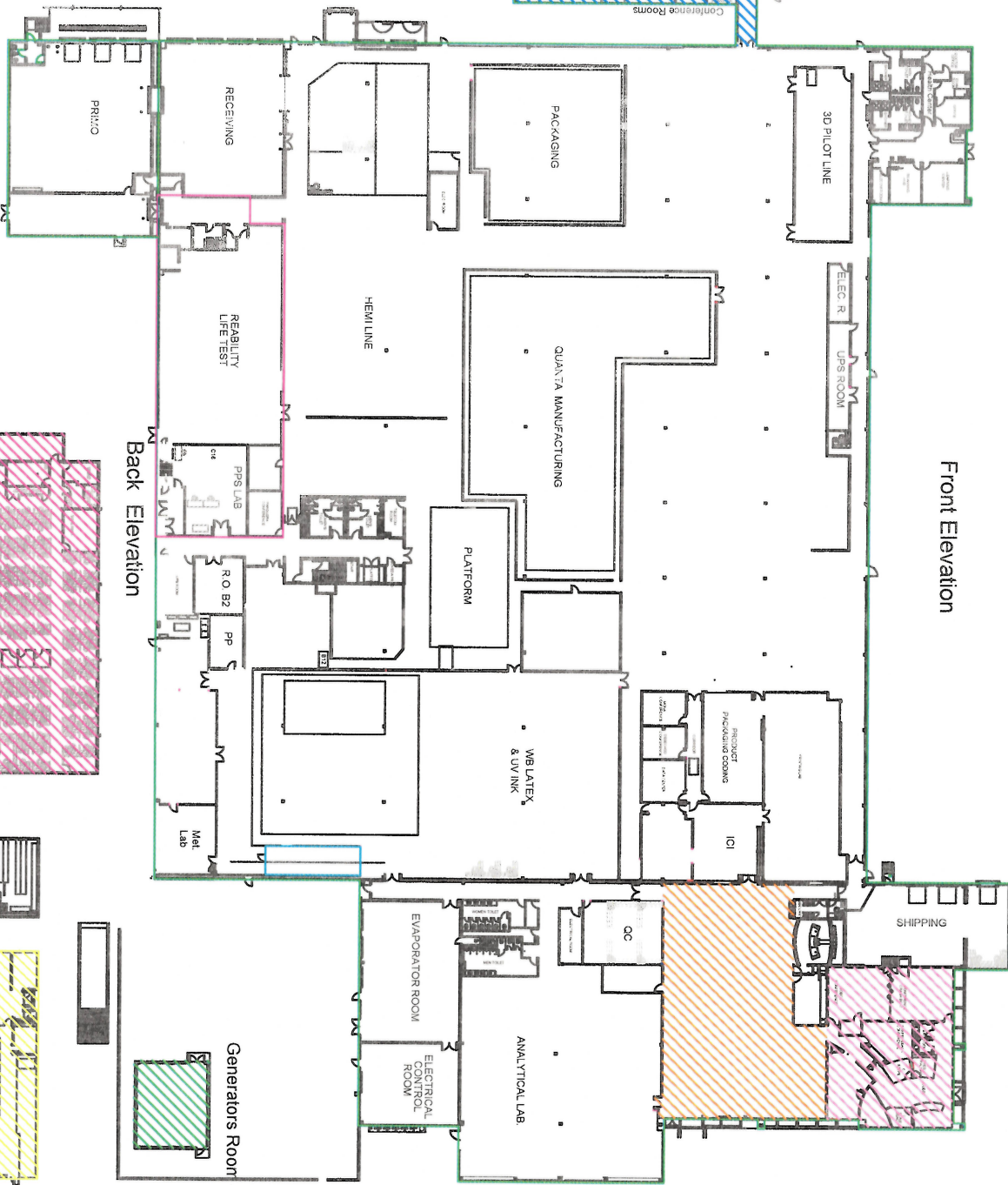

Back Elevation

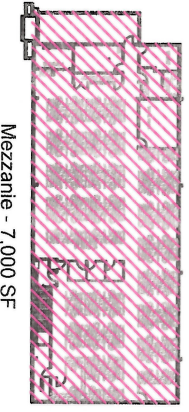

Left Elevation

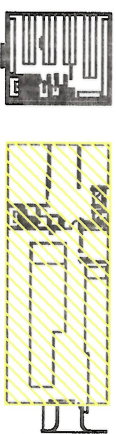

Generators Room - 1,050 SF.

Mezzanie - 7,000 SF

Mechanical Room (1st Floor)- 3,284 SF
have a mezzanie