



---

INDUSTRIAL M-2 LAND FOR SALE

---

# 295 I Oxbow Circle

295 I Oxbow Circle Cocoa, FL 32926

FOR SALE | \$155,000

presented by:

**BRIAN L. LIGHTLE, CCIM, SIOR**

Founder | Principal | Broker Associate

321.722.0707 X14

brian@teamlbr.com

# EXECUTIVE SUMMARY

• 2951 Oxbow Circle Cocoa, FL 32926



## OFFERING SUMMARY

**Sale Price:** \$155,000

**Lot Size:** 0.51 Acres

**Zoning:** M2

**APN#:** 24-35-12-25-\*-20

## PROPERTY OVERVIEW

M2 Zoning City of Cocoa - Industrial Land  
Common Retention  
Utilities to Site

## LOCATION OVERVIEW

Located in Grissom Ridge Industrial Complex off of Grissom Parkway in Cocoa  
Strategic Central location on the Space Coast  
Immediate Proximity of SR 528 ( Beachline Expressway)  
Immediate Proximity to New Amazon Distribution Center and SpaceX Facility

+/- 1 Mile to Industry Road and Entrance to SR528  
+/- 10 Miles to Port Canaveral  
+/- 15 Miles to Kennedy Space Center  
+/- 30 Miles to Melbourne -Orlando International Airport  
+/- 38 Miles to Orlando International Airport

### BRIAN L. LIGHTLE, CCIM, SIOR

Founder | Principal | Broker Associate  
321.722.0707 X14  
brian@teamlbr.com

### Lightle Beckner Robison, Inc.

321.722.0707 • teamlbr.com  
70 W. Hibiscus Blvd.,  
Melbourne, FL 32901

Information contained herein has been obtained through sources deemed reliable but cannot be guaranteed as to its accuracy. A purchaser or lessee is expected to verify all information to his/her own satisfaction. Zoning information subject to change and not warranted. Always confirm current requirements with local governing agencies.



# LOCATION MAP

• 2951 Oxbow Circle Cocoa, FL 32926

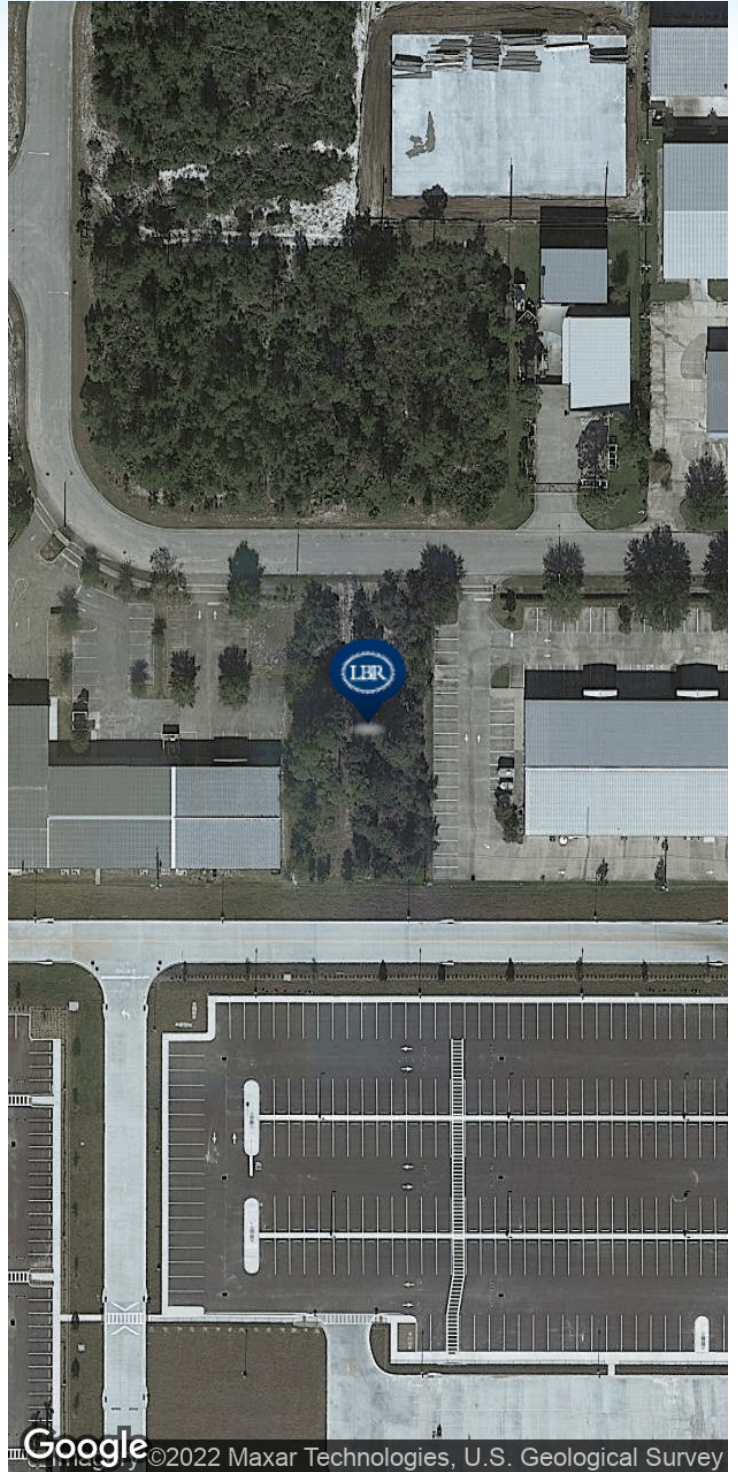

## BRIAN L. LIGHTLE, CCIM, SIOR

Founder | Principal | Broker Associate  
321.722.0707 X14  
brian@teamlbr.com

## Lightle Beckner Robison, Inc.

321.722.0707 • teamlbr.com  
70 W. Hibiscus Blvd.,  
Melbourne, FL 32901

Information contained herein has been obtained through sources deemed reliable but cannot be guaranteed as to its accuracy. A purchaser or lessee is expected to verify all information to his/her own satisfaction. Zoning information subject to change and not warranted. Always confirm current requirements with local governing agencies.