



BROKERAGE DONE DIFFERENTLY

live
work
& play
IN TAMPA BAY

RENOVATED WITH FRONT & BACK PATIOS FOR OUTDOOR SEATING AND GREAT STREET VISIBILITY

1411 N. 17TH ST.
TAMPA, FL 33605

FOR LEASE

\$ 3,500/mth

1,756 SF | Highest and Best Use: Community Bar :: Bistro, Restaurant, Breakfast Café :: Brewery/Distillery Hub :: Art Gallery :: Event Space - **Historic Ybor City**



This information is from sources deemed to be reliable. We are not responsible for inaccuracies, omissions, errors or omissions, prior sale, change of price and/or terms or withdrawal from the market without notice. Buyer shall conduct due diligence with their own representation as well as state and local agencies.

CALL TODAY! 813-935-9600 | TINA MARIE ELOIAN, CCIM | TINA@FLORIDACOMMERCIALGROUP.COM

PROPERTY DETAILS

1411 N. 17TH ST. | TAMPA, FL 33605

1,756 SF FOR LEASE | Highest and Best Use: Community Bar :: Bistro/Café :: Brewery/Distillery Hub :: Event Space

FINANCIAL & TERMS

Status: **Active**
Price: **\$3,500 / NNN**
Terms: **For Lease/Rent**

LOCATION

County: **Hillsborough**
Street Number: **1411**
Street Name: **N. 17th**
Street Suffix: **Street**
City: **Tampa**
Market: **Tampa**
Sub-market: **Ybor City**

UTILITIES

Electricity: **TECO**
Water: **City of Tampa Utilities**
Waste: **City of Tampa Utilities**
Communications: **Frontier/Verizon/Spectrum**

LEGAL DESCRIPTION

YBOR AND CO'S SUBDIVISION W 20 FT OF LOT 4 AND LOT 5 BLOCK 65

PROPERTY DETAILS

Folio #..... **190052-0000**
Type..... **56 | RESTAURANT**
Property Use..... **2103 RESTAURANT C**
Heated Area..... **1092 SF**
Back Patio..... **456 SF**
Front Patio..... **208 SF**
Gross Total..... **1,756 SF**
Year Built..... **1938**
Frontage..... **90'**
Depth..... **95'**

THE COMMUNITY

Neighborhood: **Central Ybor Area S of I-4**
Subdivision Name: **4WV | YBOR AND CO'S SUBDIVISION**
Flood Zone Area: **X - Moderate to Low Risk Areas**

Site Improvements.... **Renovations completed in 2021**
Stories..... **1**
Bathrooms..... **2**
Parking..... **10 Onsite - additional parking in adjoining lot across the street**
Property Style..... **Commercial**
Current Use..... **Vacant**
Future Use..... **Retail/Restaurant Opportunity**
Zone..... **YC-6**

BUILDING FOOTPRINT

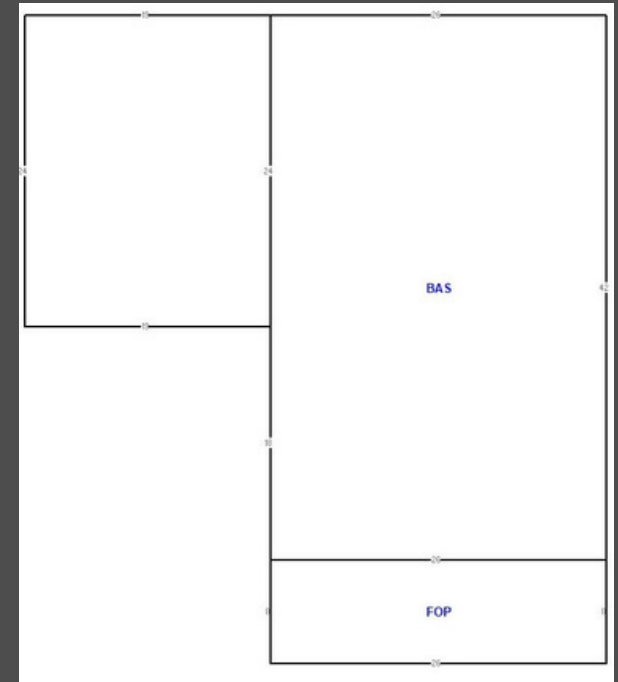

BROKERAGE DONE DIFFERENTLY

LISTING AGENT: TINA MARIE ELOIAN, CCIM | 813.935.9600 | TINA@FLORIDACOMMERCIALGROUP.COM



PROPERTY CAN BE LEASED WITH NEIGHBORING BUILDING - INQUIRE FOR DETAILS!



BROKERAGE DONE DIFFERENTLY

LISTING AGENT: TINA MARIE ELOIAN, CCIM | 813.935.9600 | TINA@FLORIDACOMMERCIALGROUP.COM

401 EAST PALM AVENUE, TAMPA, FL 33602 FLORIDACOMMERCIALGROUP.COM



1,756 SF FOR LEASE | Highest and Best Use: Community Bar :: Bistro/Café :: Brewery/Distillery Hub :: Event Space

Open a Breakfast Café or Bistro in this Growing Neighborhood!

- **1,092 sq ft heated**
- **664 sq ft covered patio**
- 2 Bathrooms - ADA compliant
- ADA compliant wheelchair ramp
- **Recent renovation**
- **Front & Rear patios**
- 10+ Onsite paved parking spaces and additional parking in adjoining lot across the street
- Centrally Located in the Heart of bustling Ybor City
- Average HH Income Exceeds \$49,031.08 within 3-Mile Radius
- Strong surrounding population of **53,851 residents within 3 miles** of the property
- Neighboring businesses include:
Columbia Restaurant, Valley Bank, Naviera Coffee Mills, Hilton Gardens Inn-Ybor, Hotel Haya and much much more



PROPERTY PHOTOS

1411 N. 17TH ST. | TAMPA, FL 33605

1,756 SF FOR LEASE | Highest and Best Use: Community Bar :: Bistro/Café :: Brewery/Distillery Hub :: Event Space



BROKERAGE DONE DIFFERENTLY

LISTING AGENT: TINA MARIE ELOIAN, CCIM | 813.935.9600 | TINA@FLORIDACOMMERCIALGROUP.COM

401 EAST PALM AVENUE, TAMPA, FL 33602 FLORIDACOMMERCIALGROUP.COM

PROPERTY PHOTOS

1411 N. 17TH ST. | TAMPA, FL 33605

1,756 SF FOR LEASE | Highest and Best Use: Community Bar :: Bistro/Café :: Brewery/Distillery Hub :: Event Space



BROKERAGE DONE DIFFERENTLY

LISTING AGENT: TINA MARIE ELOIAN, CCIM | 813.935.9600 | TINA@FLORIDACOMMERCIALGROUP.COM



401 EAST PALM AVENUE, TAMPA, FL 33602 FLORIDACOMMERCIALGROUP.COM

PROPERTY PHOTOS

1411 N. 17TH ST. | TAMPA, FL 33605

1,756 SF FOR LEASE | Highest and Best Use: Community Bar :: Bistro/Café :: Brewery/Distillery Hub :: Event Space



BROKERAGE DONE DIFFERENTLY



LISTING AGENT: TINA MARIE ELOIAN, CCIM | 813.935.9600 | TINA@FLORIDACOMMERCIALGROUP.COM

401 EAST PALM AVENUE, TAMPA, FL 33602 FLORIDACOMMERCIALGROUP.COM

