

1ST FLOOR BUILDING . LOT 20
 SCALE: 3/32" = 1'-0"
 AREA : 39,184.79 S.F.
 OFFICE AREA : 13,099 S.F.

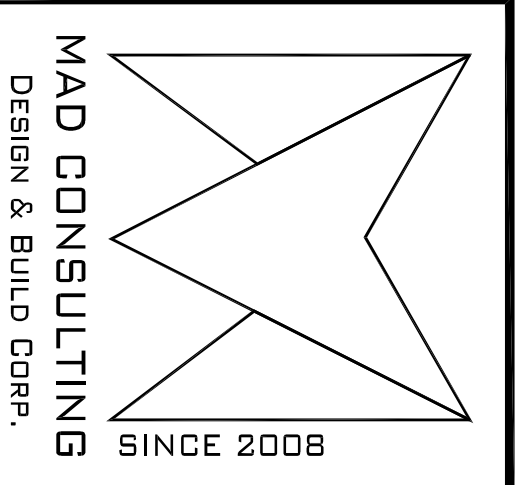

P.O. BOX 362411 S.J., P.R. 00936
 TEL: (787) 368-0973 FAX: (787) 368-8957
 SERVICES@MADCONSULTING.INFO

NO.	REVISIONS

NO.	DESCRIPTION

AS-BUILT 2ND FLOOR LOT 20
AMELIA INDUSTRIAL PARK LOT. #20
GUAYNABO, PUERTO RICO

DRAWING TITLE	
TITLE	

SCALE	0	DRAWING No.	AS-1.0
PROJECT No.		SHEET No.	1
DATE	FEB. 2020		