

## SHOPPES ON GRANADA | 3,400 SF PAD READY SITE



### PROPERTY DESCRIPTION

3,400 SF Pad Ready Site for sale in Phase II of the Shoppes on Granada.  
 Site is cleared, filled, and all utilities stubbed.  
 Adjacent and overflow parking available.  
 Monument Sign on high traffic Granada Boulevard.  
 Full access to Granada Boulevard at signalized intersection in front of Lowe's Home Improvement.  
 Shoppes on Granada Phase I Tenants: Panera Bread, Aspen Dental, Petco, Chipotle Mexican Grill, Mattress Firm, AT&T Store, and Bronx Pizza.  
 Shoppes on Granada Phase II Tenants: Salzburg Animal Hospital, TD Bank, Spectrum, ALDI, and Starbucks.  
 Start construction immediately!

### LOCATION DESCRIPTION

Located on the south side of Granada Boulevard east of Interstate 95 and west of Clyde Morris Boulevard.  
 Approximately 1 mile to Interstate 95.

### LOCATION ADDRESS

1250 W. Granada Boulevard, Unit 4  
 Ormond Beach, FL 32174

Principal | Senior Advisor  
 O: 386.301.4581  
 john.trost@svn.com  
 FL #BK-0160420

Principal  
 O: 386.453.4789  
 chris.butera@svn.com  
 FL #SL3083110

### OFFERING SUMMARY

SALE PRICE:	\$349,000
LOT SIZE:	3,400 SF
PARCEL NO:	4230-20-00-0040
TRAFFIC COUNT:	36,000 AADT
ZONING:	B-10, Suburban Boulevard

### DEMOGRAPHICS 1 MILE 3 MILES 5 MILES

	1 MILE	3 MILES	5 MILES
TOTAL HOUSEHOLDS	2,749	17,758	41,673
TOTAL POPULATION	5,698	40,814	94,278
AVERAGE HH INCOME	\$79,761	\$72,786	\$71,365

SHOPPES ON GRANADA 3,400 SF PAD READY SITE 1250 W. Granada Boulevard, Unit 4 Ormond Beach, FL 32174



We obtained the information above from sources we believe to be reliable. However, we have not verified its accuracy and make no guarantee, warranty or representation about it. It is submitted subject to the possibility of errors, omissions, change of price, rental or other conditions, prior sale, lease or financing, or withdrawal without notice. We include projections, opinions, assumptions or estimates for example only, and they may not represent current or future performance of the property. You and your tax and legal advisors should conduct your own investigation of the property and transaction. All SVN offices are independently owned and operated.

# SITE LAYOUT PLAN

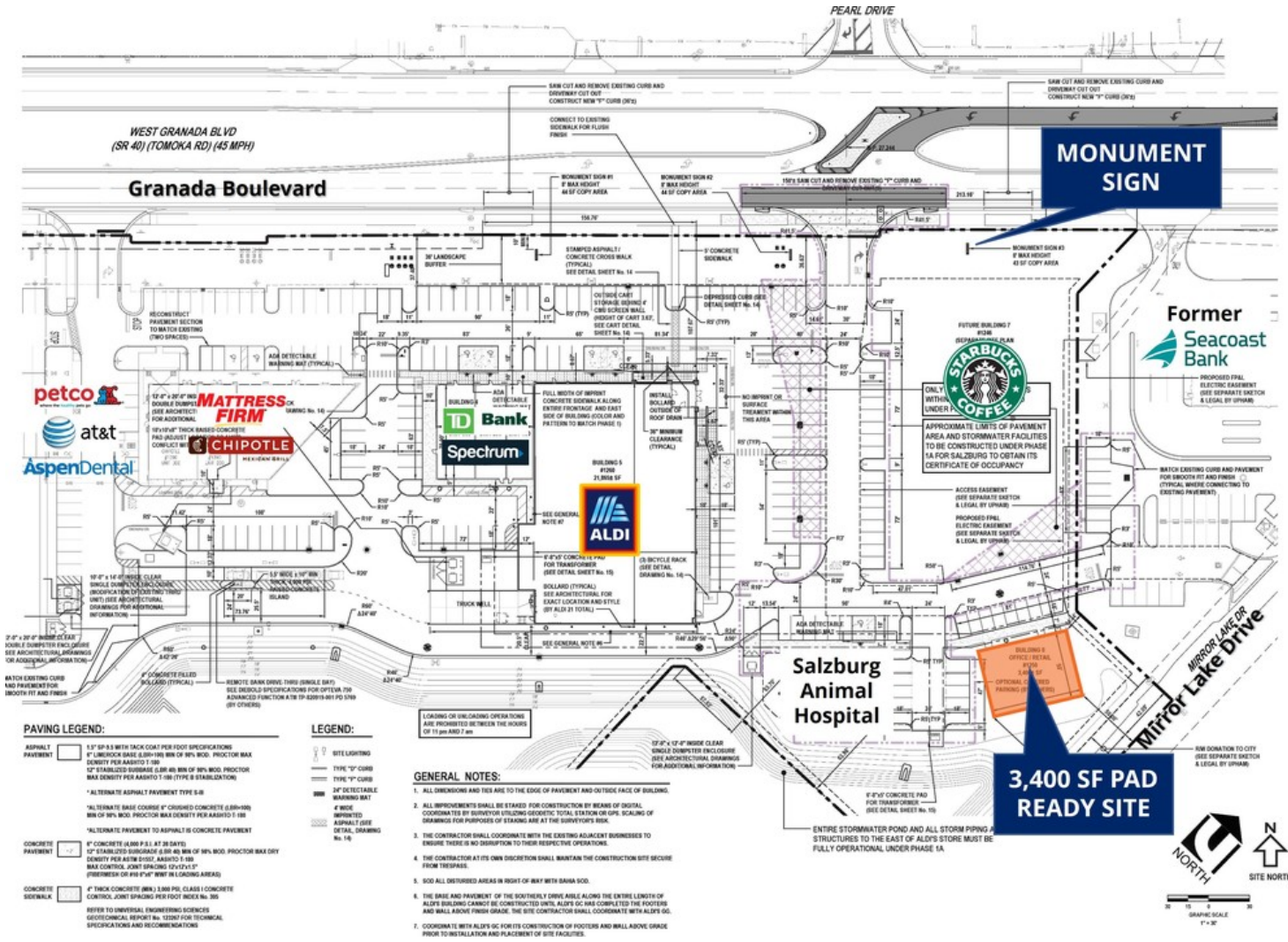

Principal | Senior Advisor  
 O: 386.301.4581  
 john.trost@svn.com  
 FL #BK-0160420

Principal  
 O: 386.453.4789  
 chris.butera@svn.com  
 FL #SL3083110

SHOPPES ON GRANADA 3,400 SF PAD READY SITE 1250 W. Granada Boulevard, Unit 4 Ormond Beach, FL 32174



We obtained the information above from sources we believe to be reliable. However, we have not verified its accuracy and make no guarantee, warranty or representation about it. It is submitted subject to the possibility of errors, omissions, change of price, rental or other conditions, prior sale, lease or financing, or withdrawal without notice. We include projections, opinions, assumptions or estimates for example only, and they may not represent current or future performance of the property. You and your tax and legal advisors should conduct your own investigation of the property and transaction. All SVN offices are independently owned and operated.



Principal | Senior Advisor  
O: 386.301.4581  
john.trost@svn.com  
FL #BK-0160420

Principal  
O: 386.453.4789  
chris.butera@svn.com  
FL #SL3083110

SHOPPES ON GRANADA 3,400 SF PAD READY SITE 1250 W. Granada Boulevard, Unit 4 Ormond Beach, FL 32174



We obtained the information above from sources we believe to be reliable. However, we have not verified its accuracy and make no guarantee, warranty or representation about it. It is submitted subject to the possibility of errors, omissions, change of price, rental or other conditions, prior sale, lease or financing, or withdrawal without notice. We include projections, opinions, assumptions or estimates for example only, and they may not represent current or future performance of the property. You and your tax and legal advisors should conduct your own investigation of the property and transaction. All SVN offices are independently owned and operated.

LOCATION MAP



Principal / Senior Advisor  
 O: 386.301.4581  
 john.trost@svn.com  
 FL #BK-0160420

Principal  
 O: 386.453.4789  
 chris.butera@svn.com  
 FL #SL3083110

SHOPPES ON GRANADA 3,400 SF PAD READY SITE 1250 W. Granada Boulevard, Unit 4 Ormond Beach, FL 32174



We obtained the information above from sources we believe to be reliable. However, we have not verified its accuracy and make no guarantee, warranty or representation about it. It is submitted subject to the possibility of errors, omissions, change of price, rental or other conditions, prior sale, lease or financing, or withdrawal without notice. We include projections, opinions, assumptions or estimates for example only, and they may not represent current or future performance of the property. You and your tax and legal advisors should conduct your own investigation of the property and transaction. All SVN offices are independently owned and operated.