

5333 NORTHWEST HWY (ROUTE 14) CRYSTAL LAKE, IL 60014

FOR SALE

MLS #10663331

September 7, 2021



RETAIL BUILDING 3,600 SF

HUGE PRICE REDUCTION

\$675,000 \$450,000

DESCRIPTION

3,600 SF RETAIL BUILDING - PRIME LOCATION HUGE PRICE REDUCTION

Freestanding, metal building (formerly automotive) along busy Route 14, in a prime retail location in the heart of Crystal Lake. 2,400 SF main floor shop with 600 SF showroom and additional 600 SF office/storage in mezzanine. (2) DID's (10'x10' and 18' x 8') and (1) bath. See layout and photos.

SPECIFICATIONS

Description	Freestanding Retail
Building Size	3,600 SF
Land Size	10,677 SF (.25 AC)
Year Built	1978
HVAC System	GFA A/C (Office & Showroom only)
Electrical	200 AMP 3-Phase
Sprinklers	No
Washrooms	1
Ceiling Height	10-14'
Drive In Doors	(1) 10x10', (1) 18x8'
Parking	Common
Sewer/Water	1000 Gallon Septic/Shared Well
Zoning	B2 PUD
RE Taxes	\$13,562.68 (2020)
PIN Number	19-09-200-013

DEMOGRAPHICS

	1 Mile	3 Miles	5 Miles
Population	2,309	51,607	127,968
Avg Household Income	\$78,316	\$89,490	\$98,626
Daily Traffic Counts: 27,800 (Route 14)			

No warranty or representation is made as to the accuracy of the foregoing information. Terms of sale or lease and availability are subject to change or withdrawal without notice. This document is for information purposes only. No offer of sub-agency is being made.

PREMIER
COMMERCIAL REALTY

- Industrial
- Commercial
- Office
- Land
- Business

CLICK HERE
to view our website

9225 S. IL Route 31
Lake in the Hills, IL 60156
www.PremierCommercialRealty.com
Office: 847-854-2300 | Fax : 847-854-2380

HEATHER SCHWEITZER

Vice President/Managing Broker

Office: 847-854-2300 Ext 15

Cell: 815-236-9816

HeatherS@PremierCommercialRealty.com

5333 NORTHWEST HWY (ROUTE 14)
CRYSTAL LAKE, IL 60014

FOR SALE



FLOOR PLAN

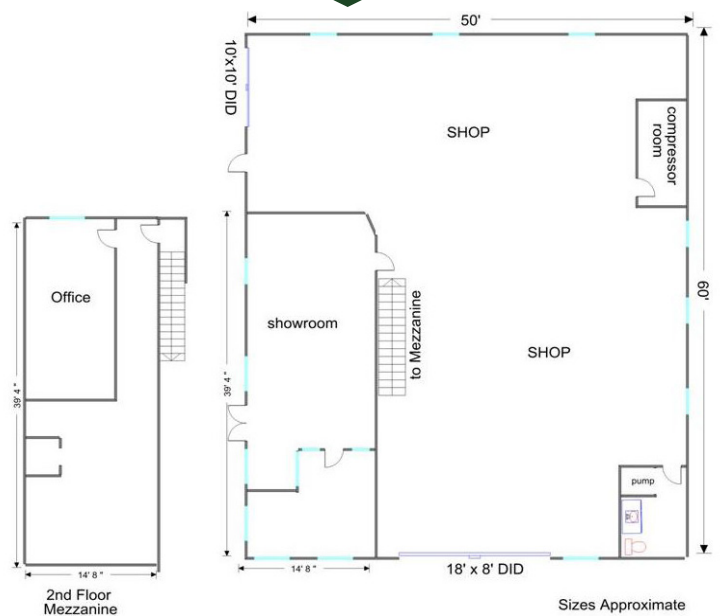

PREMIER
COMMERCIAL REALTY

- Industrial
- Commercial
- Office
- Land
- Business

[CLICK HERE](#)
to view our website

9225 S. IL Route 31
Lake in the Hills, IL 60156
www.PremierCommercialRealty.com
Office: 847-854-2300 | Fax: 847-854-2380