

NOTES:
 1. THE BEARINGS SHOWN HEREON ARE BASED ON THE TEXAS STATE PLANE COORDINATE SYSTEM, SOUTH CENTRAL ZONE, NAD 83.
 2. THIS SURVEY WAS PERFORMED WITHOUT BENEFIT OF A TITLE REPORT, CERTAIN EASEMENTS AND/OR BUILDING LINES MAY HAVE BEEN GRANTED WHICH ARE NOT REFLECTED HEREON. THIS SURVEY IS SUBJECT TO ANY FACTS THAT MAY BE DISCLOSED BY A FULL AND ACCURATE TITLE SEARCH.
 3. NOTHING IN THIS SURVEY IS INTENDED TO EXPRESS AN OPINION REGARDING OWNERSHIP RIGHTS.
 4. THE WORD CERTIFY IS UNDERSTOOD TO BE AN EXPRESSION OF PROFESSIONAL JUDGMENT BY THE SURVEYOR, WHICH IS BASED ON HIS BEST KNOWLEDGE, INFORMATION AND BELIEF.
 5. THE FINDINGS AND OPINIONS OF THIS SURVEY, WHICH REFLECTED HEREON ARE PROVIDED, CONFIDENTIAL AND INTENDED FOR THE USE OF THE INDIVIDUAL, OR ENTITY FOR WHOM THIS WORK WAS PREPARED. IT IS UNDERSTOOD THAT THE USE OF RELIANCE ON, OR REPRODUCTION OF SAME, IN WHOLE OR IN PART, BY OTHERS WITHOUT THE EXPRESS WRITTEN CONSENT OF WELLS LAND SURVEY, LLC IS PROHIBITED AND WITHOUT WARRANTY, EXPRESS OR IMPLIED, WELLS LAND SURVEY, LLC SHALL BE HELD HARMLESS AGAINST DAMAGES OR EXPENSES RESULTING FROM SUCH UNAUTHORIZED USE, RELIANCE OR REPRODUCTION. COPYRIGHT 2020. ALL RIGHTS RESERVED.

SURVEYOR'S CERTIFICATION
 TO: WESTLAKE PETROCHEMICALS,
 A DIVISION OF THE TEXAS INDUSTRIAL WATER AUTHORITY
 I, TIM WELLS WHITE, A REGISTERED PROFESSIONAL LAND SURVEYOR IN THE STATE OF TEXAS, HEREBY CERTIFY THAT THIS SURVEY WAS MADE ON THE GROUND UNDER MY DIRECT SUPERVISION ON JUNE 23, 2021. AT THE TIME OF THIS SURVEY THERE WERE NO APPARENT DISCREPANCIES, SHORTAGES IN AREA, BOUNDARY LINE CONFLICTS, ENCROACHMENTS, OVERLAPPING OF IMPROVEMENTS, ASSESSMENTS OR RIGHTS OF WAY, THAT I AM AWARE OF EXCEPT AS SHOWN HEREON, AND THAT SAID PROPERTY HAS ACCESS TO AND FROM A DESIGNATED ROADWAY. PRIORITY IS SUBJECT TO ALL CITY ORDINANCES AND SUBDIVISION COVENANTS, CONDITIONS AND RESTRICTIONS THAT MAY APPLY.
THIS SURVEY IS CERTIFIED FOR THIS TRANSACTION ONLY.
 Tim Wells White, Registered Professional Land Surveyor No. 5742

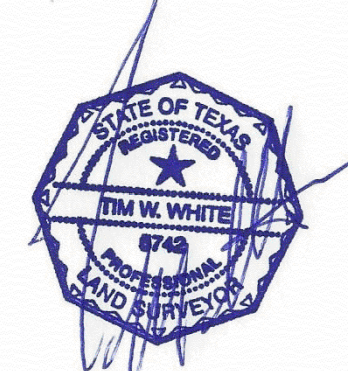

LEGAL DESCRIPTION 20.6386 ACRES
 C.C.P. WELCH SURVEY, ABSTRACT NO. 489
 CHAMBERS COUNTY, TEXAS
 BEING A TRACT OR PARCEL CONTAINING 20.6386 ACRES (899,017 SQUARE FEET) OF LAND IN THE C.C.P. WELCH SURVEY, ABSTRACT NO. 489, CHAMBERS COUNTY, TEXAS, AND THE C.C.P. WELCH SURVEY, ABSTRACT NO. 115, LIBERTY COUNTY, TEXAS, BEING OUT OF AND A PART OF THAT CERTAIN CALLED 181,406 ACRE TRACT CONVEYED FROM TANGLEWOOD PROPERTY MANAGEMENT COMPANY TO WESTLAKE PETROCHEMICALS CORPORATION RECORDED IN VOLUME 1677, PAGE 415 OF THE OFFICIAL PUBLIC RECORDS OF LIBERTY COUNTY, SAID 20.6386 ACRES BEING MORE PARTICULARLY DESCRIBED BY METES AND BOUNDS AS FOLLOWS, THE BEARINGS SHOWN HEREON ARE BASED ON THE TEXAS STATE PLANE COORDINATE SYSTEM, SOUTH CENTRAL ZONE, NAD 83:

LEGAL DESCRIPTION 150.9839 ACRES
 C.C.P. WELCH SURVEY, ABSTRACT NO. 489
 CHAMBERS COUNTY, TEXAS
 BEING A TRACT OR PARCEL CONTAINING 150.9839 ACRES (6,576,858 SQUARE FEET) OF LAND IN THE C.C.P. WELCH SURVEY, ABSTRACT NO. 489, CHAMBERS COUNTY, TEXAS, AND THE C.C.P. WELCH SURVEY, ABSTRACT NO. 115, LIBERTY COUNTY, TEXAS, BEING OUT OF AND A PART OF THAT CERTAIN CALLED 181,406 ACRE TRACT CONVEYED FROM TANGLEWOOD PROPERTY MANAGEMENT COMPANY TO WESTLAKE PETROCHEMICALS CORPORATION RECORDED IN VOLUME 1677, PAGE 415 OF THE OFFICIAL PUBLIC RECORDS OF LIBERTY COUNTY, SAID 150.9839 ACRES BEING MORE PARTICULARLY DESCRIBED BY METES AND BOUNDS AS FOLLOWS, THE BEARINGS SHOWN HEREON ARE BASED ON THE TEXAS STATE PLANE COORDINATE SYSTEM, SOUTH CENTRAL ZONE, NAD 83:

LEGAL DESCRIPTION 20.6386 ACRES
 C.C.P. WELCH SURVEY, ABSTRACT NO. 489
 CHAMBERS COUNTY, TEXAS
 BEING A TRACT OR PARCEL CONTAINING 20.6386 ACRES (899,017 SQUARE FEET) OF LAND IN THE C.C.P. WELCH SURVEY, ABSTRACT NO. 489, CHAMBERS COUNTY, TEXAS, AND THE C.C.P. WELCH SURVEY, ABSTRACT NO. 115, LIBERTY COUNTY, TEXAS, BEING OUT OF AND A PART OF THAT CERTAIN CALLED 181,406 ACRE TRACT CONVEYED FROM TANGLEWOOD PROPERTY MANAGEMENT COMPANY TO WESTLAKE PETROCHEMICALS CORPORATION RECORDED IN VOLUME 1677, PAGE 415 OF THE OFFICIAL PUBLIC RECORDS OF LIBERTY COUNTY.

LEGAL DESCRIPTION 150.9839 ACRES
 C.C.P. WELCH SURVEY, ABSTRACT NO. 489
 CHAMBERS COUNTY, TEXAS
 BEING A TRACT OR PARCEL CONTAINING 150.9839 ACRES (6,576,858 SQUARE FEET) OF LAND IN THE C.C.P. WELCH SURVEY, ABSTRACT NO. 489, CHAMBERS COUNTY, TEXAS, AND THE C.C.P. WELCH SURVEY, ABSTRACT NO. 115, LIBERTY COUNTY, TEXAS, BEING OUT OF AND A PART OF THAT CERTAIN CALLED 181,406 ACRE TRACT CONVEYED FROM TANGLEWOOD PROPERTY MANAGEMENT COMPANY TO WESTLAKE PETROCHEMICALS CORPORATION RECORDED IN VOLUME 1677, PAGE 415 OF THE OFFICIAL PUBLIC RECORDS OF LIBERTY COUNTY.

LEGEND:
 -x- BARBED WIRE FENCE
 -E- OVERHEAD ELECTRIC LINES
 --- GUY WIRE
 -o- UTILITY MARKER
 -P- PIPELINE MARKER
 -A- UTILITY POLE
 -R- IRON ROD FOUND
 -C- CAPPED IRON ROD FOUND
 -B- BENT IRON ROD FOUND
 -I- IRON PIPE FOUND
 -F.I.R.M. - FLOOD INSURANCE RATE MAP
 -O.P.R.C. - OFFICIAL PUBLIC RECORDS OF LIBERTY COUNTY
 -POB - POINT OF BEGINNING
 -POC - POINT OF COMMENCING
 -D.R.L.C. - DEED RECORDS LIBERTY COUNTY
 -P.L.M. - PIPELINE MARKER

PROPERTY LIES WITHIN FLOOD ZONE "X", ACCORDING TO F.I.R.M. NO. 4829100750, DATED JAN. 19, 2016. BY GRAPHIC PLOTTING ONLY, WELLS LAND SURVEY DOES NOT ASSUME RESPONSIBILITY FOR EXACT DETERMINATION BEFORE ANY DEVELOPMENT PLANNING, DESIGN, OR CONSTRUCTION IS STARTED. THE COMMUNITY, CITY, AND COUNTY IN WHICH SUBJECT TRACT EXISTS SHOULD BE CONTACTED, SAID ENTITIES MAY IMPOSE GREATER FLOOD PLAN AND FLOODWAY RESTRICTIONS THAN SHOWN BY THE F.I.R.M. THAT MAY EXIST.

SURVEY OF

BEING A TRACT OR PARCEL CONTAINING 150.9839 ACRES (6,576,858 SQUARE FEET) OF LAND IN THE C.C.P. WELCH SURVEY, ABSTRACT NO. 489, CHAMBERS COUNTY, TEXAS, AND THE C.C.P. WELCH SURVEY, ABSTRACT NO. 115, LIBERTY COUNTY, TEXAS, BEING OUT OF AND A PART OF THAT CERTAIN CALLED 181,406 ACRE TRACT CONVEYED FROM TANGLEWOOD PROPERTY MANAGEMENT COMPANY TO WESTLAKE PETROCHEMICALS CORPORATION RECORDED IN VOLUME 1677, PAGE 415 OF THE OFFICIAL PUBLIC RECORDS OF LIBERTY COUNTY.

ADDRESS: HWY 148
 DAYTON, TX 77535
 SURVEYED FOR:
 WESTLAKE PETROCHEMICALS
 TBPLS LICENSE # 10193901
 712 F.M. 562
 ANAHUAC, TX 77514
 (409) 267-3002
 www.wellsandsurvey.com
 Copyright 2021

JOB NO: 390-21 DATE: 06-23-21
 DRAWN BY: AL SCALE: 1"= 200'