

FOR SALE: Cross Bayou Industrial Park – OUTPARCEL

66TH STREET LAND

10566 66th St. N., Pinellas Park, FL 33782



EXCELLENT DEVELOPMENT OPPORTUNITY



Cross Bayou Industrial Park

Up to 15,000 SF Building

66TH STREET



FEATURES

- ❖ 2.66 Acres (MOL) with approx. 1.33 Usable Acres
- ❖ 192.63' frontage on 66th St. N: Depth 602.28'
- ❖ Zoning: M-1 (Light Industrial)
- ❖ Use: Flex Space, Manufacturing, Office Showroom, etc.
- ❖ Parking Ratio: 3.49/1,000
- ❖ Preliminary Site Plan for 13,164 SF Building Available
- ❖ Up to 15,000 SF Building possible
- ❖ Water/Sewer: City of Pinellas Park
- ❖ **Asking Price: \$680,000**

LOCATION MAP



Demographics	1-Mile	3-Miles	5-Miles
Population	8,654	94,841	261,877
Median Age	46.6	45.0	48.3
Households	3,600	37,737	115,120

Elliott M. Ross, CCIM
 O: 813.755.6700
 C: 727.639.3800
 elliott@rossrealtytampabay.com

ROSS REALTY GROUP, INC.
 Watermark Building 5
 5415 Mariner St., Suite 280
 Tampa, FL 33609



PARCEL AVAILABLE

10566 66th St. N., Pinellas Park, FL 33782

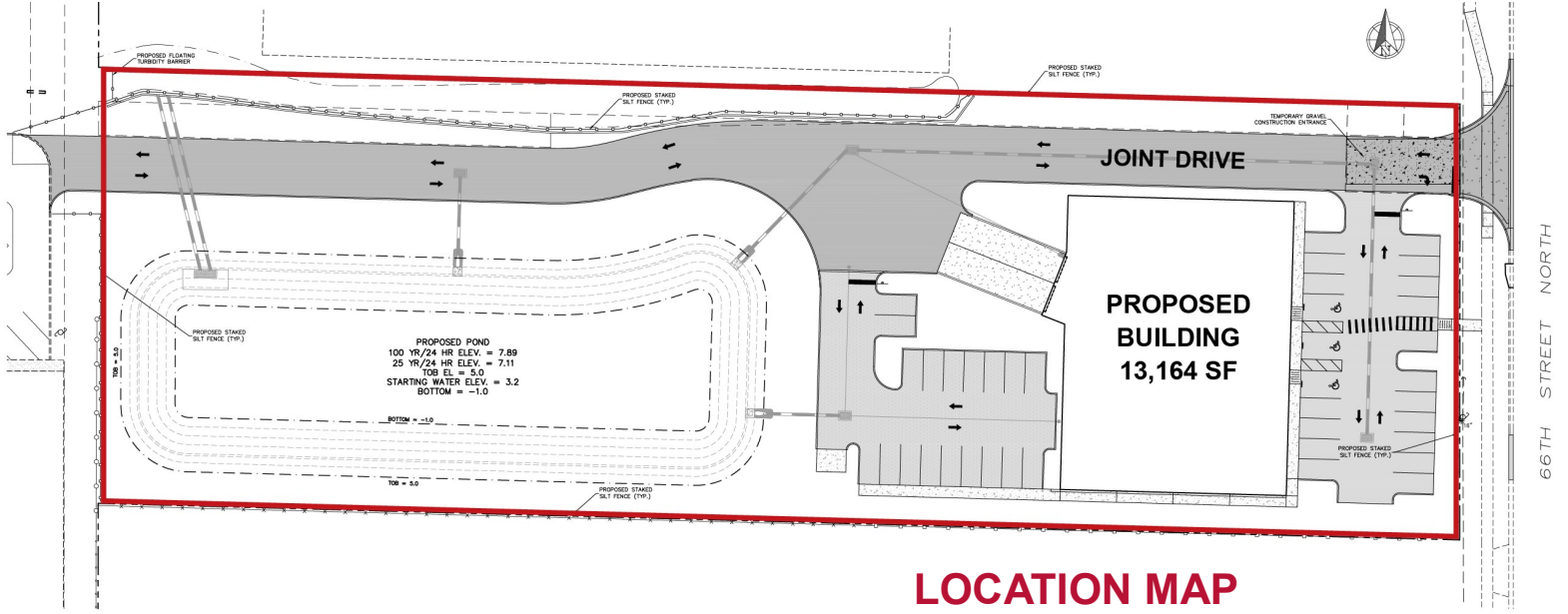

LOCATION MAP

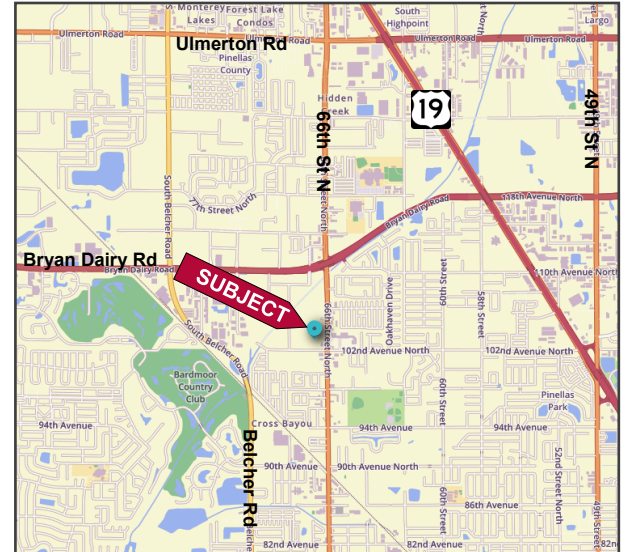

Any information given herein is obtained from sources considered reliable. However, we are not responsible for misstatement of facts, errors, omissions, prior sale, withdrawal from market, modification of mortgage commitment, terms and considerations, or change in price without notice. The information supplied herein is for informational purposes only and shall not contain a warranty or assurance that said information is correct. Any person intending to rely upon the information supplied herein should verify said information independently.