

COMING: South Orange Retail Strip Center 3 Grocery Intersection

Orange and Michigan
2820 S. Orange Avenue
Orlando, FL 32806

Located across from Publix and Neighborhood Market

STRIP CENTER SIZE: 6,856 SF (See attached plan)

PARKING: 101 Spaces!!!

ZONING: AC-2

TRAFFIC COUNT: 41,902

POPULATION:

1 Mile:	9,690
3 Mile:	123,865
5 Mile:	313,578

INCOME:

1 Mile:	\$99,422
3 Mile:	\$75,350
5 Mile:	\$76,614

HIGHLIGHTS:

- Orange Avenue Frontage Going Home Side of Intersection.
- Great Retail Intersection



Acquisitions Consultants, Inc.
1760 Fennell St, Suite 200
Maitland, FL 32751
Phone: 407.373-0930
Fax: 407.373.0929
www.accommercial.com

Jonathan Moore – Licensed Broker
321-800-2014
jamoore@accommercial.com

We obtained this information from sources deemed to be reliable. However, we have not verified accuracy and make no guarantee, warranty or representation as to the accuracy of this information. This information is given subject to errors, omissions, changes of price, withdrawal without notice and other conditions. Projections, assumptions and opinions are given for example only.

Site Plan

Orange and Michigan
2820 S. Orange Avenue
Orlando, FL

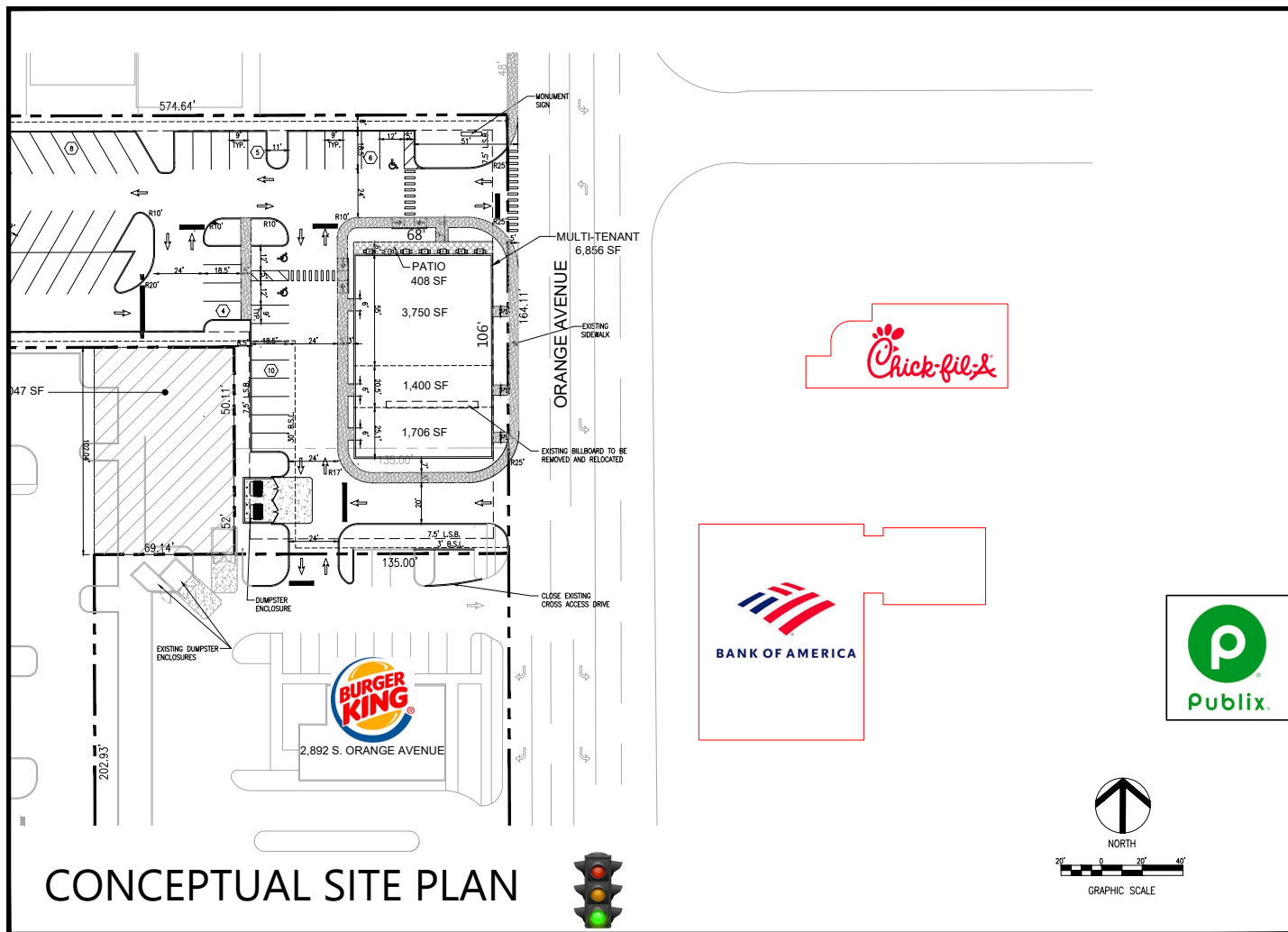

SZ DEVELOPMENT		CA 29554 PH: (407) 271-8930 708 E COCONA DR., STE 100 ORLANDO, FL 32803 FAX: (407) 442-0604	
DATE	REVISION	DATE	REVISION
STORAGE / RESTAURANT		SOUTH ORANGE AVENUE	
		TRAILER PARK, INC.	
		ORLANDO, FL	
DATE: 09-16-19		DRAWN: BA	
		CHECKED: RZ	
CP8		PROJECT NO.: 2019-122	



Acquisitions Consultants, Inc.
1760 Fennell St, Suite 200
Maitland, FL 32751
Phone: 407.373-0930
Fax: 407.373.0929
www.accommercial.com

Jonathan Moore – Licensed Broker
321-800-2014
jamoore@accommercial.com

We obtained this information from sources deemed to be reliable. However, we have not verified accuracy and make no guarantee, warranty or representation as to the accuracy of this information. This information is given subject to errors, omissions, changes of price, withdrawal without notice and other conditions. Projections, assumptions and opinions are given for example only.

Site Plan: Strip Center Close Up

Orange and Michigan
2820 S. Orange Avenue
Orlando, FL

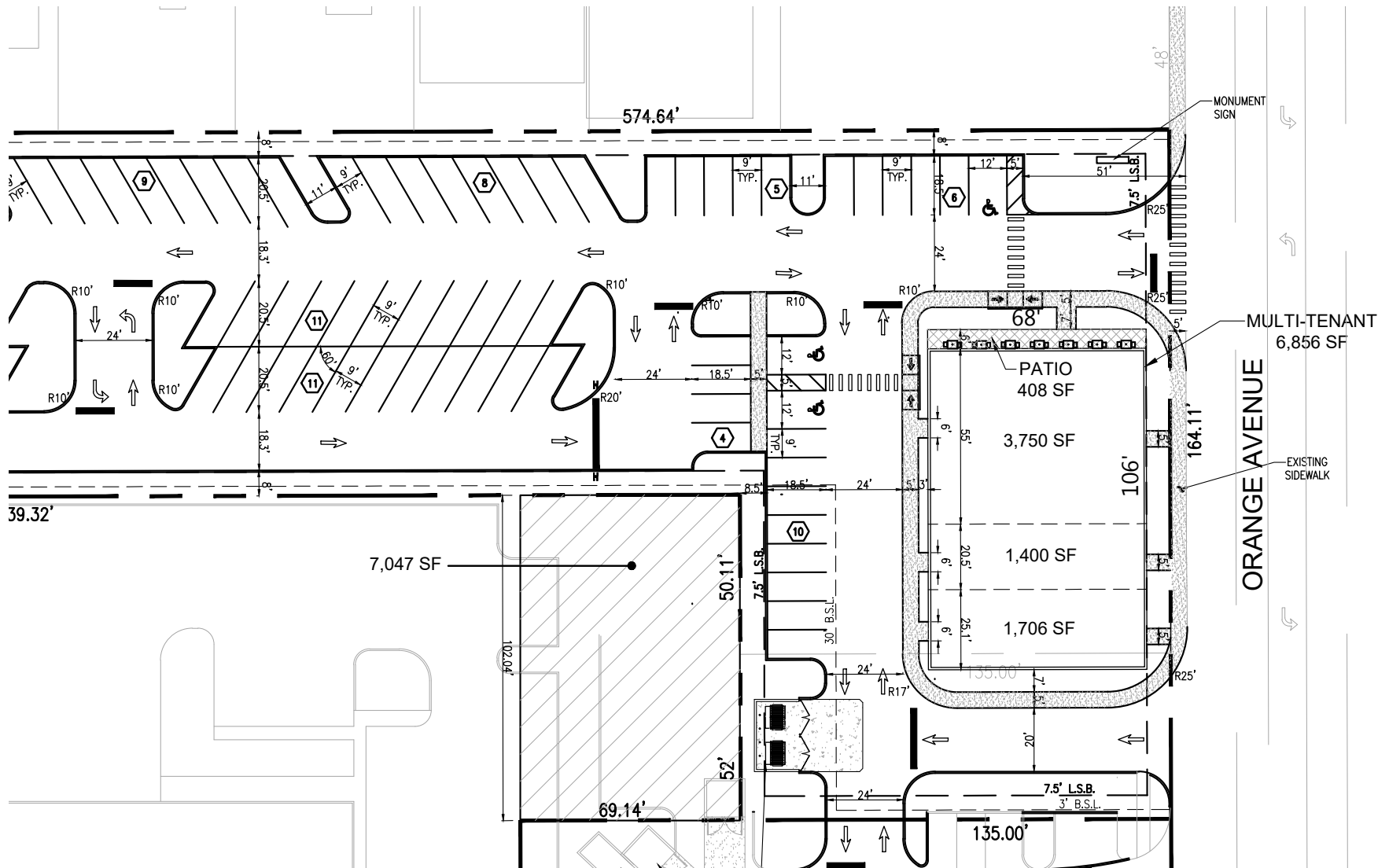

Acquisitions Consultants, Inc.
1760 Fennell St, Suite 200
Maitland, FL 32751
Phone: 407.373-0930
Fax: 407.373.0929
www.accommercial.com

Jonathan Moore – Licensed Broker
321-800-2014
jamoore@accommercial.com

We obtained this information from sources deemed to be reliable. However, we have not verified accuracy and make no guarantee, warranty or representation as to the accuracy of this information. This information is given subject to errors, omissions, changes of price, withdrawal without notice and other conditions. Projections, assumptions and opinions are given for example only.