



JAMISON
COMMERCIAL PARTNERS

PREMIER OPPORTUNITY BALDWIN PARK

1801 PROSPECT AVENUE
ORLANDO, FL 32803

FOR SALE

Jamison Commercial Partners is pleased to present a 2.48 acre redevelopment site which includes a 10,000 RSF financial institution with 4 drive thrus.

PROPERTY OVERVIEW

- » 2.48 ± Acres zoned PD (Orlando)
- » Located within prestigious Baldwin Park
- » 10,000 ± RSF bank branch with 4 drive thrus
- » Largest remaining site in Baldwin Park
- » Price - "Call for Offers"
- » **Offers due 6/18/2021**



DARRYL
DOTHEROW,CCIM

SENIOR VICE PRESIDENT | 407.716.0654
DDOTHEROW@JAMISONCOMMERCIAL.COM

JAMISONCOMMERCIAL.COM

2020 DEMOGRAPHICS



GENERAL POPULATION



NUMBER OF HOUSEHOLDS



AVG. HOUSEHOLD INCOME

| | 1 MILE | 3 MILE | 5 MILE |
|-----------------------|-----------|----------|----------|
| General Population | 14,095 | 101,254 | 306,152 |
| Number of Households | 6,184 | 44,698 | 133,649 |
| Avg. Household Income | \$122,189 | \$91,685 | \$84,548 |



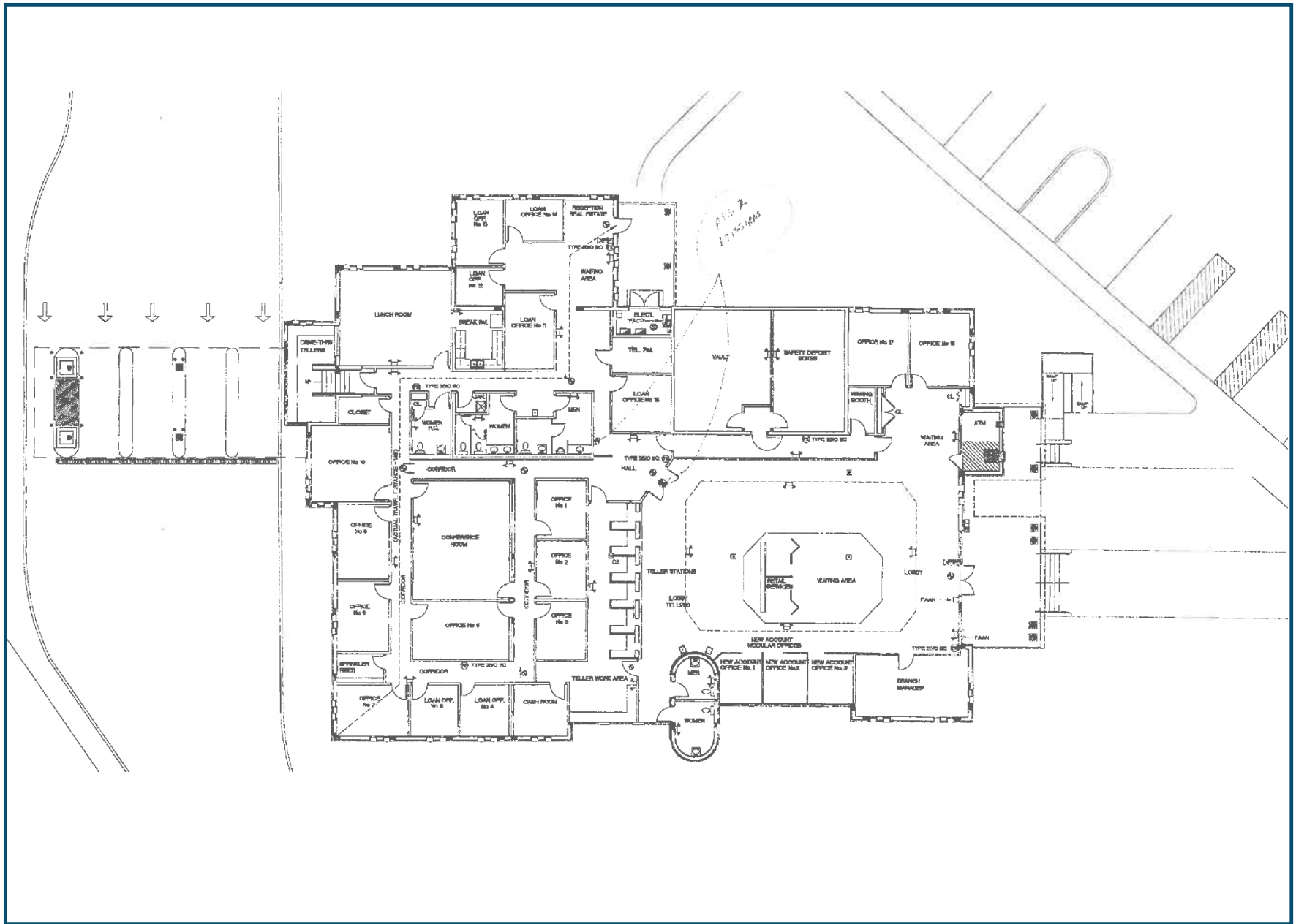

FLOOR PLAN