



**ACQUISITION
CONSULTANTS**
ADVANCE • CREATE • PROTECT



Publix



SEC of University Blvd and Mission Bay Blvd, Orlando, FL 32817



**2 COMMERCIAL ACRES
BY UCF**

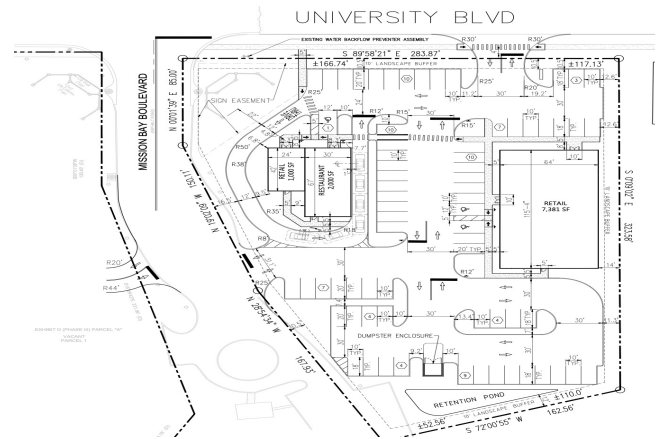

\$1,900,000

ABOUT THIS PROPERTY

Commercial Zoning | Vacant land on University Blvd. | 2 miles west of UCF | Can be subdivided

PROPERTY DETAILS

+/- 2 acres of vacant commercial land across from Publix. Land was recently approved for commercial zoning. Provides superior access with a median in front of the site. 284' of University Blvd. frontage. Site benefits from offsite retention.



BENEFITS FROM OFFSITE RETENTION VIA MULTI-FAMILY DEVELOPMENT TO THE WEST



ZONING

Retail Commercial District Uses (C-1)



TRAFFIC COUNT

57,586 (E University Blvd)
56,305 (W University Blvd)



POPULATION

1 Mile 11,324
3 Mile 90,443
5 Mile 258,952



INCOME

1 Mile \$80,841
3 Mile \$77,083
5 Mile \$78,988

Data obtained from sources deemed reliable. Acquisition Consultants has not verified accuracy and makes no guarantee, warranty or representation as to the accuracy of this information. This information is provided subject to errors, omissions, changes of price, withdrawal without notice, among other conditions. Projections, assumptions and opinions are given for example only.



ACQUISITION
CONSULTANTS
ADVANCE • CREATE • PROTECT

CONTACT INFORMATION



Jonathan A. Moore

jamoore@acommercial.com

(321) 800-2014