

SURVEY & SITE PLAN
ROYAL PALM PROFESSIONAL BUILDINGS ASSOCIATION INC.

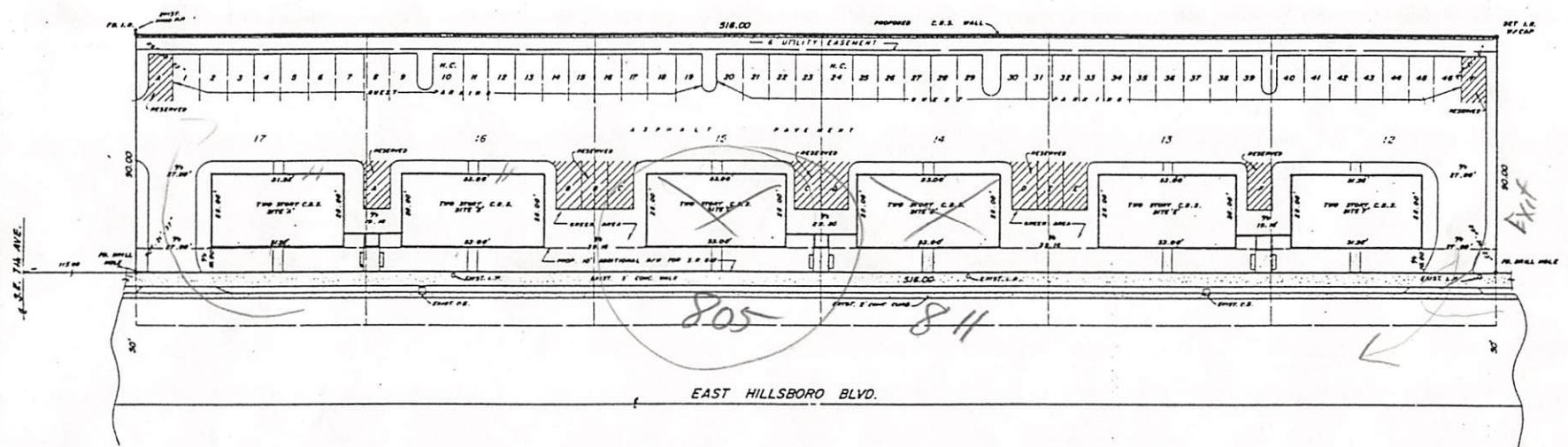
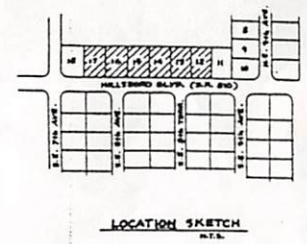

DESCRIPTION:
 LOTS 12 THRU 17, RESUBDIVISION OF BLOCK 6, DEERFIELD BEACH ESTATES, ACCORDING TO THE PLAT THEREOF, AS RECORDED IN PLAT BOOK 40, PAGE 3, OF THE PUBLIC RECORDS OF BROWARD COUNTY, FLORIDA, LESS THE SOUTH 20.00 FEET THEREOF, FOR ROAD RIGHT-OF-WAY.
 SAID LANDS SITUATE IN DEERFIELD BEACH, BROWARD COUNTY, FLORIDA.

LEGEND
 _____ INDICATES SITE BOUNDARIES
 [Hatched Box] INDICATES LIMITED COMMON ELEMENTS

Blk = 53 x 28 = 2,968
Lot = 86 x 90

CERTIFICATION
 I, JAMES F. HASK, A PROFESSIONAL LAND SURVEYOR ONLY AUTHORIZED TO PRACTICE UNDER THE LAWS OF THE STATE OF FLORIDA, HEREBY CERTIFY THAT THE CONSTRUCTION OF THE IMPROVEMENTS SHOWN HEREON IS SUBSTANTIALLY COMPLETE SO THAT THE MATERIAL, TOGETHER WITH THE PROVISIONS OF THE DECLARATION RELATING TO MATTERS OF SURVEY DESCRIBING SAID BUILDING ASSOCIATION INC. PROPERTY, IS AN ACCURATE REPRESENTATION OF THE LOCATION AND DIMENSIONS OF THE IMPROVEMENTS AND THAT THE IDENTIFICATION, LOCATION AND DIMENSIONS OF THE COMMON ELEMENTS, LIMITED COMMON ELEMENTS AND OF EACH UNIT CAN BE DETERMINED FROM THESE MATERIALS; AND THAT ALL PLANNED IMPROVEMENTS, INCLUDING BUT NOT LIMITED TO LANDSCAPING, UTILITY SERVICES AND ACCESS TO ALL UNITS, AND COMMON ELEMENT FACILITIES, SERVING SAID BUILDING ASSOCIATION BUILDING HAVE BEEN SUBSTANTIALLY COMPLETED, AND THAT THIS SURVEY MEETS THE MINIMUM TECHNICAL STANDARDS SET FORTH BY THE FLORIDA BOARD OF LAND SURVEYORS AND THAT THIS DRAWING IS A TRUE AND CORRECT DELINEATION THEREOF.

[Signature]
 JAMES F. HASK
 STATE OF FLORIDA NO. 2254

REVISED 4/13/80
 REVISED 4/14/80
 PRELIMINARY SET 57

THIS SURVEY IS NOT VALID UNLESS THE EMBOSSED SEAL OF THE LAND SURVEYOR IS AFFIXED HERETO.