

11416 KILEY DRIVE, UNITS D&E HUNTLEY, IL 60142

FOR SALE

PRICE REDUCED

MLS # 10680230 (Unit D); 10680336 (Unit E)

December 17, 2020



INDUSTRIAL CONDOS
3,000–6,000 SF

~~\$255,000~~ **\$240,000 each (\$80.00 psf)**
(\$480,000 for both)

DESCRIPTION

(2) 3,000 SF adjacent industrial condos, each with small office, (2) bathrooms, 10x10' drive-in doors, mezzanine above office and 2,600± SF warehouse. Condos can be sold together or separate. Ideally located minutes from I-90 / Route 47 interchange. See layouts and photos. Visit Premier Commercial Realty website to see more listings.

SPECIFICATIONS

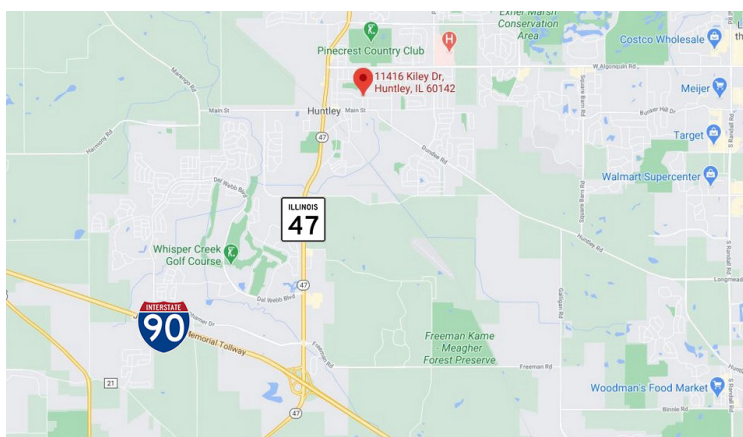

Description	Industrial Condos
Building Size	13,500 SF
Office Size	Unit D: 450± SF / Unit E: 350± SF
Year Built	1980
HVAC System	Office: Wall Units (A/C & Heat) Warehouse: Ceiling Hung
Electrical	200 AMP
Sprinkled	Yes
Washrooms	2 per Unit
Ceiling Height	14-16' Clear
Parking	24 Common
DID's	(1) 10x10' per Unit
Floor Drains	None
Sewer/Water	City
Zoning	M
RE Taxes (2019)	Unit D: \$4,797.68 / Unit E: \$4,757.70
Association Dues	\$250/mo per Unit
PIN Number	18-28-463-004 & 005

No warranty or representation is made as to the accuracy of the foregoing information. Terms of sale or lease and availability are subject to change or withdrawal without notice. This document is for information purposes only. No offer of sub-agency is being made.

PREMIER
COMMERCIAL REALTY

- Industrial
- Commercial
- Office
- Land
- Business

CLICK HERE
to view our website

HEATHER SCHWEITZER

Vice President/Managing Broker

Office: 847-854-2300 Ext 15

Cell: 815-236-9816

HeatherS@PremierCommercialRealty.com

9225 S. IL Route 31
Lake in the Hills, IL 60156
www.PremierCommercialRealty.com
Office: 857-854-2300 | Fax: 847-854-2380

11416 KILEY DRIVE, UNITS D&E HUNTLEY, IL 60142

FOR SALE



FLOOR & SITE PLANS

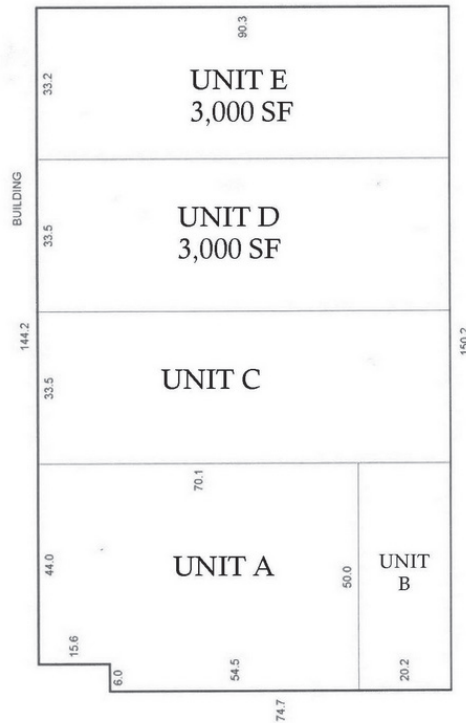
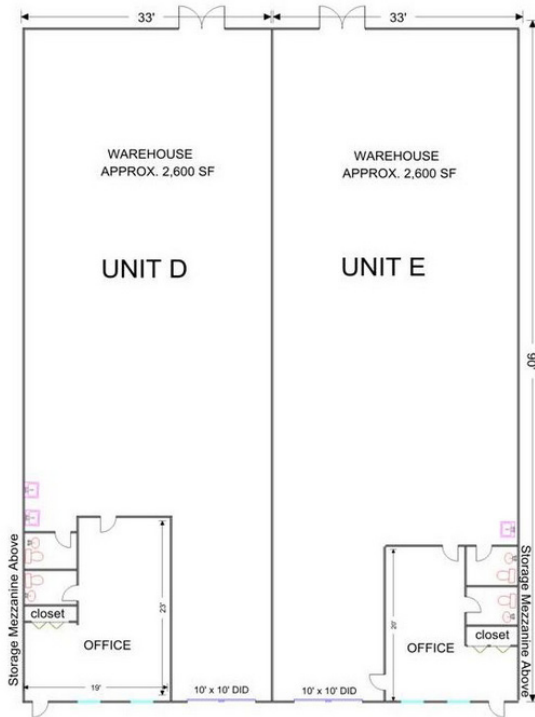

- Industrial
- Commercial
- Office
- Land
- Business

[CLICK HERE](#)
to view our website

9225 S. IL Route 31
Lake in the Hills, IL 60156
www.PremierCommercialRealty.com
Office: 847-854-2300 | Fax: 847-854-2380