



Cornerstone™
COMMERCIAL ASSOCIATES, LLC

Todd Rosborough
561 Spring Lake Drive
Melbourne, FL 32940



Cell 321.508.6457

Email todd@toddknowsindustrial.com



INDUSTRIAL CONDO FOR SALE

**3170 Skyway Circle, Unit 103
Melbourne, FL 32934**

- 3,000 square foot industrial condo
 - 11'12" X 19' 9" office
 - 2,750+/- warehouse
- M-1 Light Industrial Zoning City of Melbourne.
- Concrete block construction
- Peak height 16'
- 1 Grade level 10' X 12' OHD
- 3-Phase Power
- 2020 taxes: \$4,037.33

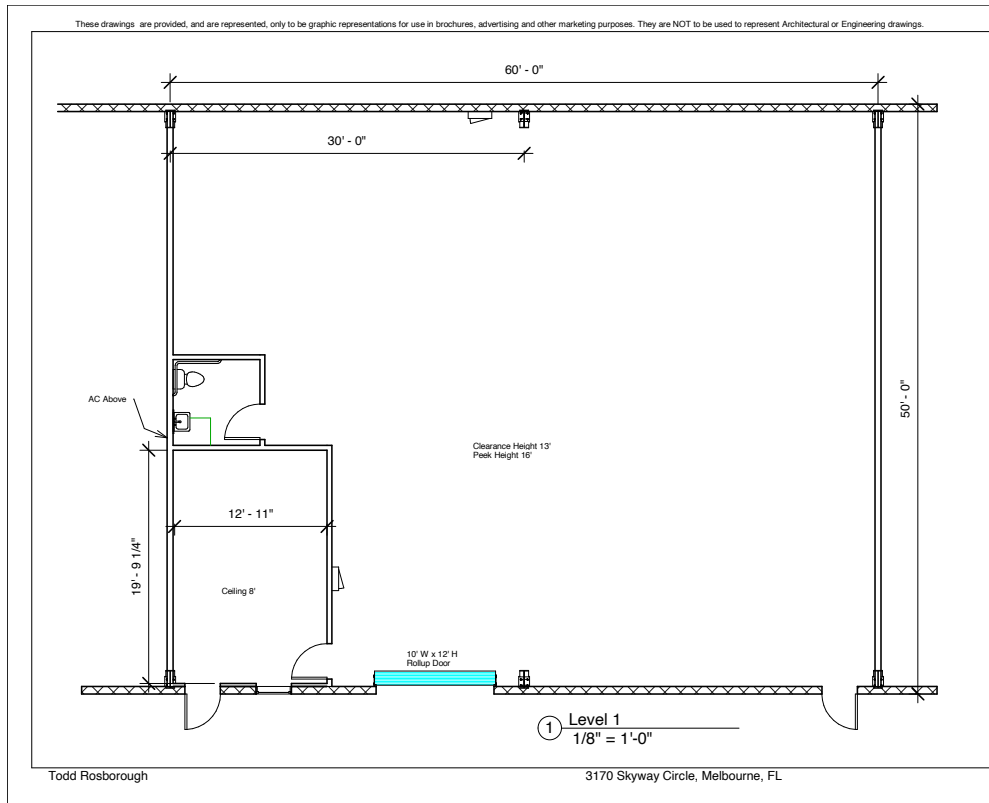

FOR SALE - \$310,000



Large Warehouse



HVAC in Office



Separate Office



Compliant Facilities