



# St. Johns County, FL

### Tax Bill

### Estimate Taxes

### 2020 TRIM Notice

### 2019 TRIM Notice

### Summary

Parcel ID 1358110041  
 Location Address 10 MOULTRIE CREEK CIR  
 SAINT AUGUSTINE 32086-0000  
 Neighborhood Moultrie Woods Townhouses (2256.01)  
 Tax Description\* OR720/681 MOULTRIE WOODS BLDG 4 LOT A (AKA UNIT 4-A) OR3965/805(C/T) OR4222/1045  
 \*The Description above is not to be used on legal documents.  
 Property Use Code Single Family Townhouse (0130)  
 Subdivision N/A  
 Sec/Twp/Rng 2-8-29  
 District County (District 300)  
 Millage Rate 13.3141  
 Acreage 0.020  
 Homestead N

### Owner Information

Owner Name [Bacon James E Etal](#) 100%  
[Scheufler-Bacon Loell J](#) 100%  
 Mailing Address 55 FERROL RD  
 SAINT AUGUSTINE, FL 32084-0000

### Map



**Valuation Information**

	2021
Building Value	\$54,414
Extra Features Value	\$0
Total Land Value	\$24,000
Agricultural (Assessed) Value	\$0
Agricultural (Market) Value	\$0
Just (Market) Value	<b>\$78,414</b>
Total Deferred	\$9,998
Assessed Value	<b>\$68,416</b>
Total Exemptions	\$0
Taxable Value	<b>\$68,416</b>

Values listed are from our working tax roll and are subject to change.

**Historical Assessment Information**

Year	Building Value	Extra Feature Value	Total Land Value	Ag (Market) Value	Ag (Assessed) Value	Just (Market) Value	Assessed Value	Exempt Value	Taxable Value
2020	\$56,038	\$0	\$24,000	\$0	\$0	\$80,038	\$62,196	\$17,842	\$62,196
2019	\$54,811	\$0	\$24,000	\$0	\$0	\$78,811	\$56,542	\$22,269	\$56,542
2018	\$48,634	\$0	\$24,000	\$0	\$0	\$72,634	\$51,402	\$21,232	\$51,402
2017	\$42,373	\$0	\$17,000	\$0	\$0	\$59,373	\$46,729	\$12,644	\$46,729
2016	\$34,481	\$0	\$8,000	\$0	\$0	\$42,481	\$42,481	\$0	\$42,481
2015	\$35,510	\$0	\$8,000	\$0	\$0	\$43,510	\$43,510	\$0	\$43,510
2014	\$35,538	\$0	\$9,000	\$0	\$0	\$44,538	\$44,274	\$264	\$44,274
2013	\$30,749	\$0	\$9,500	\$0	\$0	\$40,249	\$40,249	\$0	\$40,249
2012	\$28,968	\$0	\$11,500	\$0	\$0	\$40,468	\$40,468	\$25,000	\$15,468
2011	\$43,272	\$0	\$12,500	\$0	\$0	\$55,772	\$55,772	\$30,772	\$25,000
2010	\$62,333	\$0	\$20,000	\$0	\$0	\$82,333	\$80,478	\$51,855	\$30,478

**Building Information**

<b>Building</b>	1	<b>Roof Structure</b>	Gable Hip
<b>Actual Area</b>	684	<b>Roof Cover</b>	Composite Shingle
<b>Conditioned Area</b>	1078	<b>Interior Flooring</b>	Carpet, Sheet Vinyl
<b>Actual Year Built</b>	1986	<b>Interior Wall</b>	Drywall
<b>Use</b>	Single Family Townhouse	<b>Heating Type</b>	Air Duct
<b>Style</b>	01	<b>Heating Fuel</b>	
<b>Class</b>	N	<b>Air Conditioning</b>	Central
<b>Exterior Wall</b>	Stucco, Wood	<b>Baths</b>	

Category	Type	Pct
Exterior Wall	Wood	80%
Exterior Wall	Stucco	20%
Roofing Structure	Gable Hip	100%
Roofing Cover	Composite Shingle	100%
Interior Walls	Drywall	100%
Interior Flooring	Carpet	70%
Interior Flooring	Sheet Vinyl	30%
Heating Type	Air Duct	100%
Air Conditioning	Central	100%
Frame	Wood Frame	100%
Plumbing	7 Fixtures	100%
Electrical	Good	100%
Foundation	Concrete Perimeter Footing	100%
Floor System	Concrete Slab	100%

Description	Conditioned Area	Actual Area
FINISHED OPEN PORCH	0	42
BASE AREA	54	54
2 STORY	1024	512
SLAB	0	60
FRAME UTILITY	0	16
Total SqFt	1078	684

**Land Information**

Use Description	Front	Depth	Total Land Units	Unit Type	Land Value
Single Family Townhouse	0	0	1	UT	\$24,000

**Sale Information**

Recording Date	Sale Date	Sale Price	Instrument Type	Book	Page	Qualification	Vacant/Improved	Grantor	Grantee
7/13/2016	7/7/2016	\$100,600.00	WD	<a href="#">4222</a>	<a href="#">1045</a>	U	I	BACON JAMES	BACON JAMES E ETAL
12/16/2014	12/2/2014	\$35,900.00	CT	<a href="#">3965</a>	<a href="#">805</a>	U	I	FITZGERALD LISA (DECD)	BACON JAMES E
2/6/2013	2/1/2013	\$0.00	LP	<a href="#">3682</a>	<a href="#">1256</a>	U	I	CENLAR FSB	FITZGERALD LISA (DECD)
	1/30/2008	\$0.00	FJ	<a href="#">3039</a>	<a href="#">1332</a>	U	I	FITZGERALD LISA	FITZGERALD LISA
	10/16/2002	\$100.00	WD	<a href="#">1834</a>	<a href="#">1206</a>	U	I	MIHAUCICH MARIO	FITZGERALD LISA
	10/14/2002	\$100.00	WD	<a href="#">1834</a>	<a href="#">1207</a>	U	I	MIHAUCICH DONNA	FITZGERALD LISA
	10/13/2002	\$0.00	HR	<a href="#">1863</a>	<a href="#">424</a>	U	I	MIHAUCICH MURIEL A ESTATE	FITZGERALD LISA,MIHAUCICH DONNA & MARIO
	9/18/2002	\$0.00	LA	<a href="#">1826</a>	<a href="#">1181</a>	U	I	MIHAUCICH MURIEL ESTATE (LETTERS/ADMIN)	FITZGERALD LISA (PERS REP)
	1/18/1994	\$55,000.00	WD	<a href="#">1033</a>	<a href="#">439</a>	Q	I	LYNCH JAMES J,VERNA M	MIHAUCICH MURIEL
	4/1/1987	\$52,100.00		<a href="#">743</a>	<a href="#">311</a>	Q	I		LYNCH JAMES J,VERNA M
	1/1/1986	\$0.00		<a href="#">720</a>	<a href="#">668</a>	U	V		
	3/1/1984	\$0.00		<a href="#">632</a>	<a href="#">557</a>	Q	V		

**Sketch Information**

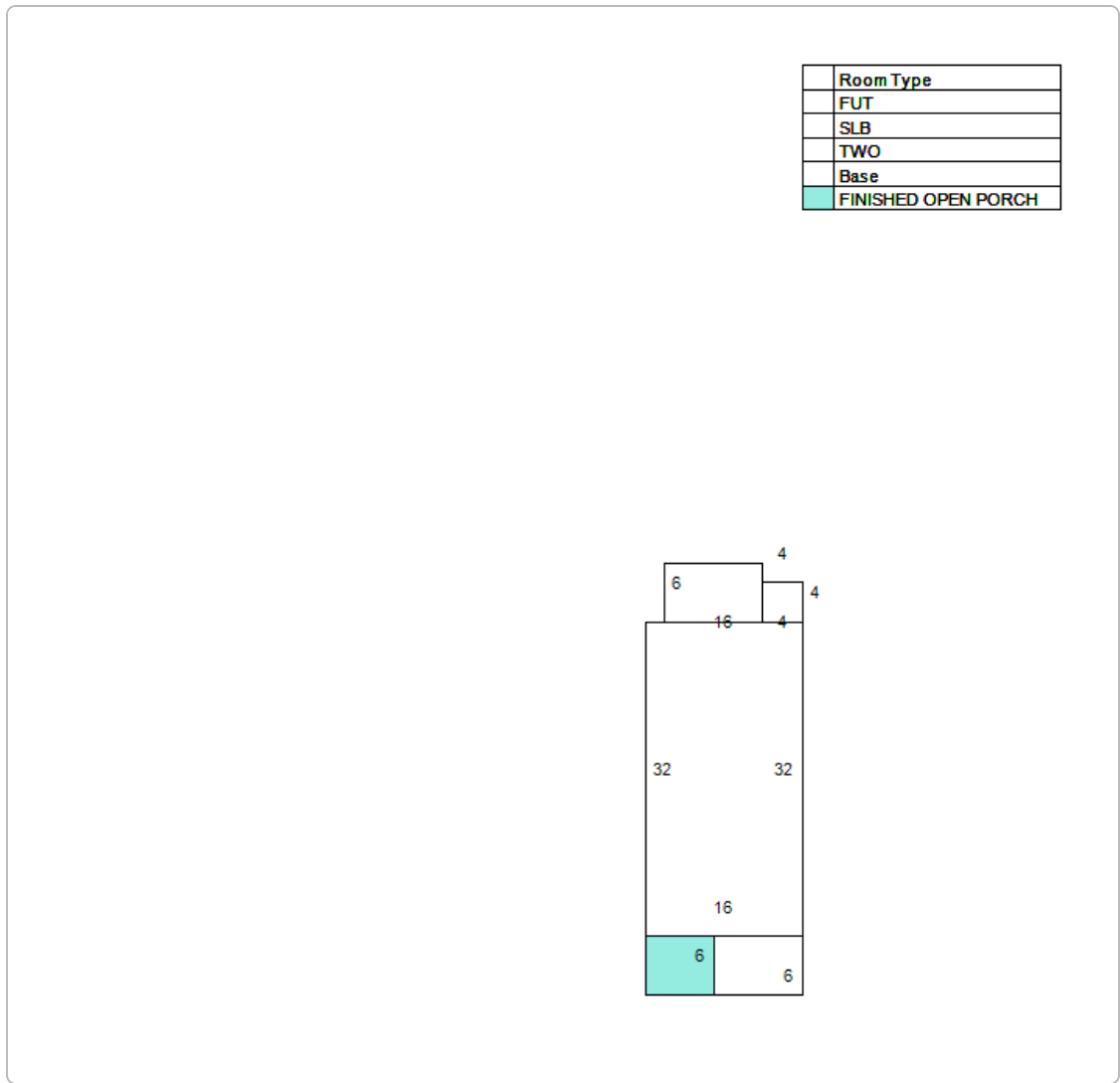

No data available for the following modules: Exemption Information, Extra Feature Information.

[User Privacy Policy](#)  
[GDPR Privacy Notice](#)

[Last Data Upload: 10/13/2020, 12:17:40 AM](#)



[Version 2.3.90](#)