

Luminaire Schedule					
Symbol	Qty	Label	Description	LLF	Lum. Watts
	12	C1	FINELITE HP-4-WL-SM-X'-S-840-F-VOLT-SC-C4	0.900	14.4
	2	SA	GARDCO PBL-42-14L-350-NW-G2-3-UNV	0.900	17.7
	6	SB	GARDCO PBL-42-14L-100-NW-G2-3-UNV	0.900	6.1

Calculation Summary						
Label	CalcType	Units	Avg	Max	Min	Max/Min
PARKING AND DRIVE	Illuminance	Fc	2.81	6.2	0.6	10.33
PROPERTY LINE	Illuminance	Fc	0.00	0.0	0.0	N.A.

TOTAL RIGHT OF WAY WIDTH: 50 FEET
PUBLIC DEDICATED RIGHT OF WAY
(N.E. 9TH STREET (PLAT))
N.E. 7TH STREET (FIELD)

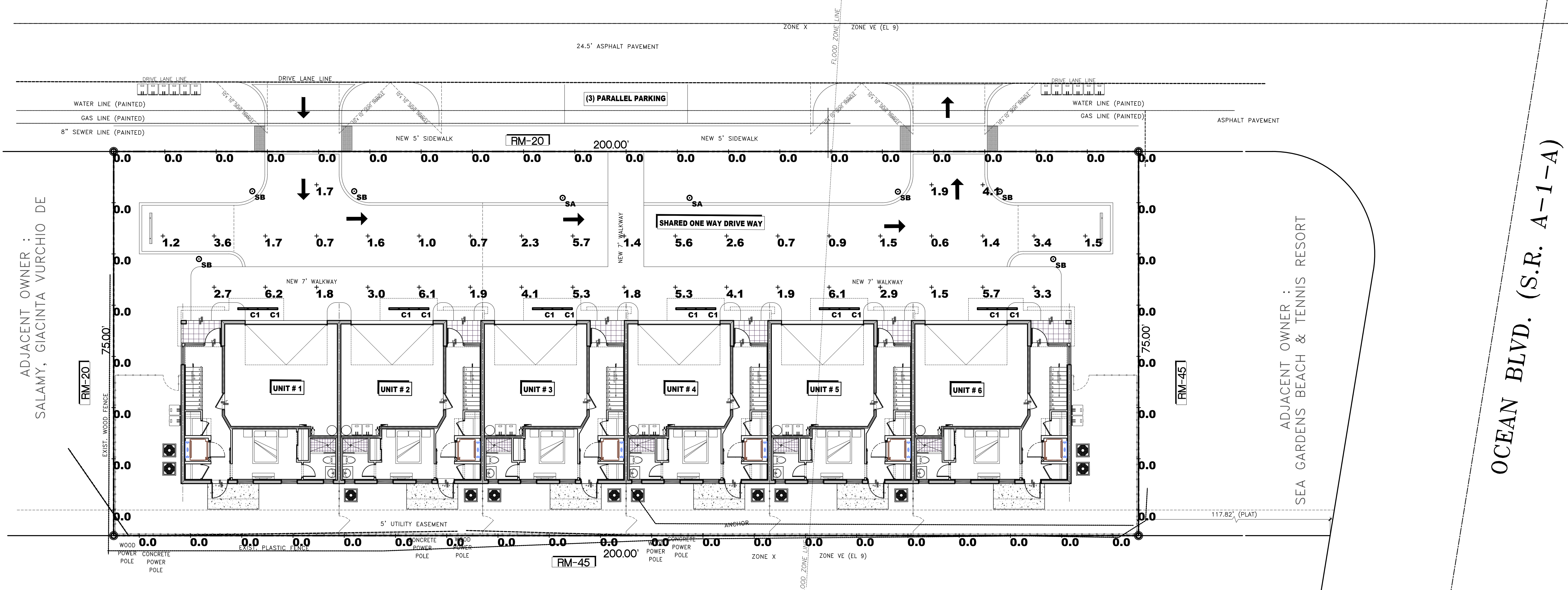

ADJACENT OWNER :
SEA GARDENS BEACH & TENNIS RESORT

1 PROPOSED SITE PHOTOMETRIC PLAN



REVISION	BY:

GUSTAVO J. CARBONELL, P.A.
Architect and Planner
1457 N.E. 4th AVE.
Ft. Lauderdale, Florida, 33304
(954) 462-6565
Member American Institute of Architects

SIX (3) STORY TOWNHOUSES FOR:
OCEAN AZUL, LLC
3220 & 3224 NE 7th STREET
POMPAHO BEACH, FL

GUSTAVO J. CARBONELL
ARCHITECT, P.A.

FLORIDA REGISTRATION
AR. NO. 0007957
AA. NO. 26001131

DRAWN	M.J.G.
CHECKED	G.J.C.
DATE	May 2018
SCALE	AS NOTED
JOB. NO.	17-032
SHEET	

PH-1

OF 1 SHEETS