

REVISION	BY:

GUSTAVO J. CARBONELL, P.A.
 Architect and Planner
 1457 N.E. 4th AVE.
 Ft. Lauderdale, Florida, 33304
 (954) 462-6565
 Member American Institute of Architects



SIX (3) STORY TOWNHOUSES FOR:
OCEAN AZUL, LLC
 3220 & 3224 NE 7th STREET
 POMPANO BEACH, FL

GUSTAVO J. CARBONELL
 ARCHITECT, P.A.

FLORIDA REGISTRATION
 AR NO. 0007957
 AA NO. 26001131

DRAWN	M.J.G.
CHECKED	G.J.C.
DATE	May 2018
SCALE	AS NOTED
JOB. NO.	17-032
SHEET	A-4.0

A-4.0
 OF 1 SHEETS

WALL LEGEND:

	PAINTED 1/2" INCH. GYP. WALL BOARD, FLOOR TO CEILING (MOISTURE RESISTANT AT WET WALLS AND DENSHELD BRAND OR EQUAL AT TUBS AND SHOWER ENCLOSURES) ON 1" x 2" P.T. WOOD FURRING @ 16" O.C. WITH R-4.1 FOIL INSULATION (FULL HEIGHT) OVER 5/8" INCH C.M.U. WALL REINFORCED WITH PAINTED 1/2" STUCCO FINISH AT EXTERIOR SIDE ONLY. TYPICAL (U.O.N.).
	PAINTED 1/2" INCH GYPSUM WALLBOARD, FLOOR TO CEILING ON EACH SIDE OF 3 3/8" x 1 1/2" OR 6" x 1 1/2" (25 GA.) METAL STUDS AT 16" O.C. MOISTURE RESISTANT AT WET WALLS. PROVIDE 1/2" DENSHELD BRAND BOARD OR EQUAL AT TUBS AND SHOWER ENCLOSURES. TYP. INTERIOR PARTITION (U.O.N.).
	SAME AS TYP. PARTITION ABOVE WITH R-11 BATT INSULATION FLOOR TO CEILING BETWEEN GARAGE AND LIVING AREAS. OPTIONAL AT ALL BATHROOM'S WALLS. SEE FLOOR PLAN FOR EXACT LOCATION. TYP.

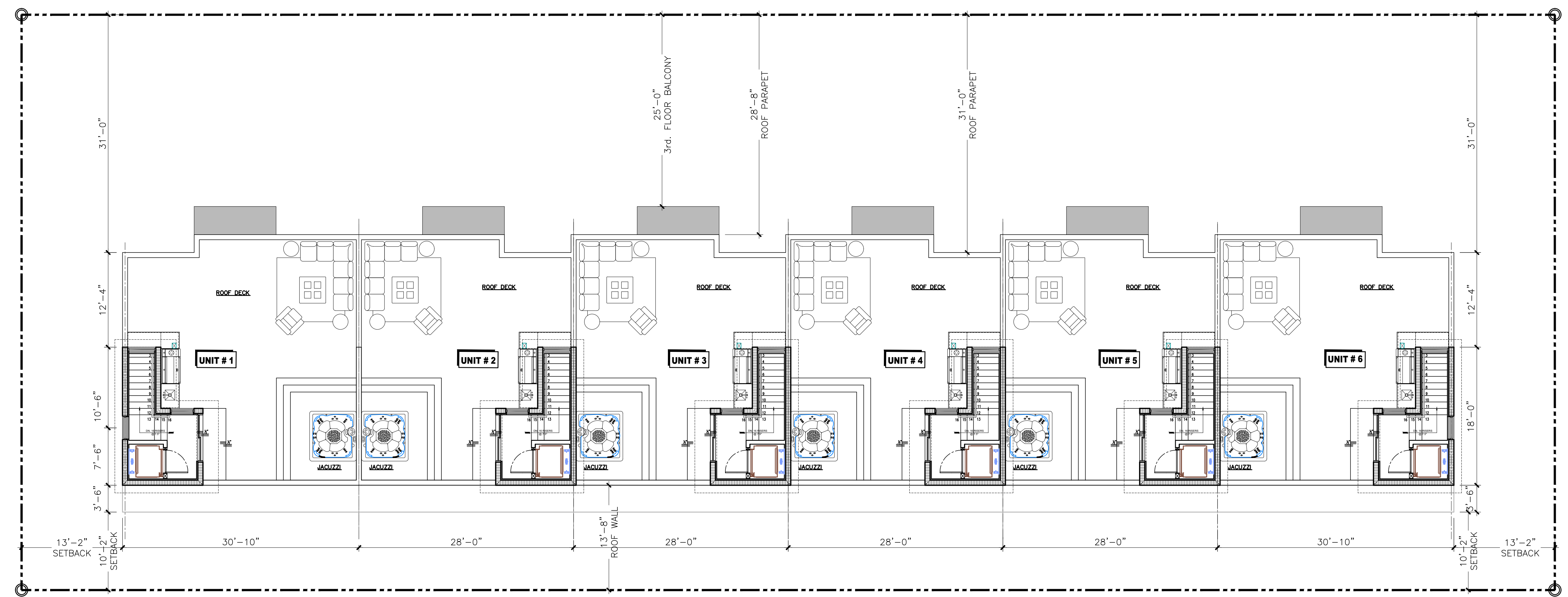

1 PROPOSED ROOF PLAN NORTH
 SCALE: 1"=1/8"