



**GENERAL EROSION CONTROL NOTES:**

1. THE EROSION CONTROL MEASURES SHALL BE INSTALLED AND MAINTAINED THROUGHOUT THE CONSTRUCTION PERIOD AND SHALL REMAIN IN PLACE UNTIL THE EROSION CONTROL MEASURES ARE DEEMED NECESSARY BY THE ENGINEER TO PERMIT THE RESUME OF SLOTT FROM THE SITE.
2. THE EROSION CONTROL MEASURES SHALL BE INSTALLED AND MAINTAINED THROUGHOUT THE CONSTRUCTION PERIOD AND SHALL REMAIN IN PLACE UNTIL THE EROSION CONTROL MEASURES ARE DEEMED NECESSARY BY THE ENGINEER TO PERMIT THE RESUME OF SLOTT FROM THE SITE.
3. THE EROSION CONTROL MEASURES SHALL BE INSTALLED AND MAINTAINED THROUGHOUT THE CONSTRUCTION PERIOD AND SHALL REMAIN IN PLACE UNTIL THE EROSION CONTROL MEASURES ARE DEEMED NECESSARY BY THE ENGINEER TO PERMIT THE RESUME OF SLOTT FROM THE SITE.
4. THE EROSION CONTROL MEASURES SHALL BE INSTALLED AND MAINTAINED THROUGHOUT THE CONSTRUCTION PERIOD AND SHALL REMAIN IN PLACE UNTIL THE EROSION CONTROL MEASURES ARE DEEMED NECESSARY BY THE ENGINEER TO PERMIT THE RESUME OF SLOTT FROM THE SITE.
5. THE EROSION CONTROL MEASURES SHALL BE INSTALLED AND MAINTAINED THROUGHOUT THE CONSTRUCTION PERIOD AND SHALL REMAIN IN PLACE UNTIL THE EROSION CONTROL MEASURES ARE DEEMED NECESSARY BY THE ENGINEER TO PERMIT THE RESUME OF SLOTT FROM THE SITE.
6. THE EROSION CONTROL MEASURES SHALL BE INSTALLED AND MAINTAINED THROUGHOUT THE CONSTRUCTION PERIOD AND SHALL REMAIN IN PLACE UNTIL THE EROSION CONTROL MEASURES ARE DEEMED NECESSARY BY THE ENGINEER TO PERMIT THE RESUME OF SLOTT FROM THE SITE.
7. THE EROSION CONTROL MEASURES SHALL BE INSTALLED AND MAINTAINED THROUGHOUT THE CONSTRUCTION PERIOD AND SHALL REMAIN IN PLACE UNTIL THE EROSION CONTROL MEASURES ARE DEEMED NECESSARY BY THE ENGINEER TO PERMIT THE RESUME OF SLOTT FROM THE SITE.
8. THE EROSION CONTROL MEASURES SHALL BE INSTALLED AND MAINTAINED THROUGHOUT THE CONSTRUCTION PERIOD AND SHALL REMAIN IN PLACE UNTIL THE EROSION CONTROL MEASURES ARE DEEMED NECESSARY BY THE ENGINEER TO PERMIT THE RESUME OF SLOTT FROM THE SITE.
9. THE EROSION CONTROL MEASURES SHALL BE INSTALLED AND MAINTAINED THROUGHOUT THE CONSTRUCTION PERIOD AND SHALL REMAIN IN PLACE UNTIL THE EROSION CONTROL MEASURES ARE DEEMED NECESSARY BY THE ENGINEER TO PERMIT THE RESUME OF SLOTT FROM THE SITE.
10. THE EROSION CONTROL MEASURES SHALL BE INSTALLED AND MAINTAINED THROUGHOUT THE CONSTRUCTION PERIOD AND SHALL REMAIN IN PLACE UNTIL THE EROSION CONTROL MEASURES ARE DEEMED NECESSARY BY THE ENGINEER TO PERMIT THE RESUME OF SLOTT FROM THE SITE.
11. THE EROSION CONTROL MEASURES SHALL BE INSTALLED AND MAINTAINED THROUGHOUT THE CONSTRUCTION PERIOD AND SHALL REMAIN IN PLACE UNTIL THE EROSION CONTROL MEASURES ARE DEEMED NECESSARY BY THE ENGINEER TO PERMIT THE RESUME OF SLOTT FROM THE SITE.
12. THE EROSION CONTROL MEASURES SHALL BE INSTALLED AND MAINTAINED THROUGHOUT THE CONSTRUCTION PERIOD AND SHALL REMAIN IN PLACE UNTIL THE EROSION CONTROL MEASURES ARE DEEMED NECESSARY BY THE ENGINEER TO PERMIT THE RESUME OF SLOTT FROM THE SITE.
13. THE EROSION CONTROL MEASURES SHALL BE INSTALLED AND MAINTAINED THROUGHOUT THE CONSTRUCTION PERIOD AND SHALL REMAIN IN PLACE UNTIL THE EROSION CONTROL MEASURES ARE DEEMED NECESSARY BY THE ENGINEER TO PERMIT THE RESUME OF SLOTT FROM THE SITE.
14. THE EROSION CONTROL MEASURES SHALL BE INSTALLED AND MAINTAINED THROUGHOUT THE CONSTRUCTION PERIOD AND SHALL REMAIN IN PLACE UNTIL THE EROSION CONTROL MEASURES ARE DEEMED NECESSARY BY THE ENGINEER TO PERMIT THE RESUME OF SLOTT FROM THE SITE.
15. THE EROSION CONTROL MEASURES SHALL BE INSTALLED AND MAINTAINED THROUGHOUT THE CONSTRUCTION PERIOD AND SHALL REMAIN IN PLACE UNTIL THE EROSION CONTROL MEASURES ARE DEEMED NECESSARY BY THE ENGINEER TO PERMIT THE RESUME OF SLOTT FROM THE SITE.
16. THE EROSION CONTROL MEASURES SHALL BE INSTALLED AND MAINTAINED THROUGHOUT THE CONSTRUCTION PERIOD AND SHALL REMAIN IN PLACE UNTIL THE EROSION CONTROL MEASURES ARE DEEMED NECESSARY BY THE ENGINEER TO PERMIT THE RESUME OF SLOTT FROM THE SITE.
17. THE EROSION CONTROL MEASURES SHALL BE INSTALLED AND MAINTAINED THROUGHOUT THE CONSTRUCTION PERIOD AND SHALL REMAIN IN PLACE UNTIL THE EROSION CONTROL MEASURES ARE DEEMED NECESSARY BY THE ENGINEER TO PERMIT THE RESUME OF SLOTT FROM THE SITE.
18. THE EROSION CONTROL MEASURES SHALL BE INSTALLED AND MAINTAINED THROUGHOUT THE CONSTRUCTION PERIOD AND SHALL REMAIN IN PLACE UNTIL THE EROSION CONTROL MEASURES ARE DEEMED NECESSARY BY THE ENGINEER TO PERMIT THE RESUME OF SLOTT FROM THE SITE.
19. THE EROSION CONTROL MEASURES SHALL BE INSTALLED AND MAINTAINED THROUGHOUT THE CONSTRUCTION PERIOD AND SHALL REMAIN IN PLACE UNTIL THE EROSION CONTROL MEASURES ARE DEEMED NECESSARY BY THE ENGINEER TO PERMIT THE RESUME OF SLOTT FROM THE SITE.

ESTIMATED PROJECT START DATE: (APPROXIMATE AND TENTATIVE)

ACTIVITY	MO 1	MO 2	MO 3	MO 4	MO 5	MO 6
INSTALL EROSION CONTROL MEASURES						
CELEBRATE GRASSING & EROSION						
GRASSING						
MAINTAIN EROSION CONTROL MEASURES						
INSTALL UNDERGROUND UTILITIES						
INSTALL CURB & GUTTER						
INSTALL PAVING						
REMOVE EROSION CONTROL MEASURES						

24-HR. EMERGENCY CONTACT  
 GAINVILLE  
 770-382-2605

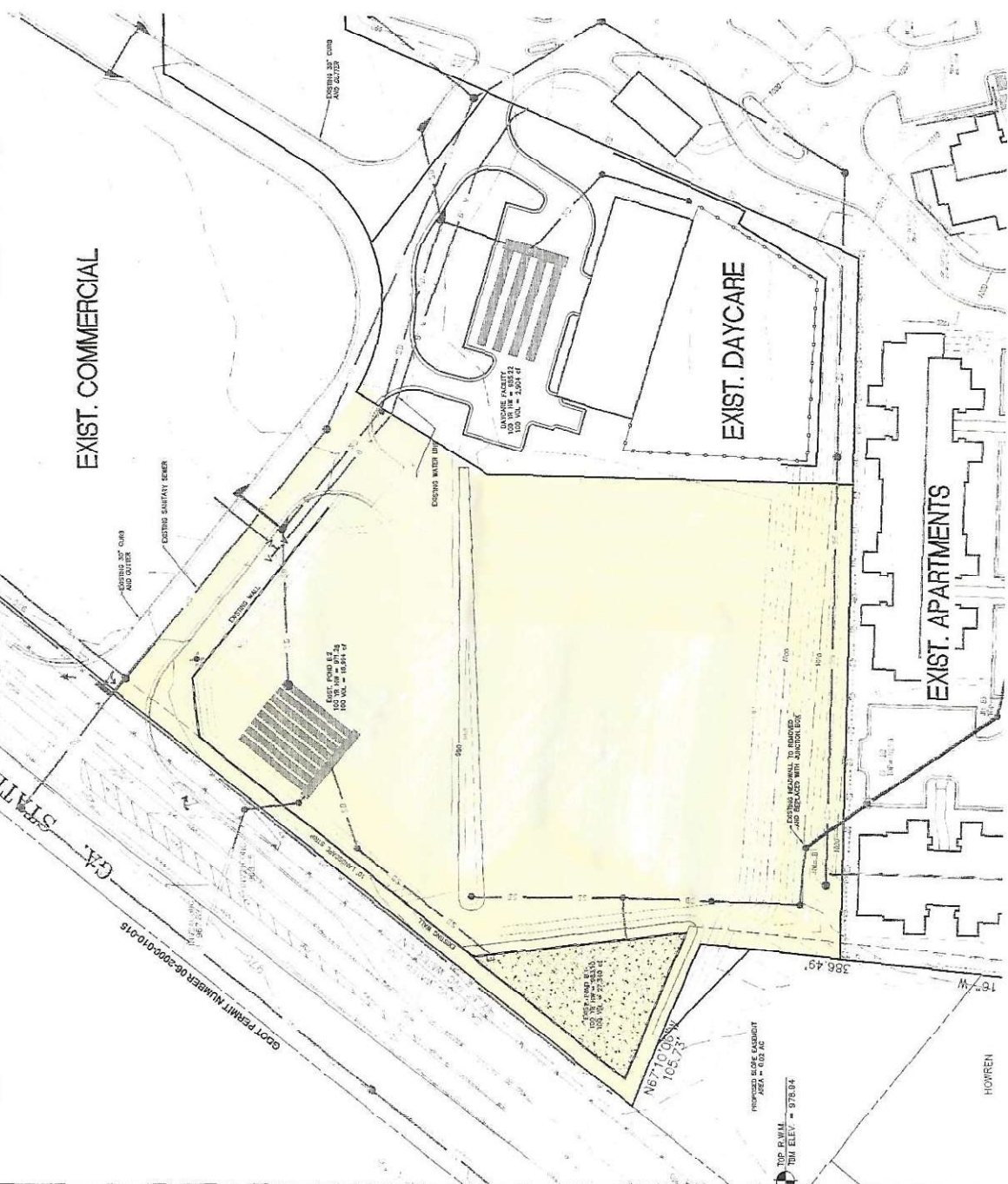

THE ESCAPE OF SEDIMENT FROM THE SITE SHALL BE PREVENTED BY THE INSTALLATION OF EROSION CONTROL MEASURES AND PRACTICES PRIOR TO, OR CONCURRENT WITH, LAND DISTURBING ACTIVITIES.  
 EROSION CONTROL MEASURES WILL BE INSPECTED AT LEAST WEEKLY AND AFTER EACH RAIN, AND REPAIRED BY GENERAL CONTRACTOR.  
 ADDITIONAL EROSION AND SEDIMENT CONTROL MEASURES WILL BE INSTALLED IF DEEMED NECESSARY BY ON-SITE INSPECTOR.

IF YOU DIG GEORGIA...  
 CALL US FIRST!  
 1-800-282-7411  
 770-623-4344  
 (METRO ATLANTA ONLY)  
 UTILITIES PROTECTION CENTER  
 IT'S THE LAW



UTILITY NOTE:  
 THE UTILITY LOCATIONS SHOWN ON THIS PLAN ARE FOR INFORMATION ONLY. THE CONTRACTOR SHALL VERIFY THE LOCATION AND DEPTH OF ALL UTILITIES PRIOR TO CONSTRUCTION. THE CONTRACTOR SHALL BE RESPONSIBLE FOR ANY DAMAGE TO UTILITIES CAUSED BY THE CONTRACTOR'S WORK. ANY DAMAGE TO UTILITIES SHALL BE REPAIRED AT THE CONTRACTOR'S EXPENSE. THE CONTRACTOR SHALL BE RESPONSIBLE FOR ANY DAMAGE TO UTILITIES CAUSED BY THE CONTRACTOR'S WORK. ANY DAMAGE TO UTILITIES SHALL BE REPAIRED AT THE CONTRACTOR'S EXPENSE.

Randy May 20 Property