

LECOMTE BUILDING—4500 South Flores Street

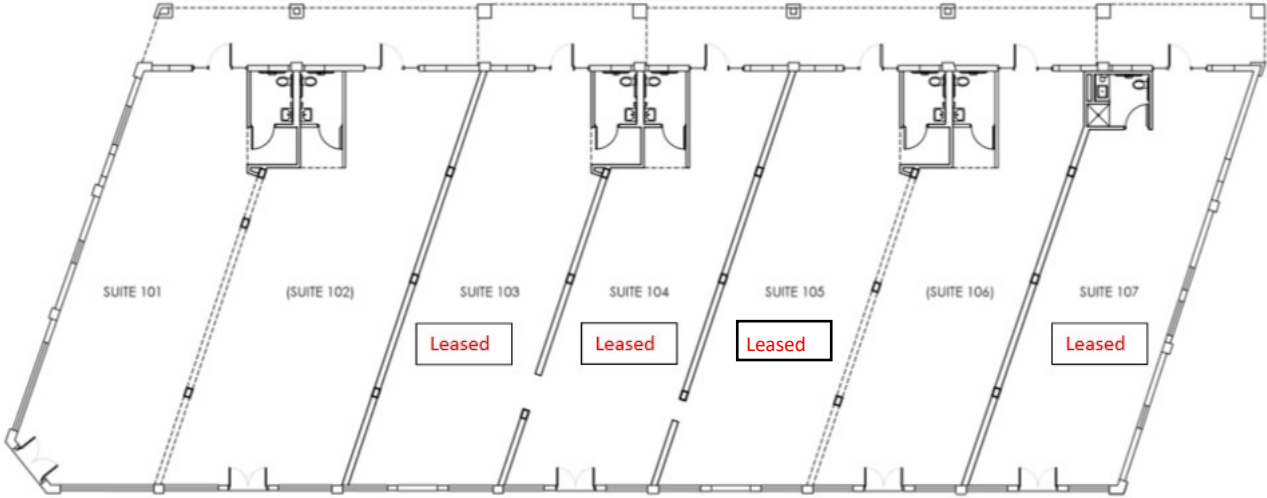

Urban Re-Development
New windows, refurbished doors and metal ceilings, convenient Bus line, near Southtown, King William, Lone Start District, Missions and Riverwalk with easy access to IH35.

USES	FEATURES
Retail	3 units available
Medical	Min: 1,200 SF
Restaurant	Max: 2,400 SF contiguous
	3—5 Year Terms
	White Box Finish-out



Contact: **JULIE HINOJOSA, BROKER, CCIM** Cell: 210-643-1348
MLS# 1408980

<https://juliehinojosa.sanantoniostinestrealty.com/>

