

CPG OFFICES

CARR.#5, KM 27.4
 BUILDING 1 PUERTO NUEVO
 DISTRIBUTION CENTER BO.
 PALMAS, CATAÑO, PR

KEY PLAN

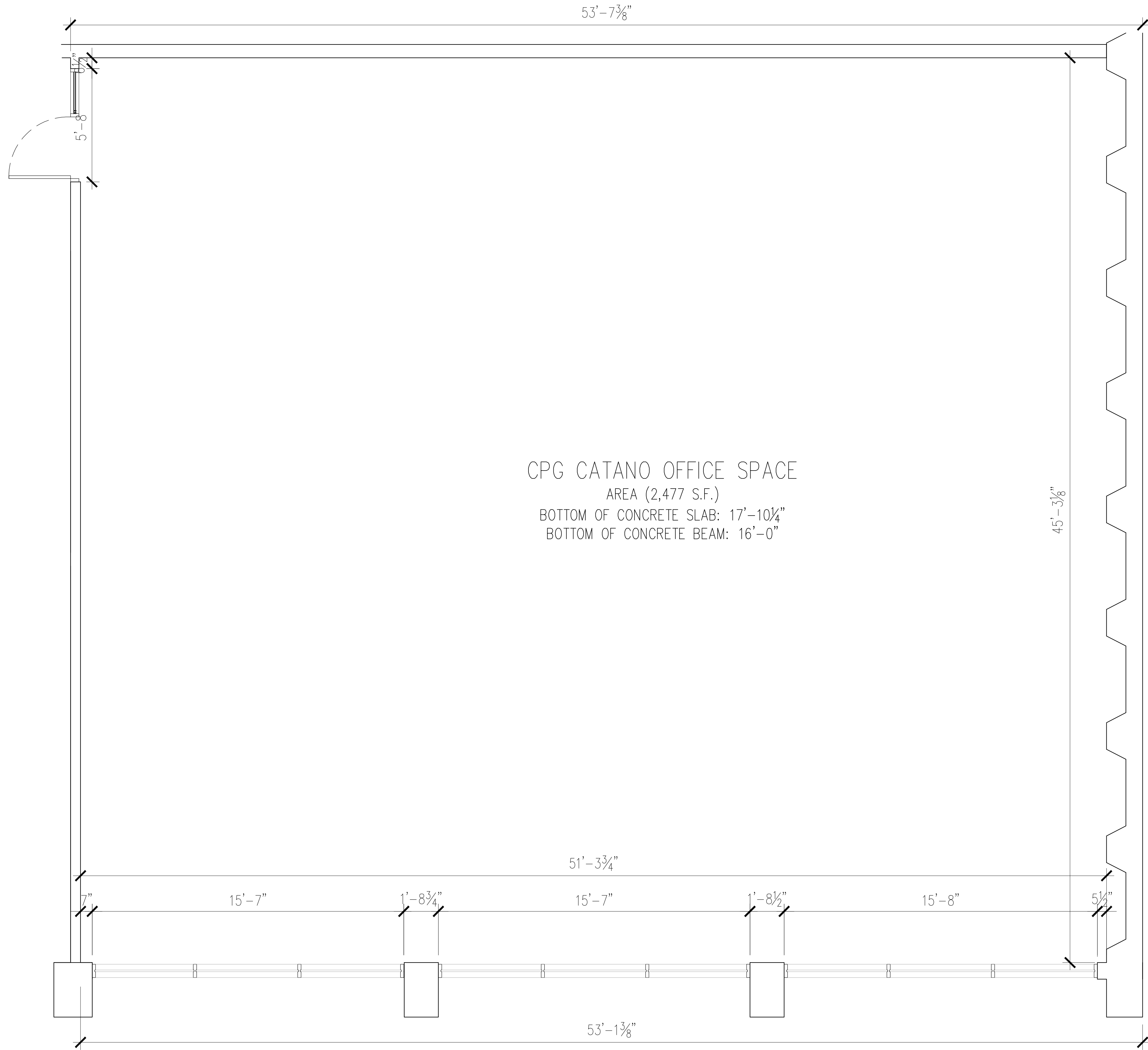

CPG CATANO OFFICE SPACE
 AREA (2,477 S.F.)
 BOTTOM OF CONCRETE SLAB: 17'-10 1/4"
 BOTTOM OF CONCRETE BEAM: 16'-0"

CONSULTANTS

REVISIONS

NO.	DATE	ISSUES

COPYRIGHT
 THESE PLANS ARE AN INSTRUMENT OF SERVICE
 AND THE PROPERTY OF THE ARCHITECTS. THEY
 MAY NOT BE COPIED OR REPRODUCED WITHOUT
 THEIR EXPRESS AND WRITTEN CONSENT.

CONSULTANT

SEAL

GENERAL NOTES:
 THE LEASE PLAN DRAWING SHOWN IS
 AN ADVANCE PLAN FOR NEGOTIATION
 PURPOSES ONLY. IT IS NOT AN AS
 BUILT DRAWING. INFORMATION SHOWN
 HERE IS NOT TO BE INTERPRETED AS
 FINAL OR COMPLETE. TENANTS SHALL
 VERIFY LEASE AREA FIELD CONDITIONS
 AT THE SITE.

LOD - CPG CATAÑO
 OFFICE FLOOR PLAN
 SCALE: 3/8" = 1'-0"

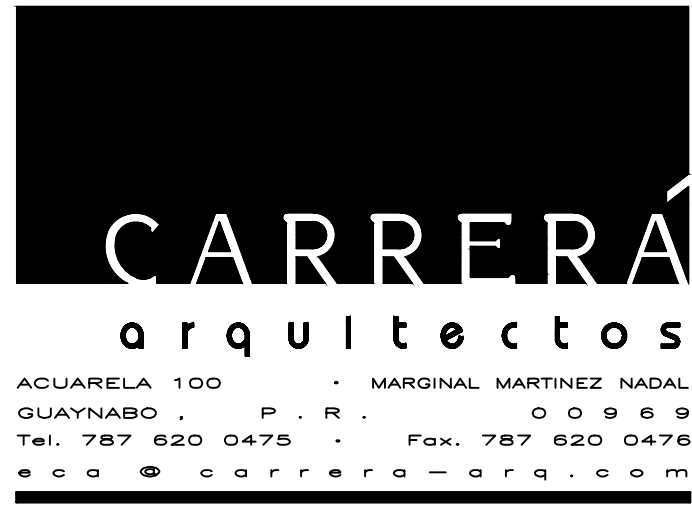

ACUARELA 100 . MARGINAL MARTINEZ NADAL
 GUAYNABO . P . R . . O . B . B . B
 Tel: 787 620 0475 . Fax: 787 620 0476
 e o o c o r r e r a - a r q . c o m

TITLE SHEET PAGE NUMBER
 LOD CPG OFFICES A100