

REVISIONS	DATE
1	12-28-09
2	1-5-10
3	2-4-10
4	
5	
6	
7	
8	

PROJECT NO. ...  
DATE 11/25/09

INTERIOR ALTERATIONS  
FOR:  
**CLARK STREET PROFESSIONAL BUILDING**  
810 CLARK STREET  
OVIDO, FLORIDA

TEL (352) 385-1030  
FAX (352) 385-1035

**Rabits & Associates**  
Architect & Planners  
245 SOUTH HIGHLAND STREET  
SUITE 9  
MOUNT DORA, FL 32757

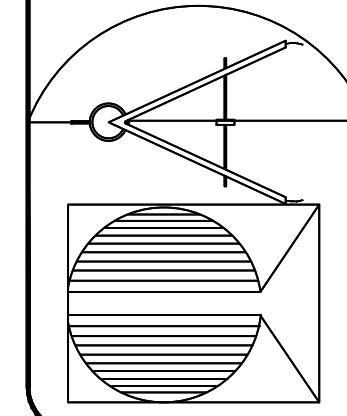

SHEET  
A-2  
OF  
16

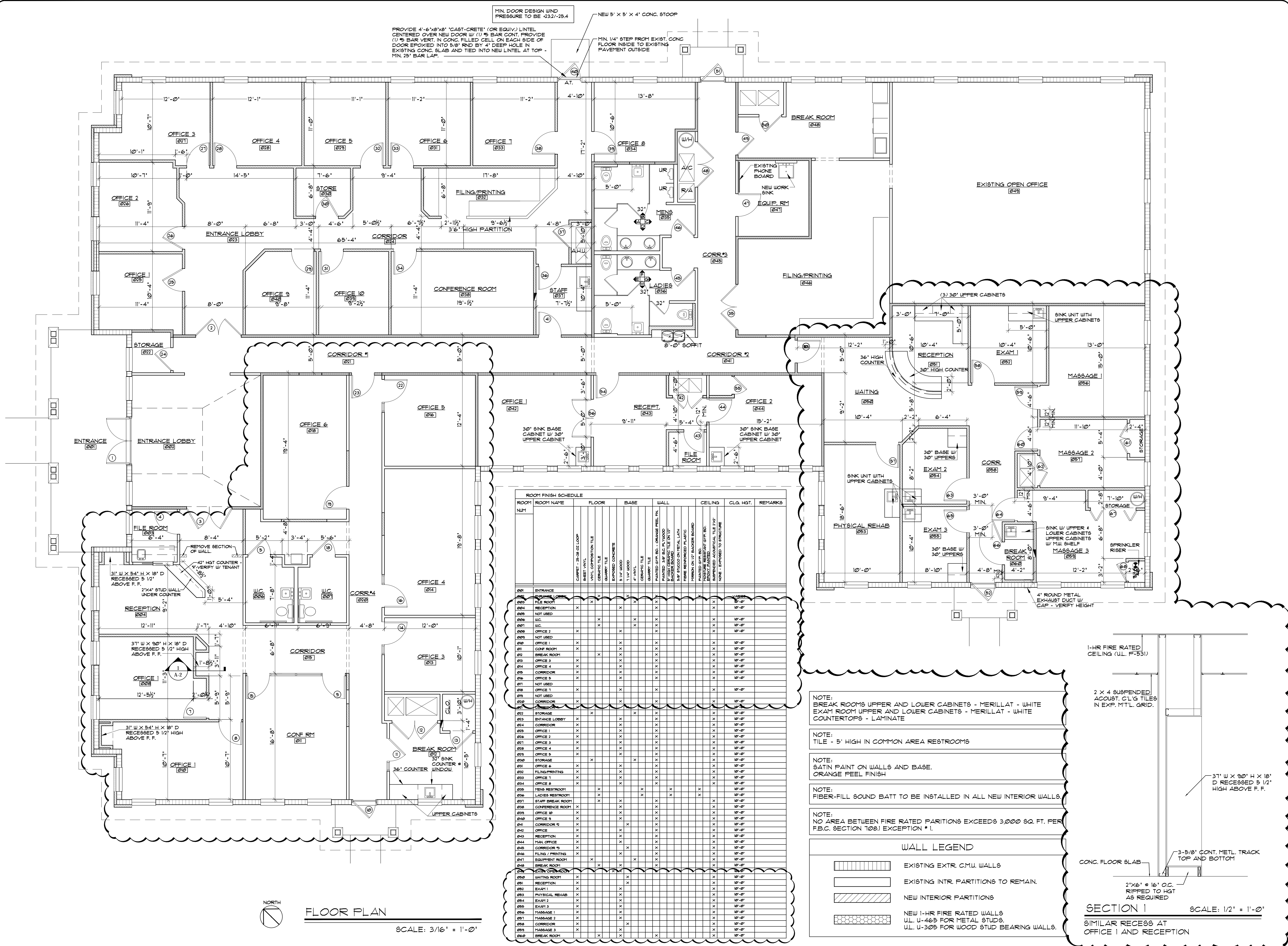

MIN. DOOR DESIGN WIND PRESSURE TO BE +23.7/-25.4  
NEW 5' x 5' x 4' CONC. STOOD  
MIN. 1/4\"/>

PROVIDE 4'-6\"/>

ROOM	ROOM NAME	FLOOR	BASE	WALL	CEILING	CLG. HGT.	REMARKS
001	ENTRANCE						
002	FILE ROOM	X	X	X	X	10'-0"	
004	RECEPTION	X	X	X	X	10'-0"	
005	NOT USED						
006	WC	X	X	X	X	10'-0"	
007	WC	X	X	X	X	10'-0"	
008	OFFICE 2	X	X	X	X	10'-0"	
009	NOT USED						
010	OFFICE	X	X	X	X	10'-0"	
011	LOBBY ROOM	X	X	X	X	10'-0"	
012	BREAK ROOM	X	X	X	X	10'-0"	
013	OFFICE 3	X	X	X	X	10'-0"	
014	OFFICE 4	X	X	X	X	10'-0"	
015	CORRIDOR	X	X	X	X	10'-0"	
016	OFFICE 5	X	X	X	X	10'-0"	
017	NOT USED						
018	OFFICE 1	X	X	X	X	10'-0"	
019	NOT USED						
020	CORRIDOR	X	X	X	X	10'-0"	
021	CORRIDOR	X	X	X	X	10'-0"	
022	STORAGE	X	X	X	X	10'-0"	
023	ENTRANCE LOBBY	X	X	X	X	10'-0"	
024	CORRIDOR	X	X	X	X	10'-0"	
025	OFFICE 1	X	X	X	X	10'-0"	
026	OFFICE 2	X	X	X	X	10'-0"	
027	OFFICE 3	X	X	X	X	10'-0"	
028	OFFICE 4	X	X	X	X	10'-0"	
029	OFFICE 5	X	X	X	X	10'-0"	
030	STORAGE	X	X	X	X	10'-0"	
031	OFFICE 6	X	X	X	X	10'-0"	
032	FILING/PRINTING	X	X	X	X	10'-0"	
033	OFFICE 1	X	X	X	X	10'-0"	
034	OFFICE 8	X	X	X	X	10'-0"	
035	MENS RESTROOM	X	X	X	X	10'-0"	
036	LADIES RESTROOM	X	X	X	X	10'-0"	
037	STAFF BREAK ROOM	X	X	X	X	10'-0"	
038	CONFERENCE ROOM	X	X	X	X	10'-0"	
039	OFFICE 10	X	X	X	X	10'-0"	
040	OFFICE 9	X	X	X	X	10'-0"	
041	CORRIDOR 9	X	X	X	X	10'-0"	
042	OFFICE	X	X	X	X	10'-0"	
043	RECEPTION	X	X	X	X	10'-0"	
044	MAN OFFICE	X	X	X	X	10'-0"	
045	CORRIDOR 9	X	X	X	X	10'-0"	
046	FILING/PRINTING	X	X	X	X	10'-0"	
047	EQUIPMENT ROOM	X	X	X	X	10'-0"	
048	BREAK ROOM	X	X	X	X	10'-0"	
049	WAITING ROOM	X	X	X	X	10'-0"	
050	RECEPTION	X	X	X	X	10'-0"	
051	EXAM 1	X	X	X	X	10'-0"	
052	EXAM 2	X	X	X	X	10'-0"	
053	EXAM 3	X	X	X	X	10'-0"	
054	EXAM 1	X	X	X	X	10'-0"	
055	EXAM 2	X	X	X	X	10'-0"	
056	EXAM 3	X	X	X	X	10'-0"	
057	MASSAGE 1	X	X	X	X	10'-0"	
058	MASSAGE 2	X	X	X	X	10'-0"	
059	CORRIDOR	X	X	X	X	10'-0"	
060	MASSAGE 3	X	X	X	X	10'-0"	
061	BREAK ROOM	X	X	X	X	10'-0"	

NOTE:  
BREAK ROOMS UPPER AND LOWER CABINETS - MERILLAT - WHITE  
EXAM ROOM UPPER AND LOWER CABINETS - MERILLAT - WHITE  
COUNTERTOPS - LAMINATE

NOTE:  
TILE - 5' HIGH IN COMMON AREA RESTROOMS

NOTE:  
SATIN PAINT ON WALLS AND BASE.  
ORANGE PEEL FINISH

NOTE:  
FIBER-FILL SOUND BATT TO BE INSTALLED IN ALL NEW INTERIOR WALLS.

NOTE:  
NO AREA BETWEEN FIRE RATED PARTITIONS EXCEEDS 3,000 SQ. FT. PER  
F.B.C. SECTION 108.1 EXCEPTION # 1.

**WALL LEGEND**

	EXISTING EXTR. CMU WALLS
	EXISTING INTR. PARTITIONS TO REMAIN.
	NEW INTERIOR PARTITIONS
	NEW 1-HR FIRE RATED WALLS UL U-465 FOR METAL STUDS. UL U-305 FOR WOOD STUD BEARING WALLS.

