

***** PRICE REDUCED TO: \$29,716 per ac *****
6.36 AC TREE FARM & INVENTORY

***** ROAD & ELECTRIC AT SITE *****

19700 SW 390 Street, Florida City, FL 33034
Miami Dade County Folio # 30-8803-000-0210+0220+0230+0240



THE YELLOW ARROWS ARE SIGNS TO HELP YOU FIND YOUR WAY IN AT EVERY TURN.

- 4 individual parcels sold as package. Inventory included or owner will clear before closing.
- Well drained – Sottile ditch nearby. Diverging soil compositions of Perrine Marl Shallow and Very Shallow Phase, 4"-24" to bedrock. 4 ft. elevation – gradual Southern gradient.
- Financing available through Farm Credit of Homestead: Jonathan Borghi 305-248-6080

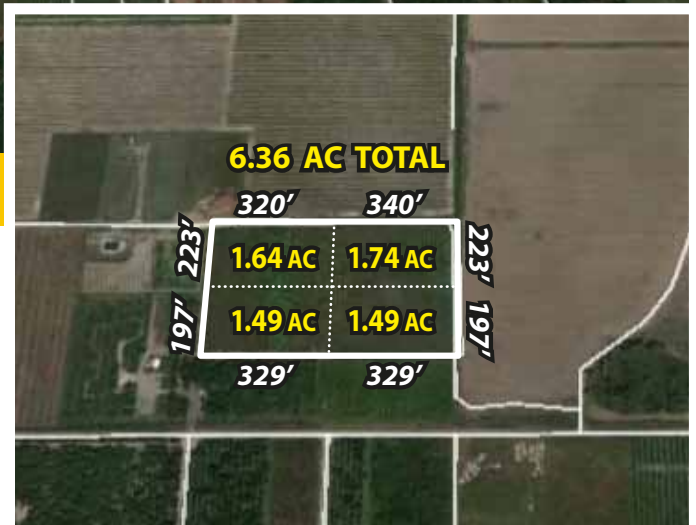

Richard A. Swentek



RICHARD A. SWENTEK, P.A., A.L.C.

305.773.5363

Office 305.453.0109

rickswen@bellsouth.net

FLORIDA 1 REALTY florida1realtyinc.com

103400 Overseas Hwy. Suite 250-D, Key Largo, FL 33037

\$189,000

The information contained herein is deemed accurate however no warranty either expressed or implied is hereby given.