

OFFICE/FLEX BUILDING FOR SALE

13521 Prestige Place

13521 PRESTIGE PLACE • TAMPA, FL • 33635

NET LEASE INVESTMENT OPPORTUNITY

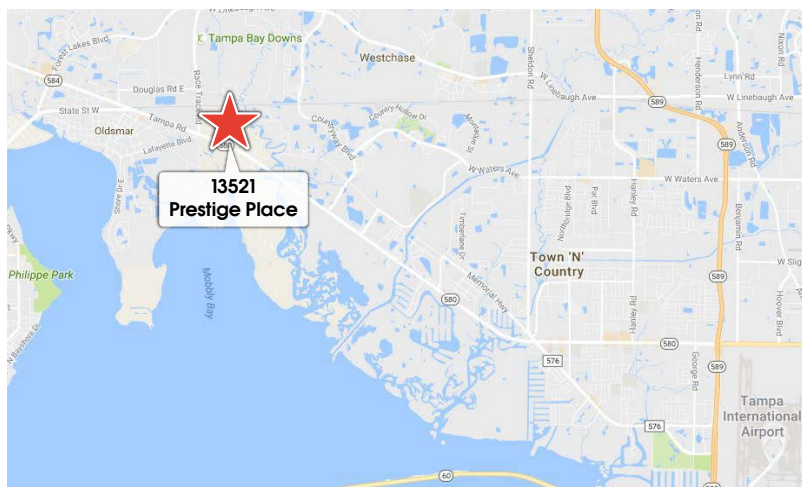

PROPERTY OVERVIEW

Building Size	16,254 sf
Property Type	Office/Flex Building
Year Built	2011
Occupancy	100% Leased NN Single Tenant (Expires 12/31/2021)
Asking Price	\$2,775,000

PROPERTY FEATURES

- + 12,422 sf AC Office / 2,867 sf Warehouse / 965 sf Mezzanine space
- + Upscale office build-out
- + Commercial grade kitchen
- + Warehouse includes 2-dock high bays with two 9'W x 10'H rollup doors
- + Mezzanine space for extra storage

LOCATION

- + Centrally located in the Monroe's Business Park in Oldsmar, near Westchase, Town and Country, Dunedin, Palm Harbor, and Safety Harbor
- + Convenient access to Hillsborough Ave (580), Tampa Rd and Racetrack Rd

For additional information, contact:

Elliott M. Ross, CCIM
(727) 639-3800 mobile • (813) 600-4815 office
eross@ciminelli.com



OFFICE/FLEX BUILDING FOR SALE

13521 Prestige Place

13521 PRESTIGE PLACE • TAMPA, FL • 33635



SITE PLAN

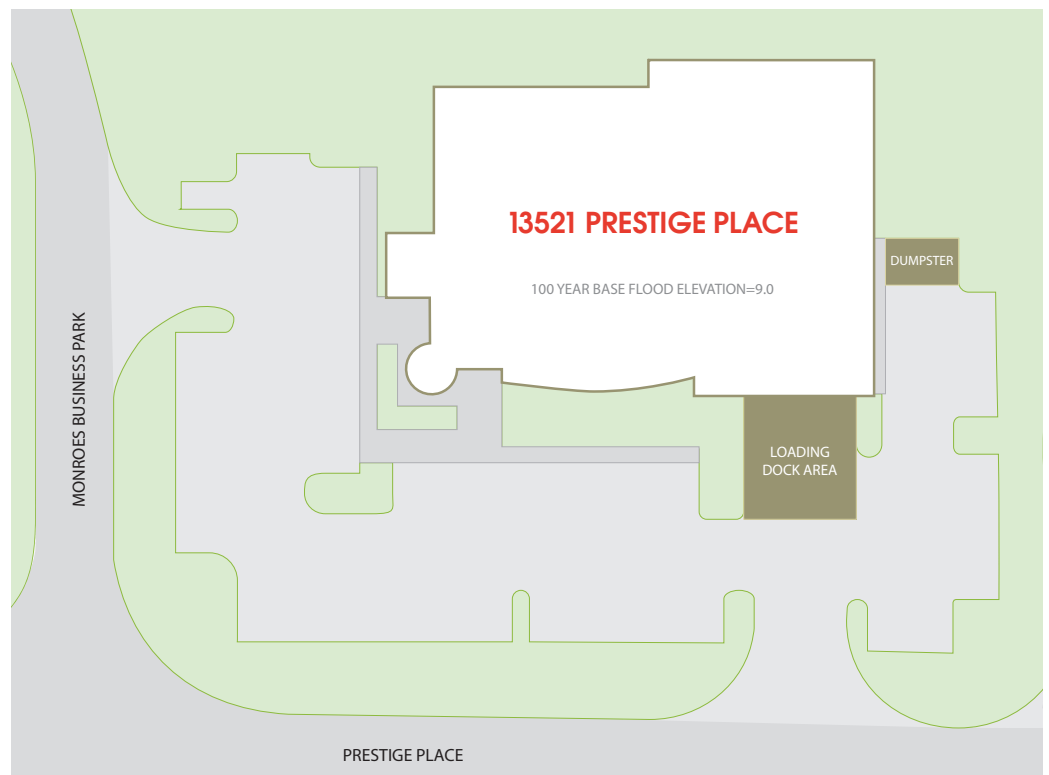

For additional information, contact:

Elliott M. Ross, CCIM

(727) 639-3800 mobile • (813) 600-4815 office

eross@ciminelli.com



14499 N Dale Mabry Hwy, Suite 200 • Tampa, FL 33618 + phone: 813.908.1727 • fax: 813.908.5518 + www.ciminelli.com/florida

All information given herein is obtained from sources considered reliable. However, we are not responsible for misstatement of facts, errors, omissions, prior sale, withdrawal from market, modification of mortgage commitment, terms and considerations, or change in price without notice. The information supplied herein is for informational purposes only and shall not contain a warranty or assurance that said information is correct. Any person intending to rely upon the information supplied herein should verify said information independently.

13521 PRESTIGE PLACE

Building Plan - 16,254 square feet

13521 PRESTIGE PLACE • TAMPA, FL • 33635

+ 12,422 sf AC Office + 2,867 sf Warehouse + 965 sf Mezzanine

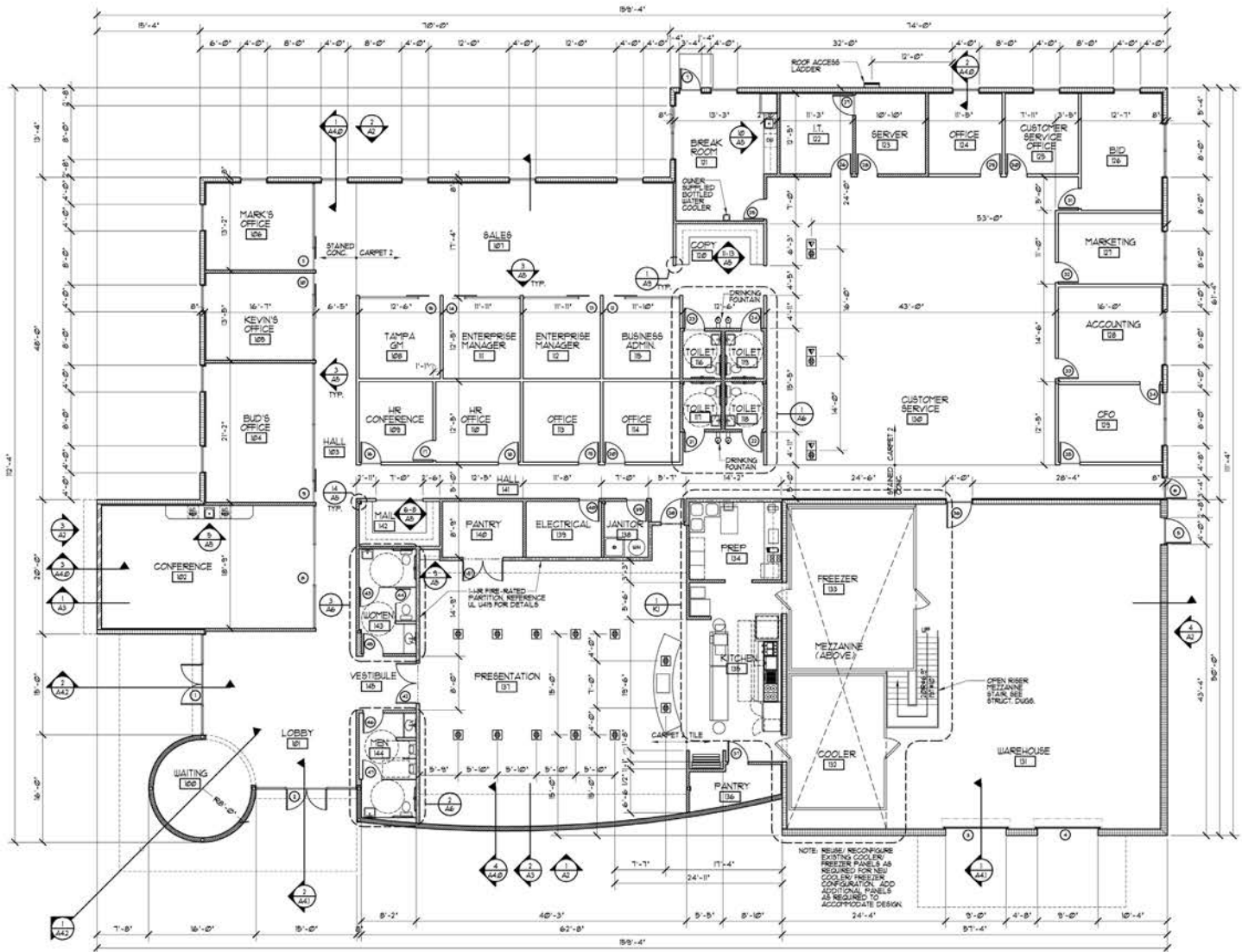

The above floor plan is not to scale. The available space shown is believed to be correct but is subject to change.

For additional information, contact:

Elliott M. Ross, CCIM
(727) 639-3800 mobile • (813) 600-4815 office
eross@ciminelli.com

