



# Prudential

## Commercial Real Estate FL

### FREESTANDING BUILDING ON 0.69+/- ACRES

2440 S. Nova Road  
South Daytona, Florida 32119

#### Property Summary

Property: 2440 S. Nova Road  
 Parcel No: 5344-16-00-1413  
 Status: For Sale  
 Size: 4,080 SF on 0.69+/- Acres  
 Price: **\$199,500**  
 Year Built: 1976



Zoning: BGC 'Business, General Commercial'

Population (est):	<u>1 MILE</u> 8,381	<u>3 MILES</u> 63,410	<u>5 MILES</u> 118,693
-------------------	------------------------	--------------------------	---------------------------

Average HHI (est.):	<u>1 MILE</u> \$41,282	<u>3 MILES</u> \$46,222	<u>5 MILES</u> \$47,461
---------------------	---------------------------	----------------------------	----------------------------

Traffic Count: 26,500 vehicles per day - Nova Road

- Property Highlights:
- Great visibility and exposure on high traffic Nova Road
  - Two overhead doors
  - Interior has office and open storage area, bathroom with shower
  - Large fenced yard for parking several vehicles
  - Great for Wholesale & Retail, Offices, Gun Shop, Business Services, Auctions, Studio, Dance, Gym, Martial Arts, etc.
  - Approximately 1.8 miles to Beville Road, 2.3 miles to Dunlawton Avenue, and 4.8 miles to Interstate 95 and Interstate 4
  - Easy to show
  - Ready for immediate occupancy

Rock Solid in Commercial Real Estate

John W. Trost, PA, CCIM  
 (386) 253-8565 Ext.115  
 (386) 295-5723 Mobile  
 JTROST@CCIM.NET

[www.JohnTrost.com](http://www.JohnTrost.com)

Information contained herein is believed to be accurate, but not guaranteed and may change without notice.



# PICTURES



PRUDENTIAL COMMERCIAL

ROCK SOLID IN COMMERCIAL REAL ESTATE

Information contained herein is believed to be accurate, but not guaranteed and may change without notice.

# BUILDING SKETCH

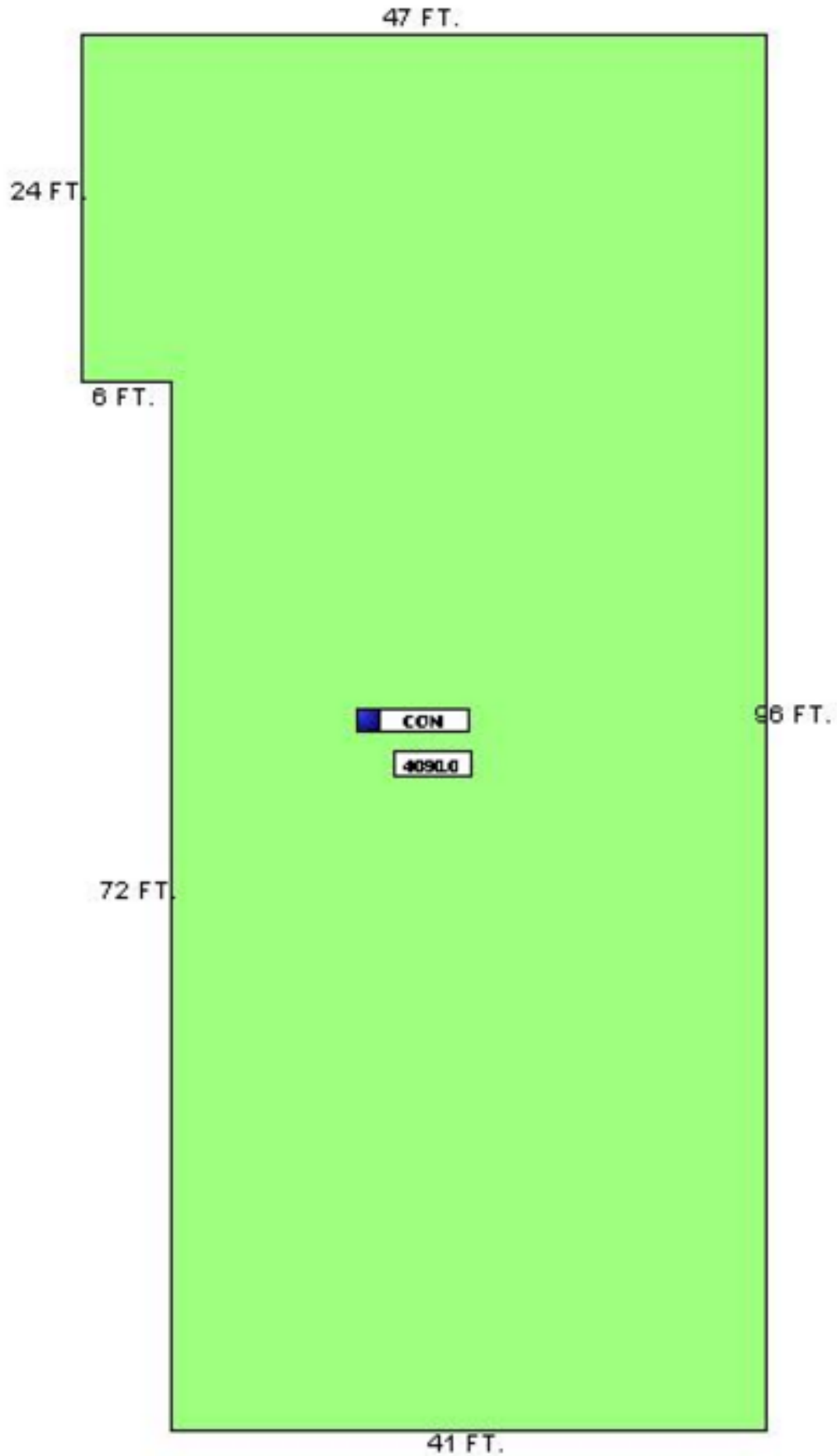

PRUDENTIAL COMMERCIAL

ROCK SOLID IN COMMERCIAL REAL ESTATE

Information contained herein is believed to be accurate, but not guaranteed and may change without notice.

©2015 BRER Affiliates Inc. An independently owned and operated broker member of BRER Affiliates Inc. Prudential, the Prudential logo, and the Rock symbol are service marks of Prudential Financial, Inc. and its related entities, registered in many jurisdictions worldwide. Used under license with no other affiliation with Prudential.



