

For Sale: Retail Building

PARC RETAIL STORE

5825 66th Street North | St. Petersburg, FL 33709



FEATURES

- 24,177 SF building, 1.72 acres (MOL)
 - 14,121 SF 1st floor (ceiling height approx. 10 feet)
 - 10,272 SF retail
 - 2,784 SF stockroom
 - 1,065 SF receiving
 - 13,056 SF 2nd floor (ceiling height approx. 9 feet)
- 161.71' of frontage on 66th Street North
- Parcel: 74,950 SF \approx 161' x 463'
- 52 parking spaces
- Zoned: C-2 (General Commercial and Limited Services District)
- Tax District: Pinellas County

ASKING PRICE

- \$1,500,000

LOCATION MAP

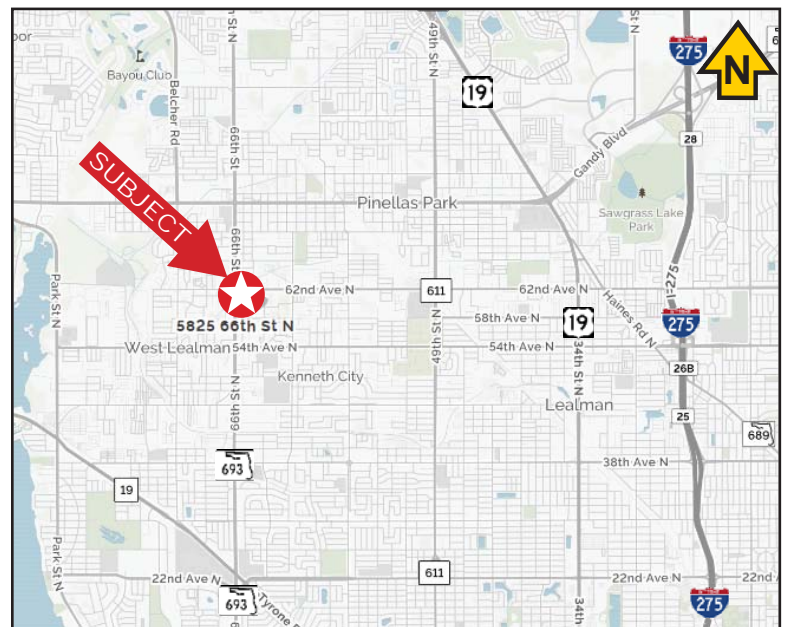

FOR ADDITIONAL INFORMATION:

Elliott M. Ross, CCIM
727.725.2800 (O)
727.639.3800 (C)
eross@rmcr.com

RMC ROSS REALTY
4401 W. Kennedy Boulevard, Suite 100
Tampa, FL 33609
www.RMCPG.com

For Sale: Retail Building

PARC RETAIL STORE

5825 66th Street North | St. Petersburg, FL 33709



Side View of Building



Store Interior



2nd Floor

All information given herein is obtained from sources considered reliable. However, we are not responsible for misstatement of facts, errors, omissions, prior sale, withdrawal from market, modification of mortgage commitment, terms and considerations, or change in price without notice. The information supplied herein is for informational purposes only and shall not contain a warranty or assurance that said information is correct. Any person intending to rely upon the information supplied herein should verify said information independently.

O:\ALLWORKS\PARC Retail Store\MARKETING\CURRENT FLYER & PACKAGE\PARC 022316