

FLAMMINGO BOULEVARD (50' RW)

MORTGAGE SURVEY
FILE COPY

ZONING PERMIT zoned C-1

to be used as Comm. Carport
Checked By LL Date 6/30/08

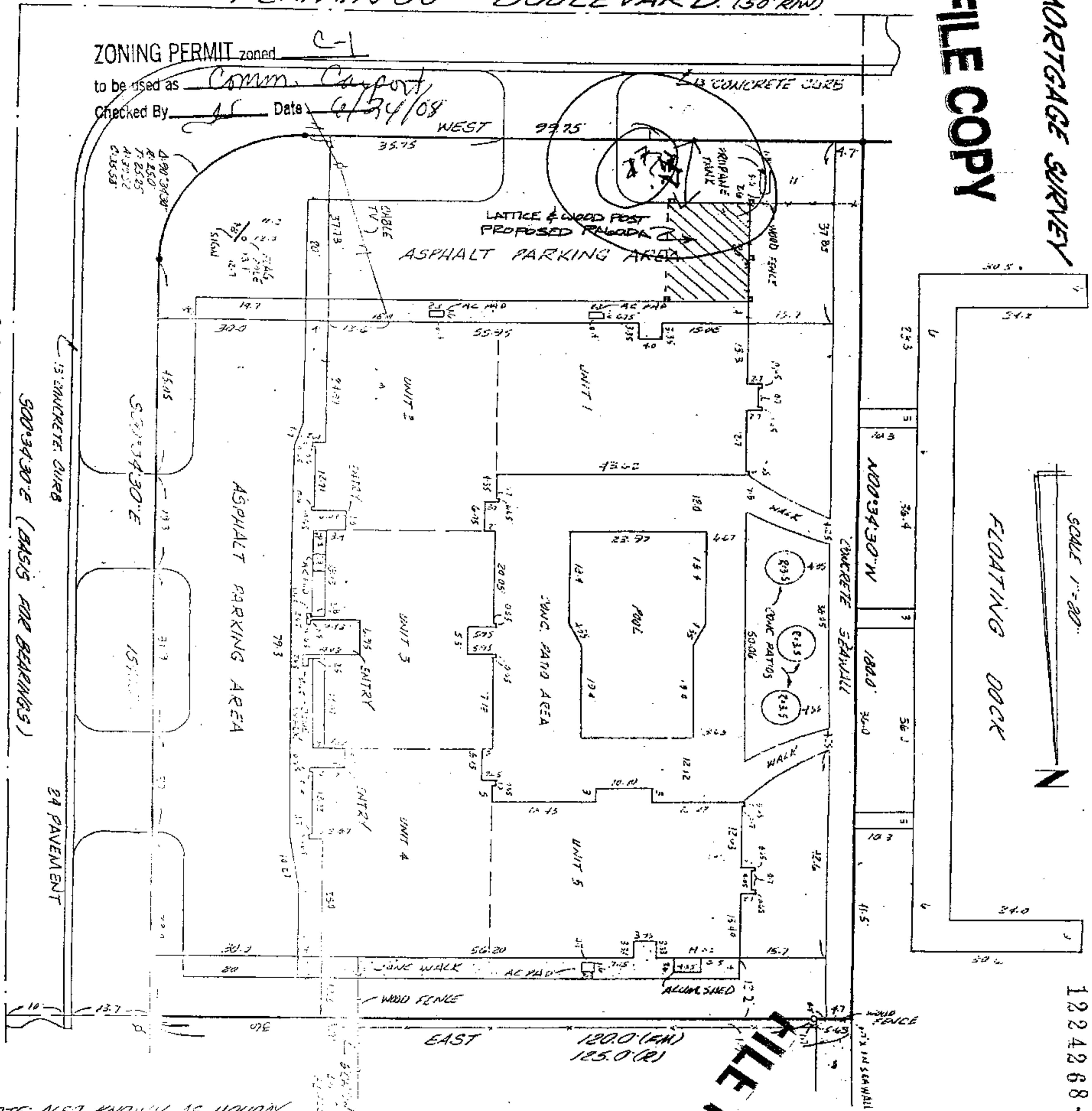

CANAL CALLENTA STREET (PART)
STREET (SIGN) (50' RW)

500'±34'30"±E (BASIS FOR BEARINGS)

15' CONCRETE CURB

24 PAVEMENT

*NOTE: ALSO KNOWN AS HOLIDAY
OUT GARDEN...
AS RECORDED...
OF HERNANDO COUNTY...
PLAT BOOK 17 PAGE 68

*NOTES:

Approved for Use	Not Approved
Comments Attached	
Comments Attached	

Building Plans Review

COFFIN & McLEAN ASSOC., INC.
Professional Land Surveying
3573 Commercial Way
P.O. Box 5145 Suite C
Spring Hill, FL 34606-5145
(904) 683-5993

Party Chief: J. COFFIN Work Order: 82-232
Drawn By: R. SIKES DATE: 12-18-89
Checked By: J. COFFIN Field Book: 29 Page: 57

CERTIFIED TO: PATRICK & FRANCIS BAIRD
FIRST FLORIDA BANK - SOUTHEAST
TITLE INSURANCE COMPANY /
INDUSTRIAL VALLEY TITLE INSURANCE
COMPANY

DESCRIPTION: LOT 14, 15, & 16 BLOCK 23
UNIT 3 GULF COAST RETREATS I
HERNANDO COUNTY PLAT BOOK 17
PAGE 68 PLAT BOOK 17 PAGE 68
SECTION 12 TOWNSHIP 23S RANGE 16E

SW=SOUTHWEST	E=EAST	R/W=RIGHT-OF-WAY	LEGEND	● = FOUND 1/2" IRON ROD NUMBER 100R
SE=SOUTHEAST	N=NORTH	FM=FIELD MEASURED	PP=POWER POLE	○ = SET 1/2" IRON ROD NUMBER 1B 5232
NW=NORTHWEST	S=SOUTH	TV=CABLE TELEVISION BOX	P=RECORD PLAT	▲ = FOUND CONTROL POINT NUMBER
NE=NORTHEAST	W=WEST	R=DEED OR PLAT RECORD	T=TELEPHONE BOX	△ = SET CONTROL POINT NUMBER LS 3882
■ = FOUND	CONCRETE MONUMENT NUMBER	□ = SET 4x4 CONCRETE MONUMENT NUMBER LS 3882		

Surveyor's Note: No visible encroachments except as shown.

CERTIFICATE
I hereby certify that the survey represented hereon meets the requirements of Chapter 21 HH-6, Florida Administrative Code, for professional land surveyors.

James W. Coffin
James W. Coffin
Professional Land Surveyor
Florida Registration # 3882

FLOOD HAZARD ZONE: <u>A-10 2-13</u>	REVISIONS	DATE
COMMUNITY PANEL # <u>2200 B</u>		
DATE REVISED: <u>4-7-84</u>		
BEARING BASIS: <u>RECORD PLAT</u>		
ELEVATIONS SHOWN REFER:		
TO MEAN SEA LEVEL <input type="checkbox"/>		
TO ASSUMED DATUM <input type="checkbox"/>		

NOTE: SUBJECT TO SETBACKS, EASEMENTS AND OTHER RESTRICTIONS OF RECORD

12224268