

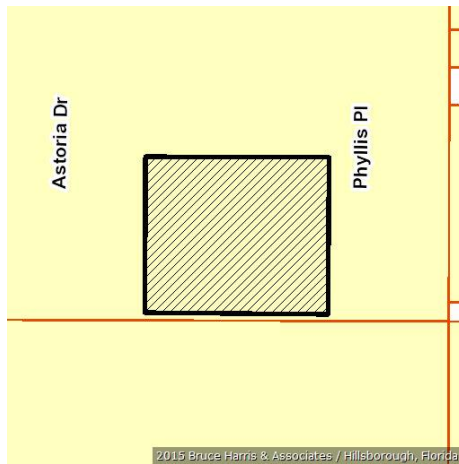

# Bob Henriquez Hillsborough County Property Appraiser

https://www.hcpafil.org/  
15th Floor County Ctr.  
601 E. Kennedy Blvd, Tampa, Florida 33602-4932  
Ph: (813) 272-6100

## Folio: 159644-0000



### Owner Information

<b>Owner Name</b>	INERGY PROPANE LLC
<b>Mailing Address</b>	2 BRUSH CREEK BLVD STE 200 KANSAS CITY, MO 64112-1515
<b>Site Address</b>	2010 PHYLLIS PL, TAMPA
<b>PIN</b>	A-14-29-19-ZZZ-000005-79040.0
<b>Folio</b>	159644-0000
<b>Prior PIN</b>	
<b>Prior Folio</b>	000000-0000
<b>Tax District</b>	TA - TAMPA
<b>Property Use</b>	4900 OPEN STORAGE
<b>Plat Book/Page</b>	/
<b>Neighborhood</b>	418001.00   Grant Park/Orient Area
<b>Subdivision</b>	ZZZ   UNPLATTED

### Value Summary

Taxing District	Market Value	Assessed Value	Exemptions	Taxable Value
County	\$228,661	\$228,661	\$0	\$228,661
Public Schools	\$228,661	\$228,661	\$0	\$228,661
Municipal	\$228,661	\$228,661	\$0	\$228,661
Other Districts	\$228,661	\$228,661	\$0	\$228,661

Note: This section shows Market Value, Assessed Value, Exemptions, and Taxable Value for taxing districts. Because of changes in Florida Law, it is possible to have different assessed and taxable values on the same property. For example, the additional \$25,000 Homestead Exemption and the non-homestead CAP do not apply to public schools, and the Low Income Senior Exemption only applies to countywide and certain municipal millages.

### Sales Information

Book	Page	Month	Year	Type Inst	Qualified or Unqualified	Vacant or Improved	Price
18111	1607	08	2007	WD	Unqualified	Vacant	\$300,000
16217	0103	03	2006	QC	Unqualified	Vacant	\$100
4154	1158	07	1983	WD	Unqualified	Vacant	\$3,000
4138	0734	06	1983	WD	Qualified	Vacant	\$77,000
3174	0859	01	1976		Qualified		\$100

## Extra Features

OB/XF Code	Description	Building	Year On Roll	Length	Width	Units	Value
1000	TANK SMALL PRESSURE	0	2001	0	0	17,131.00	\$45,397
0260	FENCE CL6	0	2001	0	0	600.00	\$4,200
0651	SHED NOT PERMANENTLY AFFIXED	0	2001	30	12	360.00	\$0
1000	TANK SMALL PRESSURE	0	2001	0	0	28,552.00	\$75,663
0060	CONCRETE PAVEMENT	0	2004	0	0	900.00	\$2,780
0520	CANOPY	0	2010	14	10	140.00	\$756

## Land Information - Total Acreage: 1.13

Use Code	Description	Zone	Front	Depth	Land Type	Total Land Units	Land Value
INB0	Ind Class 2	RS-50	0.0	0.0	SF   SQUARE FEET	50,088.00	\$99,865

## Legal Description

**Legal Description** LOT BEG 443 FT S & 265 FT E OF NW COR OF SW 1/4 OF NW 1/4 OF NW 1/4 AND RUN E 239.91 FT S 207.21 FT W 240.17 FT AND N 208.94 FT TO BEG