

DESIGN STATEMENT: THIS STRUCTURE HAS BEEN DESIGNED FOR A DESIGN WIND SPEED OF 120 mph (3 SEC. Gust) IN ACCORDANCE WITH THE 2004 INTERNATIONAL BUILDING CODE. THE DESIGN CRITERIA ARE AS FOLLOWS: 2004 INTERNATIONAL BUILDING CODE. WIND EXPOSURE: B. INTERNAL PRESSURE COEFFICIENT: 0.18. +25 mph / -34 mph (see CLADDING WIND SPEEDS components on floor plan)

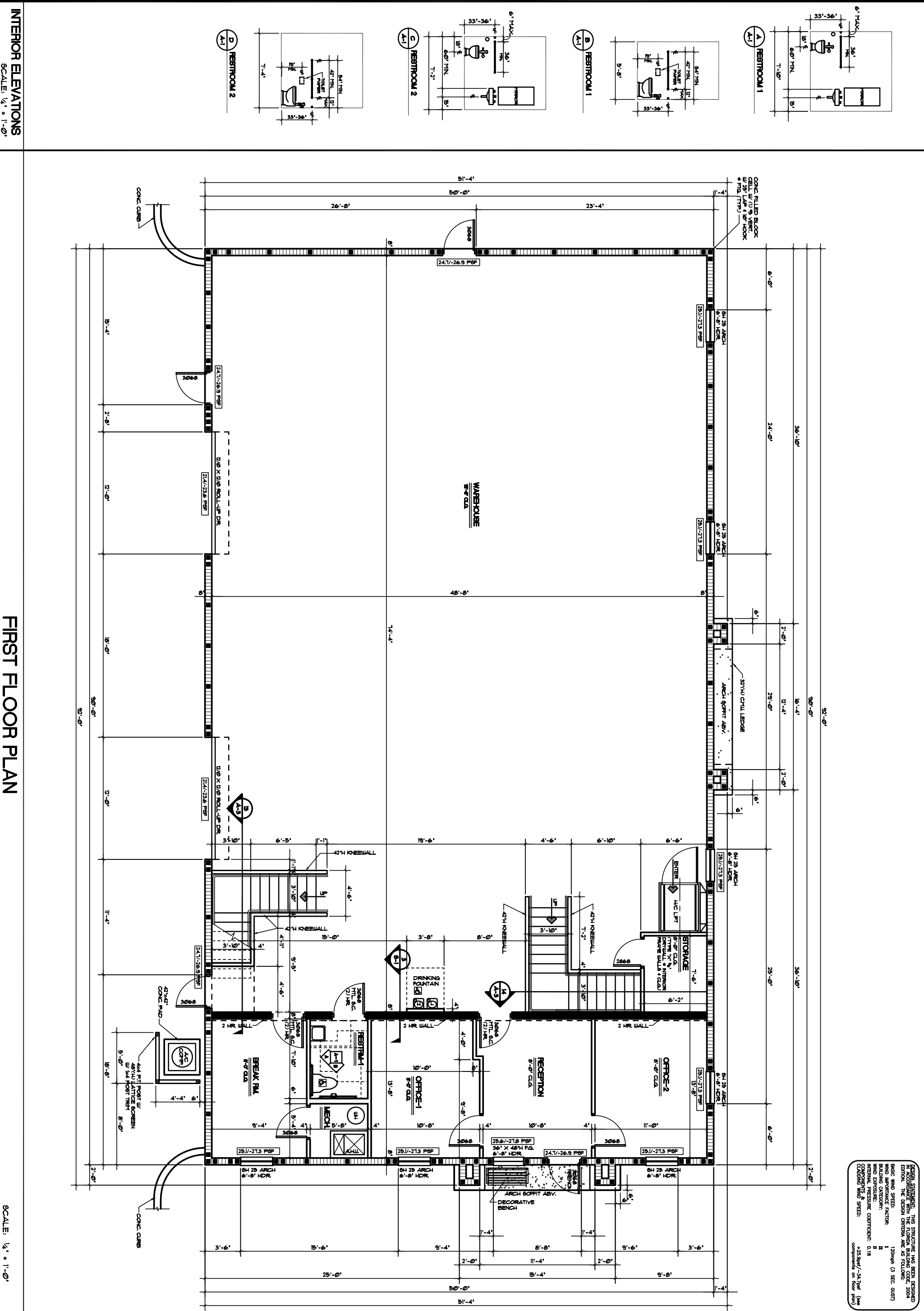

INTERIOR ELEVATIONS
SCALE: 1/4" = 1'-0"

FIRST FLOOR PLAN
SCALE: 1/4" = 1'-0"

SCALE: 1/4" = 1'-0"

<p>DESIGNER HEREBY EXPRESSLY RESERVES HIS COPYRIGHT AND OTHER PROPERTY RIGHTS IN THESE PLANS. THESE PLANS AND DRAWINGS ARE NOT TO BE REPRODUCED, CHANGED OR COPIED IN ANY FORM OR MANNER WHATSOEVER, NOR ARE THEY TO BE ASSIGNED TO ANY PARTY WITHOUT FIRST OBTAINING THE EXPRESSED WRITTEN PERMISSION AND CONSENT OF GERALD R. GROSS, A.I.A.</p>	<p>PROJECT NO.: JFL 05011 DATE: 11/14/17 DRAWN BY: TFL/SJTC TFL/SJTC</p>	<p>FIRST FLOOR PLAN OFFICE/WAREHOUSE BUILDING FOR: POOLS & SCREENS at 890 SHADICK DRIVE</p>	<p>Lot 46 Ver. 5</p>	<p>FIRST COMMERCIAL CONSTRUCTION LLC</p>	<p>gerald gross architect 205 East First Street Sanford, Florida 32771 407 256 7118 FL REG. ARCHITECT NO. 6808</p>	<p>REVISIONS 5/11/2016 PLAN REVIEW</p>
---	--	---	--------------------------	---	---	--