

# Kissimmee Commons Retail

4340-4386 W Vine St. Kissimmee, FL 34746

**Palkiper**  
Commercial Real Estate Services  
Licensed Real Estate Broker



**T-Mobile**  
**GameStop**  
CHINA BELL NAILS & SPA  
TAQUERIA CASAS



**FedEx Office** AMERICA'S PHARMACY  
**cricket** M&J BARBERSHOP  
Adult Daycare & Activity Center

## LOCATION HIGHLIGHTS

Situated next to Walmart Supercenter at the lighted intersection of US-192 (67,390+ AADT) and N Bass Rd. The area offers a variety of dining, shopping, and entertainment options, including the 192 Flea Market, Shingle Creek Regional Park, Medieval Times Dinner & Tournament, and Plaza Del Sol. Nearby eateries include Chick-Fil-A, Dunkin', Steak 'n Shake, Wawa, and more. It also provides quick access to major routes, with John Young Pkwy less than 3 miles away and SR-417 and I-4 less than 6 miles away.

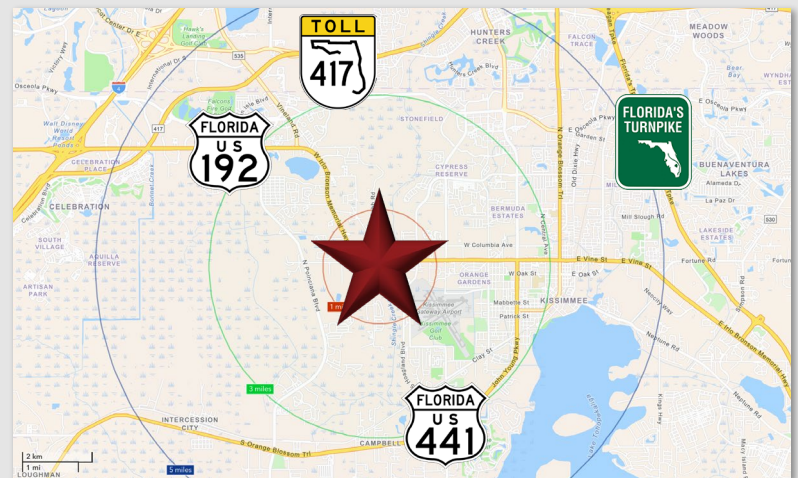

## LISTING HIGHLIGHTS

- Two **end-cap** retail spaces available:
  - Ste 4340 | **4,250 SF** | **\$28 NNN**
  - Ste 4386 | **2,890 SF** | **\$26 NNN**
- Located in a 30,000+ SF Neighborhood Shopping Center. **Existing tenants** include FedEx, T-Mobile, Chipotle, Marco's Pizza, and GameStop
- **Ample shared parking** (180 spaces) with easy access from Walmart
- Signage facing US-192 for **maximum visibility**

2025 DEMOGRAPHICS	1-MILE	3-MILE	5-MILE
Population	8,225	79,888	162,829
Median HH Income	\$74,251	\$61,222	\$68,724
Average HH Income	\$94,383	\$79,813	\$88,476

CONTACT FOR MORE INFORMATION

**Marie Shorey, CCIM**  
(407) 383-8142  
Marie@palkiper.com

# Kissimmee Commons Retail

4340-4386 W Vine St. Kissimmee, FL 34746

 **Palkiper**  
Commercial Real Estate Services  
Licensed Real Estate Broker

4340 W Vine St



## SUITE 4340 HIGHLIGHTS

- **±4,250 SF end-cap** retail space available
- Lease Rate: **\$28psf NNN**
- Previously used as a daycare center
- **Flexible uses permitted** for a variety of retail and service tenants
- Storefront and monument signage on US-192

CONTACT FOR MORE INFORMATION

**Marie Shorey, CCIM**

(407) 383-8142

[Marie@palkiper.com](mailto:Marie@palkiper.com)

# Kissimmee Commons Retail

4340-4386 W Vine St. Kissimmee, FL 34746

**4386 W Vine St**

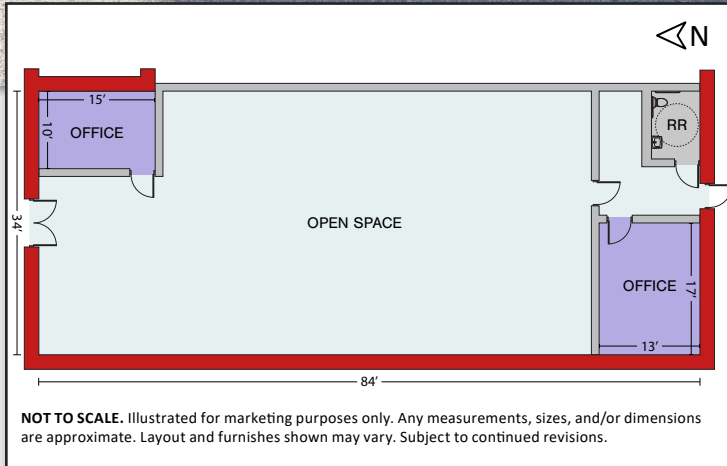

## SUITE 4386 HIGHLIGHTS

- **±2,890 SF end-cap** retail space available
- Lease Rate: **\$26psf NNN**
- Mostly open layout with small office, back room, and private restroom
- **Flexible uses permitted** for a variety of retail and service tenants
- Storefront and monument signage on US-192

CONTACT FOR MORE INFORMATION

**Marie Shorey, CCIM**  
(407) 383-8142  
[Marie@palkiper.com](mailto:Marie@palkiper.com)