

# I-4 NORTH

SANFORD, FLORIDA



**205-207 AERO LANE | SANFORD, FL**

± 34,856 SF AVAILABLE FOR LEASE



ALPHA  
INDUSTRIAL  
PROPERTIES

FOUNDRY  
COMMERCIAL

# I-4 NORTH LOCATION

# I-4 NORTH

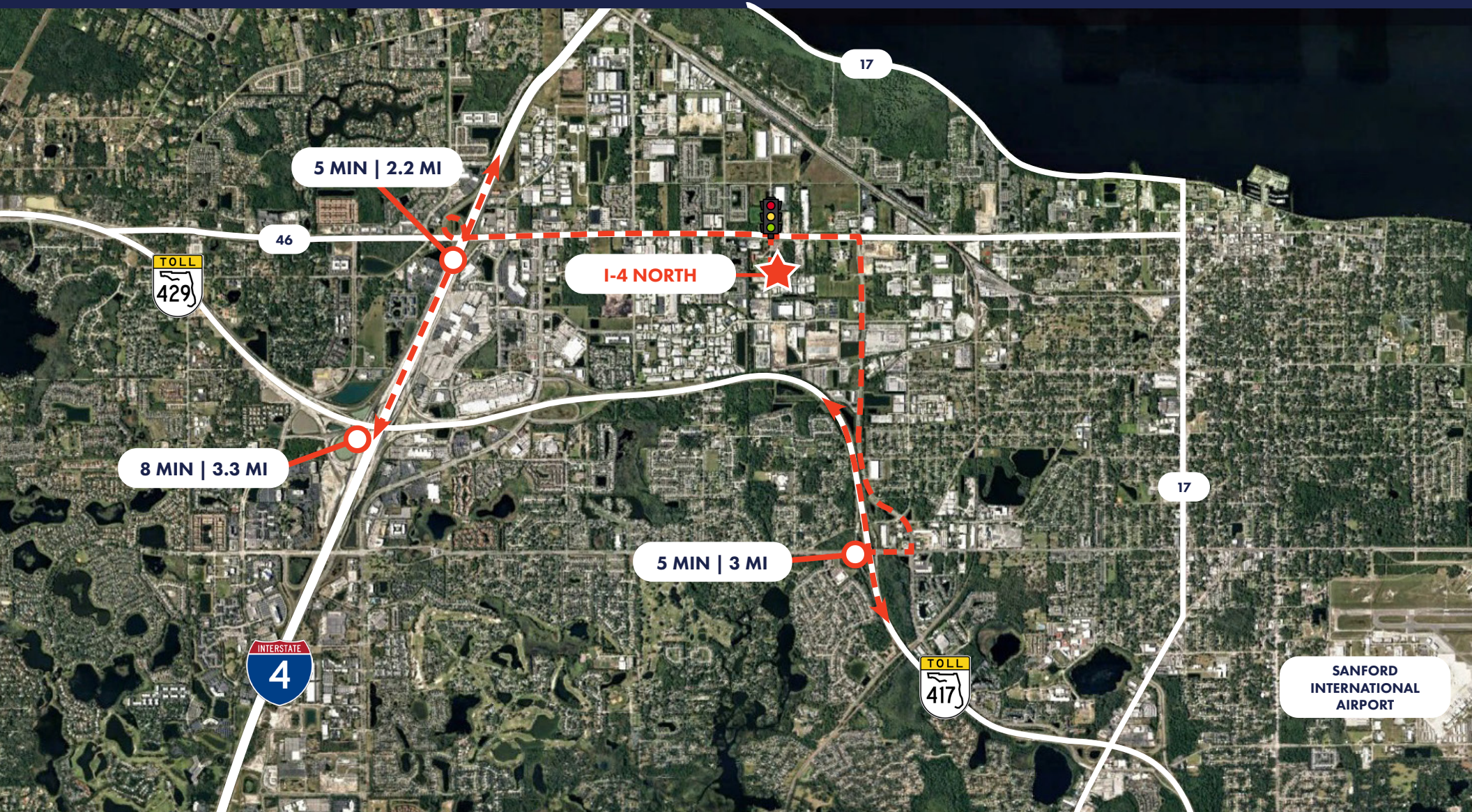

205-207 AERO LANE | SANFORD, FL



# I-4 NORTH PROPERTY DETAILS

# I-4 NORTH

	<b>BUILDING B</b>
<b>TOTAL SF</b>	69,953 SF
<b>BUILDING TYPE</b>	Rear
<b>RAMPS</b>	2 (12 x 14)
<b>CLEAR</b>	32'
<b>DOCK DOORS</b>	18
<b>PIT LEVELERS</b>	4
<b>HVLS FANS</b>	2
<b>CAR PARKING</b>	1/1,000
<b>TRUCK COURT</b>	Shared 180'
<b>ACCESS</b>	Two access points on Aero Lane and full building circulation
<b>BUILDING FEATURES</b>	Extension wings 210' depth, building typical depth 150'



**BUILDING B**  
**AVAILABILITY**

**I-4**  
**NORTH**

**BUILDING B**

**AVAILABILITY**

AVAILABLE SF	34,856 SF
OFFICE SF	2,788 SF
DOCK DOORS	9 (9' x 10')
RAMP DOORS	1 (12' x 14')
PIT LEVELERS	2
POWER	400 amp/3-phase
HVLS FANS	1

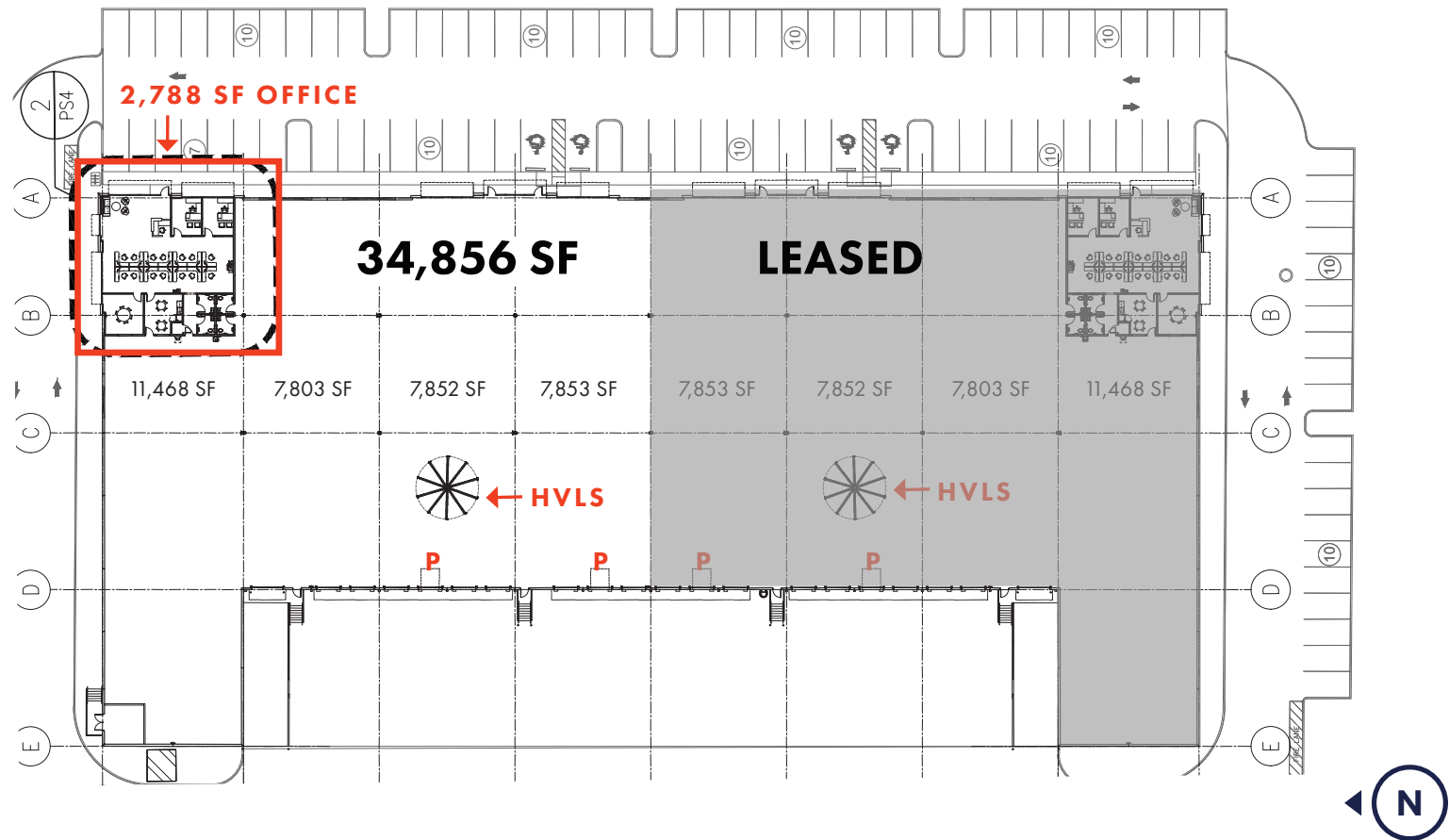

SPEC OFFICE PLAN  
2,788 SF

# I-4 NORTH

## OFFICE

2,788 SF

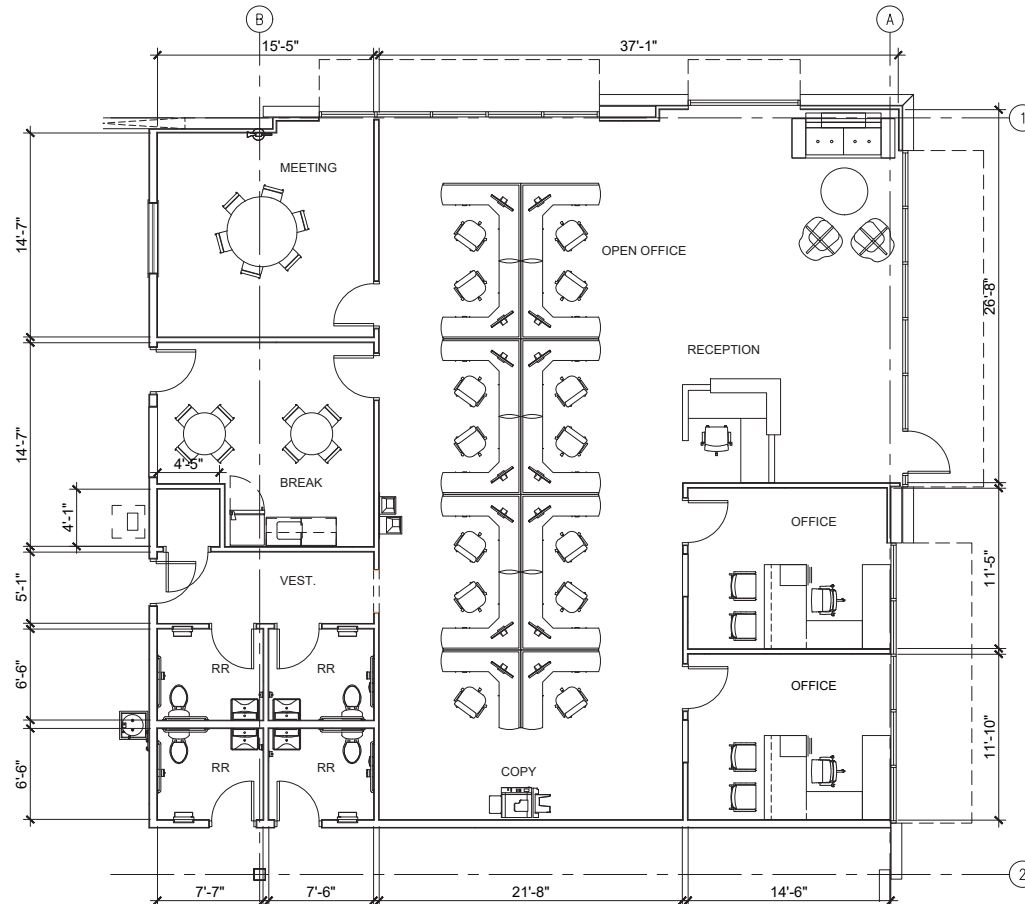





**FOR MORE INFORMATION:**

JUSTIN RUBY, SIOR, CCIM  
[justin.ruby@foundrycommercial.com](mailto:justin.ruby@foundrycommercial.com)  
407.865.0311

JOEY WOODMAN, SIOR  
[joey.woodman@foundrycommercial.com](mailto:joey.woodman@foundrycommercial.com)  
407.748.5888

TRAVIS HAMMOND  
[travis.hammond@foundrycommercial.com](mailto:travis.hammond@foundrycommercial.com)  
407.401.1707

**FOUNDRY**  
COMMERCIAL