

SUNPORT COMMERCE CENTER III

404 SUNPORT LANE, ORLANDO, FL 32809



CONVENIENT ACCESS
TO SR 528 AND FLORIDA'S TURNPIKE

10,950 SF AVAILABLE
SUITE 550

SPACE HIGHLIGHTS

ASKING RATE

\$16.00/SF NNN

OPEX*

\$3.07 PSF

MONTHLY RATE

\$17,401.37

WAREHOUSE SIZE

5,248 SF

OFFICE SIZE

5,702 SF

CLEAR HEIGHT

24'

FIRE SUPPRESSION

CLASS IV

ZONING

IND-4

PARKING RATIO

2.00/1,000

LOADING DOORS

(3) DOCK DOORS
(1) RAMP

YEAR BUILT

2004

AVAILABILITY

SEPTEMBER 2026

**Denotes Estimated Operating Expenses for 2026*

CONTACT INFORMATION

TAYLOR ZAMBITO

Senior Director
+1 407 541 4409
taylor.zambito@cushwake.com

RYAN HUBBARD

Director
+1 407 541 4390
ryan.hubbard@cushwake.com



FLOOR PLAN

SUITE 550

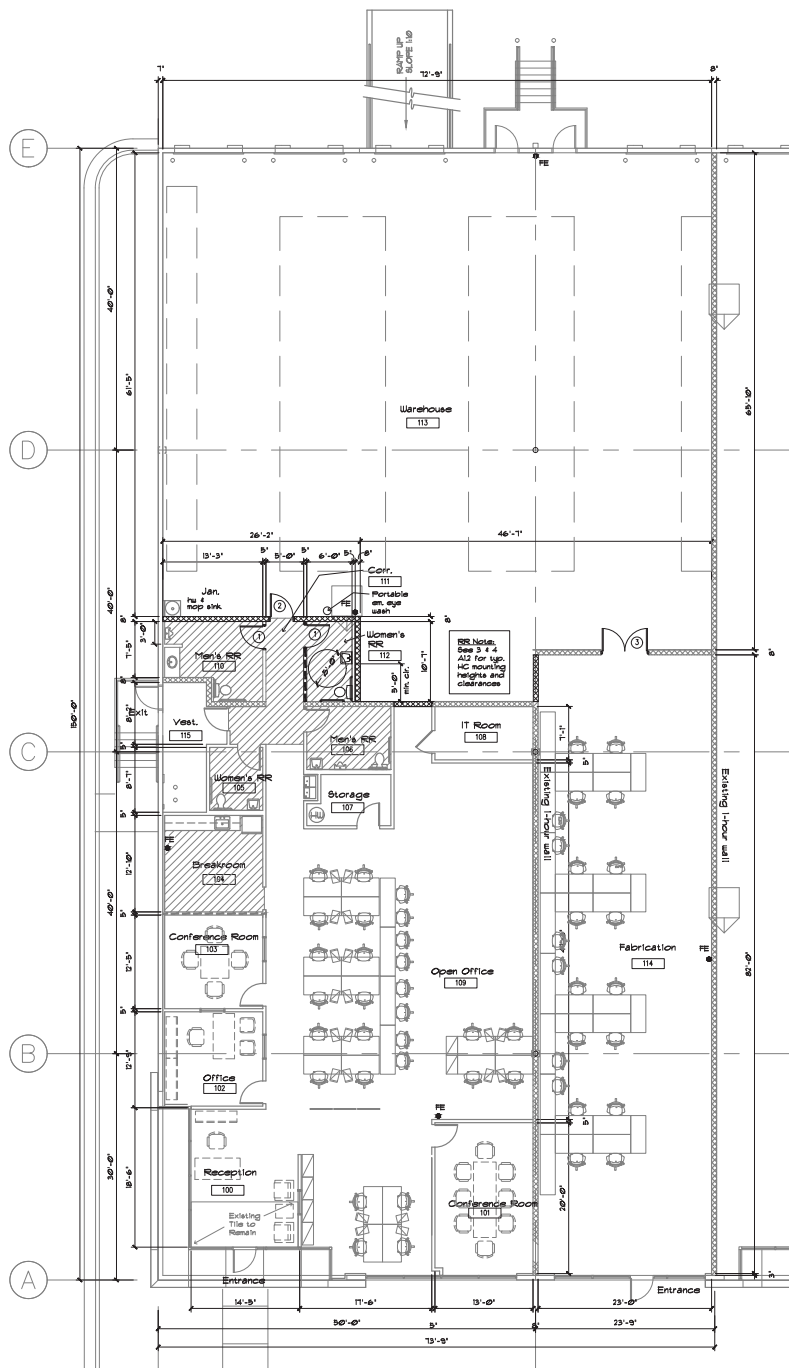

CONTACT INFORMATION

TAYLOR ZAMBITO
Senior Director
+1 407 541 4409
taylor.zambito@cushwake.com

RYAN HUBBARD
Director
+1 407 541 4390
ryan.hubbard@cushwake.com

