

1468 N GOLDENROD ROAD | ORLANDO, FL 32807

FOR LEASE



LISTING DATA

Available SF: 4,412 SF
Clear Height: 17.5' - 20.5'
Zoning: IND-1/IND-5 (Orange County)
Loading: Front
Parking Ratio: 2.3/1,000 SF

Comments: Goldenrod Business Center is comprised of 3 Industrial/Flex buildings totaling 78,736 SF located in east central Orlando with convenient access to SR-50, SR-408, and SR-417. The project is professionally owned and managed making it an ideal location for years to come.

ECONOMIC DATA

Lease Rate: Call For Info

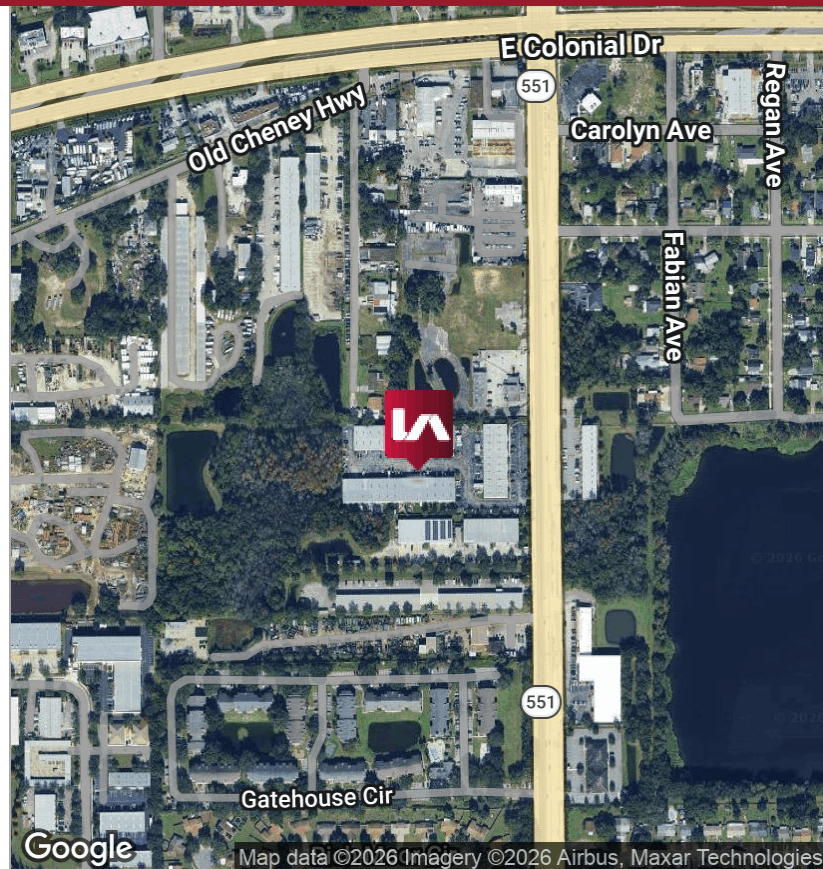



LEASE INFORMATION

Lease Type: NNN Lease Term: Negotiable
 Total Space: 4,412 SF Lease Rate: Call For Info

AVAILABLE SPACES

SUITE	TENANT	SIZE (SF)	LEASE TYPE	LEASE RATE	DESCRIPTION
Suite 235	Available	4,412 SF	NNN	Call For Info	288 SF office, three (3) 12' x 14' grade level roll up door, 2,480 SF of rear outside storage.

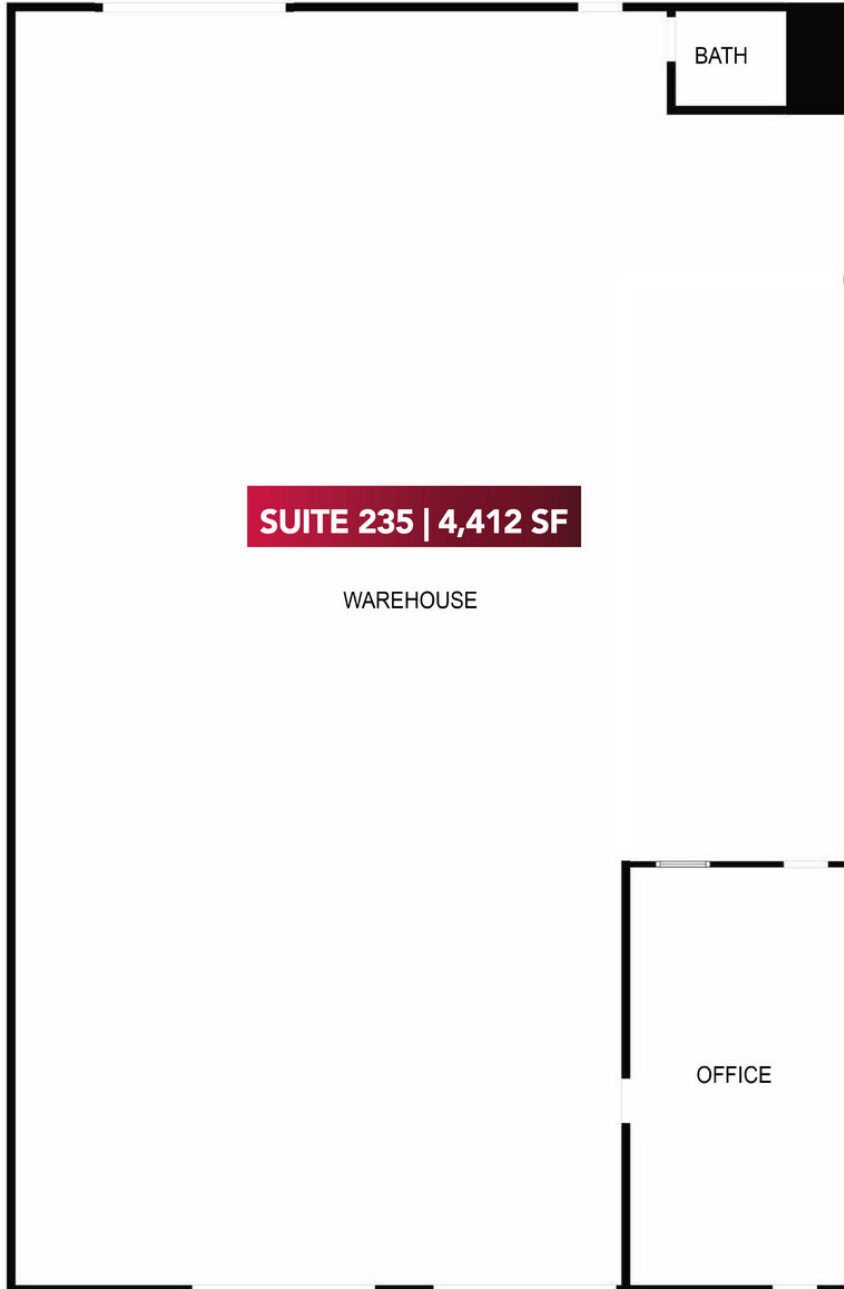

SUITES 235 | 4,412 SF