

FOR LEASE  
2011-2015 VISCOUNT ROW  
ORLANDO, FL 32809



AVAILABLE NOW

## PROPERTY HIGHLIGHTS

**SF Available:** Suite 2011 | 15,543  
Suite 2015 | 15,681

**Clear Height:** 20'

**Building Depth:** 150'

**Fire Sprinklers:** Wet System

**Rate:** \$12.00/SF NNN

**Opex:** \$2.70/SF

### Listing Contact:

Derek Riggelman, SIOR  
Senior Vice President | Principal  
driggelman@lee-associates.com  
D 321.281.8507

Aaron Torres  
Associate  
atorres@lee-associates.com  
D 321.281.8519

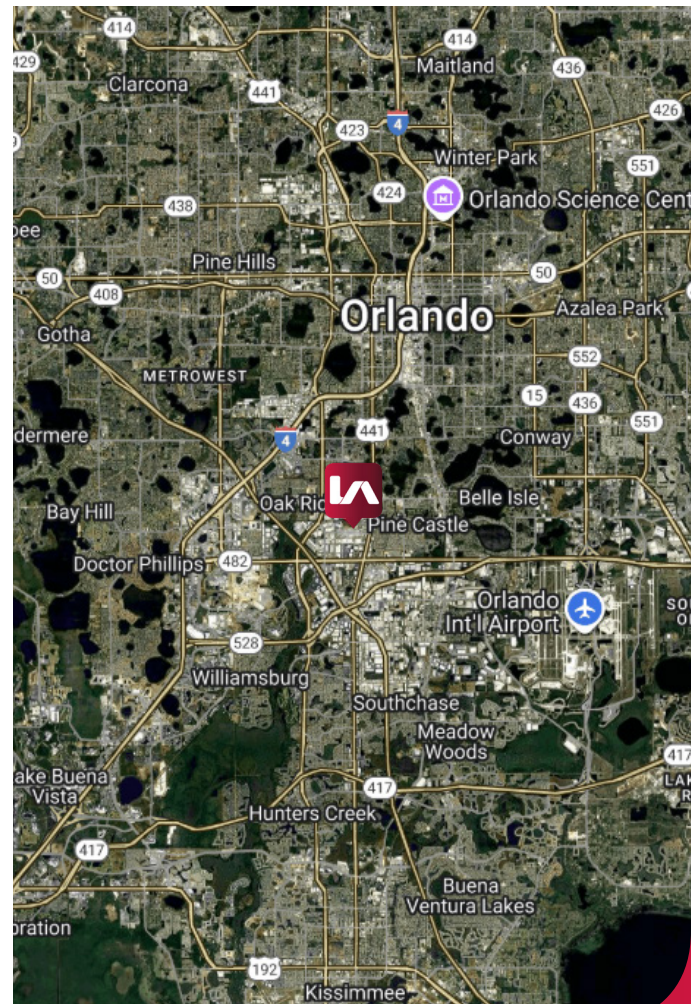

**SUITE 2011**

TOTAL: 15,543 SF

OFFICE: 936 SF

WAREHOUSE: 14,607 SF

LOADING: 3 Dock High Doors (10' x 10') 1 Ramped Door

POWER: 3 Phase (400 Amps 3 Phase at 480v, 100 Amps at 277/480 V)

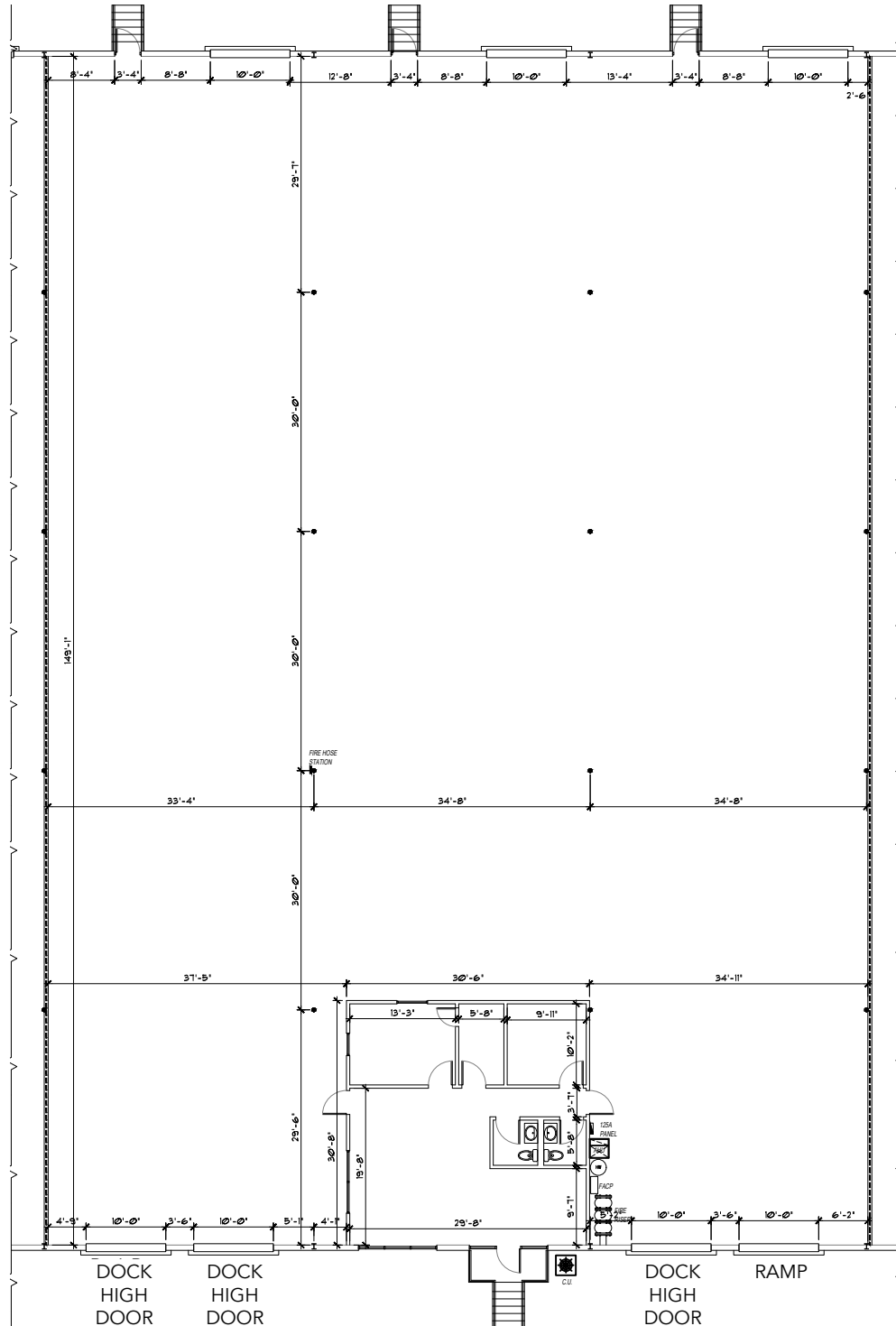

All information furnished regarding property for sale, rental or financing is from sources deemed reliable, but no warranty or representation is made to the accuracy thereof and same is submitted to errors, omissions, change of price, rental or other conditions prior to sale, lease or financing or withdrawal without notice. No liability of any kind is to be imposed on the broker herein.



PROPERTY PHOTOS



All information furnished regarding property for sale, rental or financing is from sources deemed reliable, but no warranty or representation is made to the accuracy thereof and same is submitted to errors, omissions, change of price, rental or other conditions prior to sale, lease or financing or withdrawal without notice. No liability of any kind is to be imposed on the broker herein.