

# Retail/Flex in Port Charlotte

# FOR LEASE

17218 TOLEDO BLADE BLVD, PORT CHARLOTTE, FL 33954

275' Frontage



## PROPERTY FEATURES

- Unit 1 - 500/SF Office/Retail
- Unit 10 - 1,000/SF Flex/Office/Retail
- Unit 12 - 500/SF Office/Retail
- Warehouse Unit - 800/SF Storage
- \$18/SF NNN
- Large Pylon Sign
- Easy Ingress/Egress
- Great Visibility



## PROPERTY FEATURES

Located at 17218 Toledo Blade Blvd, Port Charlotte, FL, 33954, this exceptional property boasts prime commercial space for lease. With its classic design, ample parking, and high-visibility location, this property offers endless opportunities for a wide range of businesses. Its proximity to major thoroughfares ensures easy accessibility for both customers and employees. This is the perfect opportunity to establish or expand your business in a dynamic and thriving area. Renting for \$18/SF NNN



Google

Imagery ©2026 Airbus, Maxar Technologies

**Theresa Blanch-Mitchell, CCIM**

1922 VICTORIA AVE STE C FT MYERS, FL 33901

239.265.2628

theresa@ccim.net

FL #BK3202944



[www.SperryCGA.com](http://www.SperryCGA.com)

Each office independently owned and operated.

We obtained the information above from sources we believe to be reliable. However, we have not verified its accuracy and make no guarantee, warranty or representation about it. It is submitted subject to the possibility of errors, omissions, change of price, rental or other conditions, prior sale, lease or financing, or withdrawal without notice. We include projections, opinions, assumptions or estimates for example only, and they may not represent current or future performance of the property. You and your tax and legal advisors should conduct your own investigation of the property and transaction.

# Port Charlotte Retail **FOR LEASE**

17218 TOLEDO BLADE BLVD, PORT CHARLOTTE, FL 33954

Retail Property

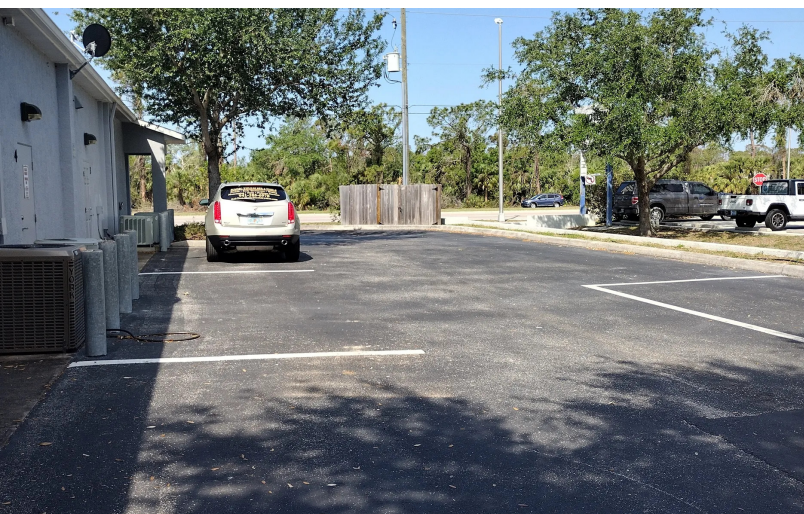

**Theresa Blanch-Mitchell, CCIM**  
1922 VICTORIA AVE STE C FT MYERS, FL 33901  
239.265.2628  
theresa@ccim.net  
FL #BK3202944



[www.SperryCGA.com](http://www.SperryCGA.com)

Each office independently owned and operated.

We obtained the information above from sources we believe to be reliable. However, we have not verified its accuracy and make no guarantee, warranty or representation about it. It is submitted subject to the possibility of errors, omissions, change of price, rental or other conditions, prior sale, lease or financing, or withdrawal without notice. We include projections, opinions, assumptions or estimates for example only, and they may not represent current or future performance of the property. You and your tax and legal advisors should conduct your own investigation of the property and transaction.

# Port Charlotte Retail **FOR LEASE**

17218 TOLEDO BLADE BLVD, PORT CHARLOTTE, FL 33954

Retail Property

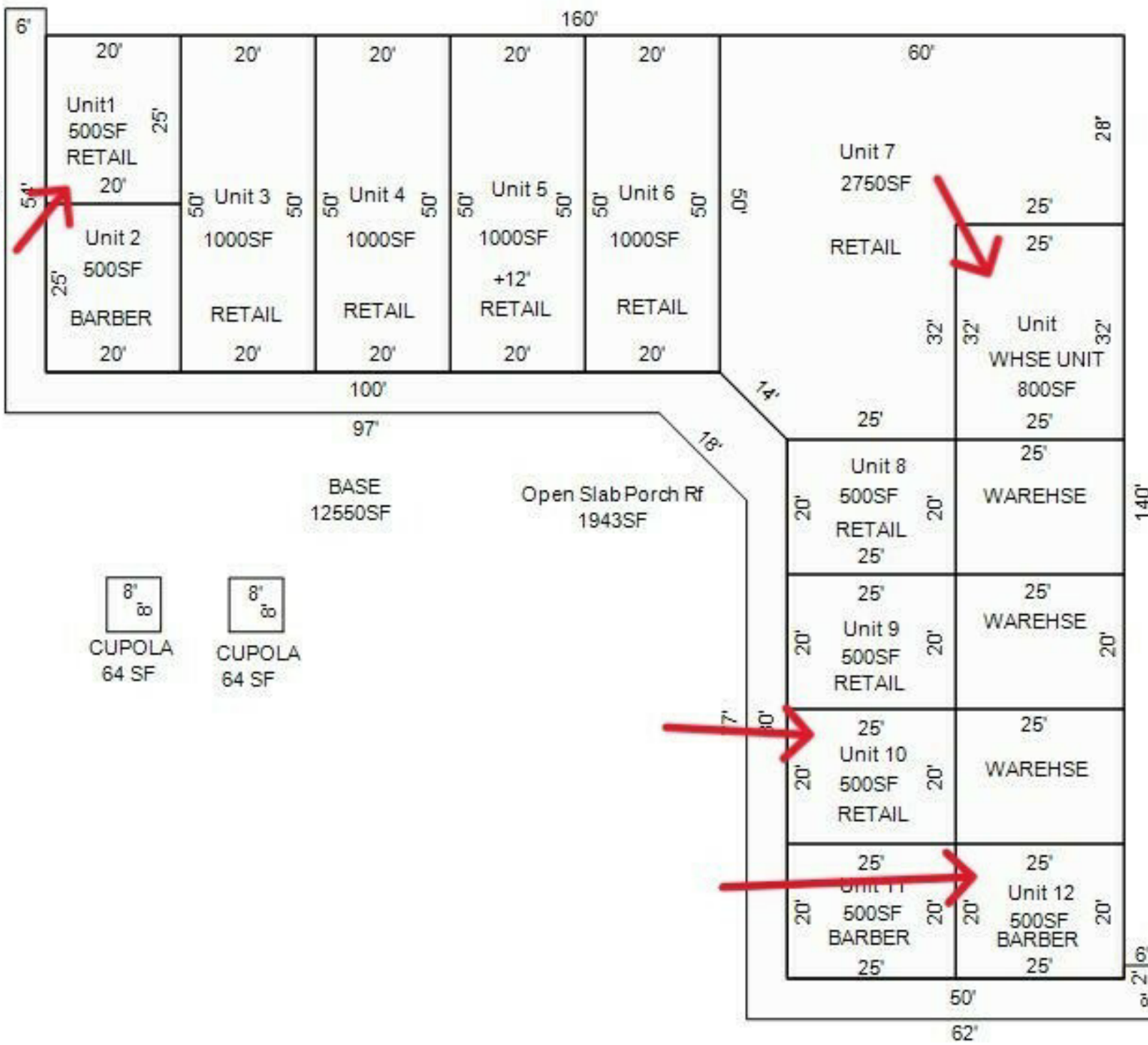

**Theresa Blanch-Mitchell, CCIM**  
 1922 VICTORIA AVE STE C FT MYERS, FL 33901  
 239.265.2628  
 theresa@ccim.net  
 FL #BK3202944



Each office independently owned and operated.

We obtained the information above from sources we believe to be reliable. However, we have not verified its accuracy and make no guarantee, warranty or representation about it. It is submitted subject to the possibility of errors, omissions, change of price, rental or other conditions, prior sale, lease or financing, or withdrawal without notice. We include projections, opinions, assumptions or estimates for example only, and they may not represent current or future performance of the property. You and your tax and legal advisors should conduct your own investigation of the property and transaction.