

# Leesburg Flex Space

3384 W Main St. Leesburg, FL 34748

**Palkiper**  
Commercial Real Estate Services  
Licensed Real Estate Broker



**For Sale: \$295,000/unit**

## LOCATION HIGHLIGHTS

Located on SR-44 with traffic count of 25,000 cars per day. Adjacent to Dollar General with new Wawa and Circle K nearby. Less than 3 miles from US-27/US-441 and only 10 minutes from national and local restaurants and retailers along US-441.

## LISTING HIGHLIGHTS

- **±1,250 SF** flex space condos available for sale
- Facility is **accessible 24/7**
- Standard unit features:
  - **20' high ceilings**
  - **14' high roll-up door** & separate entry door
  - **3-phase power** 100 Amp service
  - **Climate control**, high-bay LED lighting, private bathroom, fire sprinklers, and more
- **Custom options also available**
- 2 Assigned parking spaces + overflow parking
- **Owner financing available**

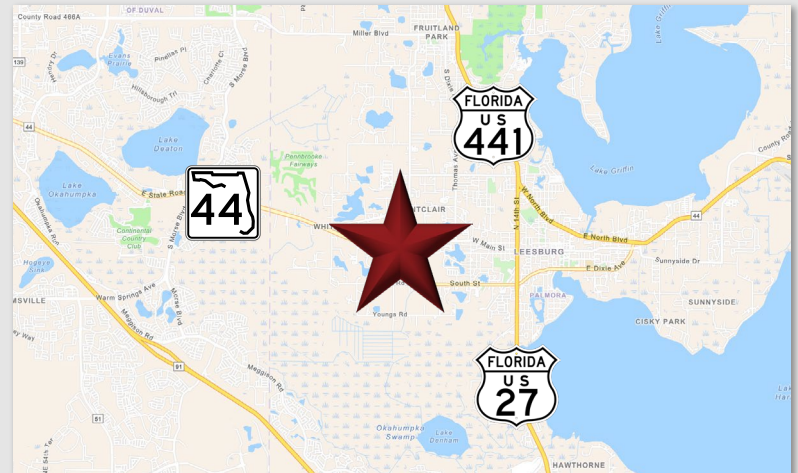

2025 DEMOGRAPHICS	1-MILE	3-MILE	5-MILE
Population	3,064	25,991	71,306
Median HH Income	\$43,320	\$47,107	\$60,076
Average HH Income	\$62,675	\$67,667	\$82,370

CONTACT FOR MORE INFORMATION

**Marie Shorey, CCIM**  
(407) 383-8142  
[Marie@palkiper.com](mailto:Marie@palkiper.com)

# Leesburg Flex Space

3384 W Main St. Leesburg, FL 34748

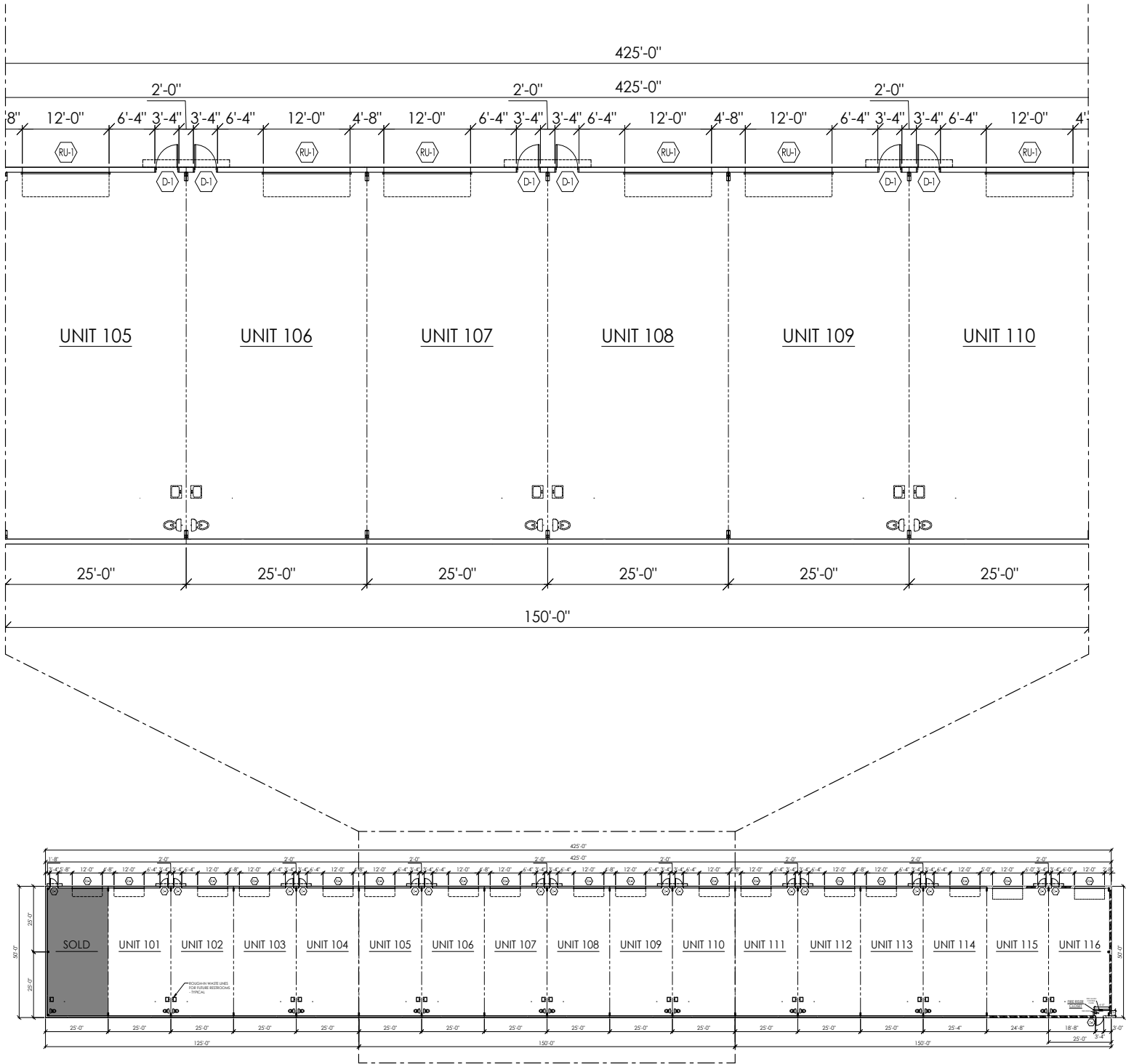

**OVERALL FLOOR PLAN**  
SCALE: 1/16" = 1'-0"

CONTACT FOR MORE INFORMATION

**Marie Shorey, CCIM**

(407) 383-8142

Marie@palkiper.com

# Leesburg Flex Space

3384 W Main St. Leesburg, FL 34748

 **Palkiper**  
Commercial Real Estate Services  
Licensed Real Estate Broker



## BUILD-OUT DETAILS

### Unit Features (Included)

- ±1,250 SF flex space condos (25' wide × 50' deep)
- 20' high ceilings
- 14' high roll-up door plus separate man-door entry
- Climate control available
- Private ADA-compliant restroom
- Individually metered water and electric
- 3-phase power with 100 Amp service
- High-bay LED lighting throughout
- Fire suppression sprinkler system
- Rockwool sound-insulated demising walls for enhanced noise control
- Individual hose bib for convenient wash-down

### Property & Site Features (Included)

- Two dedicated parking spaces per unit
- Property-wide security cameras with owner access
- Oversized drive aisles for RV & large vehicle access
- On-site RV dump station with paved access

### Available Customizations (Optional)

- HVAC system
- Ground floor office space
- Mezzanine with office or restroom
- Additional bathroom with shower
- Bar setup
- Cleanout option by downstairs restroom or a shared tank system to be pumped as needed

CONTACT FOR MORE INFORMATION

**Marie Shorey, CCIM**

(407) 383-8142

[Marie@palkiper.com](mailto:Marie@palkiper.com)

# Leesburg Flex Space

3384 W Main St. Leesburg, FL 34748

 **Palkiper**  
Commercial Real Estate Services  
*Licensed Real Estate Broker*



CONTACT FOR MORE INFORMATION

**Marie Shorey, CCIM**

(407) 383-8142

[Marie@palkiper.com](mailto:Marie@palkiper.com)

Palkiper has made every effort to obtain the information regarding this property from sources deemed reliable. However, we cannot warrant the complete accuracy thereof subject to errors, omissions, change of price, rental, or other conditions, prior sale, lease or financing or withdrawal without notice.  
Licensed Real Estate Broker.

05/28/26 10:56

# Leesburg Flex Space

3384 W Main St. Leesburg, FL 34748

 **Palkiper**  
Commercial Real Estate Services  
Licensed Real Estate Broker



CONTACT FOR MORE INFORMATION

**Marie Shorey, CCIM**

(407) 383-8142

*Marie@palkiper.com*

Palkiper has made every effort to obtain the information regarding this property from sources deemed reliable. However, we cannot warrant the complete accuracy thereof subject to errors, omissions, change of price, rental, or other conditions, prior sale, lease or financing or withdrawal without notice.  
Licensed Real Estate Broker.

05/28/26 10:56

## Owner Financing Scenario

<b>Purchase Price:</b>	\$295,000
<b>Down Payment:</b>	\$40,000
<b>Owner Financing:</b>	\$255,000
<b>Interest Rate:</b>	5%
<b>Amortization / Term:</b>	30 yrs
<b>Balloon Payment:</b>	End of Year 2
<b>Monthly Payment:</b>	≈ <b>\$1,369</b> (Principal & Interest)
<b>After 2 Years:</b>	
	Total Paid: ≈ <b>\$32,856</b>
	Principal Paid Down: ≈ <b>\$7,700</b>
	Remaining Balance: ≈ <b>\$247,300</b>
	Refinance or pay off in cash
<b>Estimated CAM / Condo Fees:</b>	\$185 / mo

CONTACT FOR MORE INFORMATION

**Marie Shorey, CCIM**

(407) 383-8142

*Marie@palkiper.com*