

Retail/Flex in Port Charlotte

FOR LEASE

17218 TOLEDO BLADE BLVD, PORT CHARLOTTE, FL 33954

275' Frontage



PROPERTY FEATURES

- Unit 1 - 500/SF Office/Retail
- Unit 4 - 1,000/SF Office/Retail
- Unit 12 - 500/SF Office/Retail
- Warehouse Unit - 800/SF Storage
- \$18/SF NNN
- Large Pylon Sign
- Easy Ingress/Egress
- Great Visibility



PROPERTY FEATURES

Located at 17218 Toledo Blade Blvd, Port Charlotte, FL, 33954, this exceptional property boasts prime commercial space for lease. With its classic design, ample parking, and high-visibility location, this property offers endless opportunities for a wide range of businesses. Its proximity to major thoroughfares ensures easy accessibility for both customers and employees. This is the perfect opportunity to establish or expand your business in a dynamic and thriving area. Renting for \$18/SF NNN



Google

Imagery ©2026 Airbus, Maxar Technologies



Theresa Blanch-Mitchell, CCIM
1922 VICTORIA AVE STE C FT MYERS, FL 33901
239.265.2628
theresa@ccim.net
FL #BK3202944

Each office independently owned and operated.

We obtained the information above from sources we believe to be reliable. However, we have not verified its accuracy and make no guarantee, warranty or representation about it. It is submitted subject to the possibility of errors, omissions, change of price, rental or other conditions, prior sale, lease or financing, or withdrawal without notice. We include projections, opinions, assumptions or estimates for example only, and they may not represent current or future performance of the property. You and your tax and legal advisors should conduct your own investigation of the property and transaction.

www.SperryCGA.com

Port Charlotte Retail **FOR LEASE**

17218 TOLEDO BLADE BLVD, PORT CHARLOTTE, FL 33954

Retail Property



Theresa Blanch-Mitchell, CCIM
1922 VICTORIA AVE STE C FT MYERS, FL 33901
239.265.2628
theresa@ccim.net
FL #BK3202944

Each office independently owned and operated.

We obtained the information above from sources we believe to be reliable. However, we have not verified its accuracy and make no guarantee, warranty or representation about it. It is submitted subject to the possibility of errors, omissions, change of price, rental or other conditions, prior sale, lease or financing, or withdrawal without notice. We include projections, opinions, assumptions or estimates for example only, and they may not represent current or future performance of the property. You and your tax and legal advisors should conduct your own investigation of the property and transaction.

www.SperryCGA.com

Port Charlotte Retail **FOR LEASE**

17218 TOLEDO BLADE BLVD, PORT CHARLOTTE, FL 33954

Retail Property

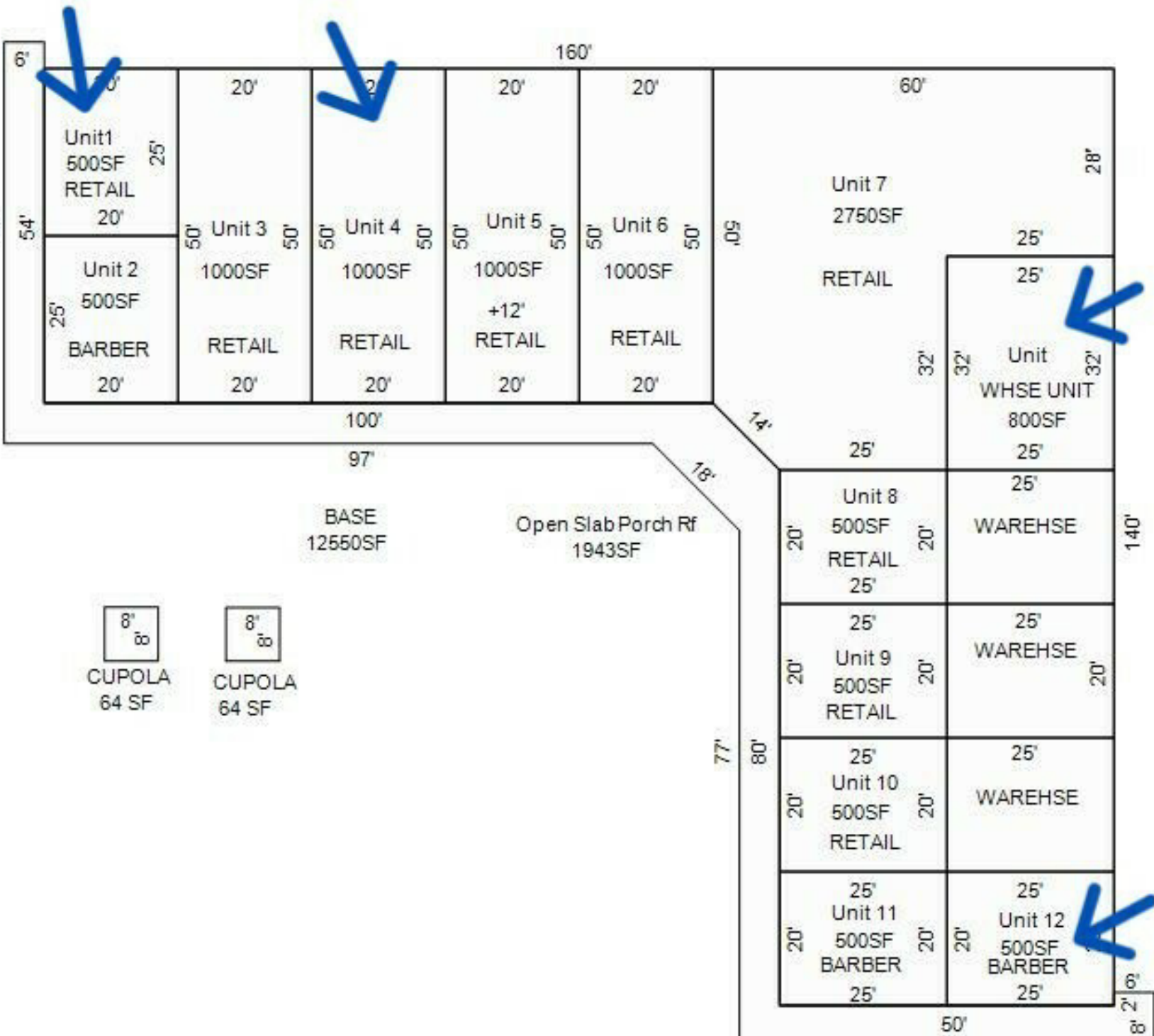

Theresa Blanch-Mitchell, CCIM
 1922 VICTORIA AVE STE C FT MYERS, FL 33901
 239.265.2628
 theresa@ccim.net
 FL #BK3202944

Each office independently owned and operated.

We obtained the information above from sources we believe to be reliable. However, we have not verified its accuracy and make no guarantee, warranty or representation about it. It is submitted subject to the possibility of errors, omissions, change of price, rental or other conditions, prior sale, lease or financing, or withdrawal without notice. We include projections, opinions, assumptions or estimates for example only, and they may not represent current or future performance of the property. You and your tax and legal advisors should conduct your own investigation of the property and transaction.