

**35,000 SF  
AVAILABLE**



**UNIQUE  
FURNITURE**

**MARDEL**



Landers Rd



**FOR LEASE**

**35,000 SF  
5430 LANDERS RD**



# Highlights

- Situated in the Little Rock suburb of Sherwood/North Little Rock, AR
- 21' Clear Height
- Great access with visibility to Highway 67/167
- Daily traffic count of 87,000 autos



## Demographics

### Estimated Population

2-miles	5-miles	10-miles
<b>17,343</b>	<b>92,112</b>	<b>225,145</b>

### Number of Households

2-miles	5-miles	10-miles
<b>7,618</b>	<b>40,268</b>	<b>98,699</b>

### Daytime Employees

2-miles	5-miles	10-miles
<b>17,296</b>	<b>49,432</b>	<b>203,648</b>

### Average Household Income

2-miles	5-miles	10-miles
<b>\$87,403</b>	<b>\$71,763</b>	<b>\$71,762</b>

# Site Plan - 5430 Landers Rd

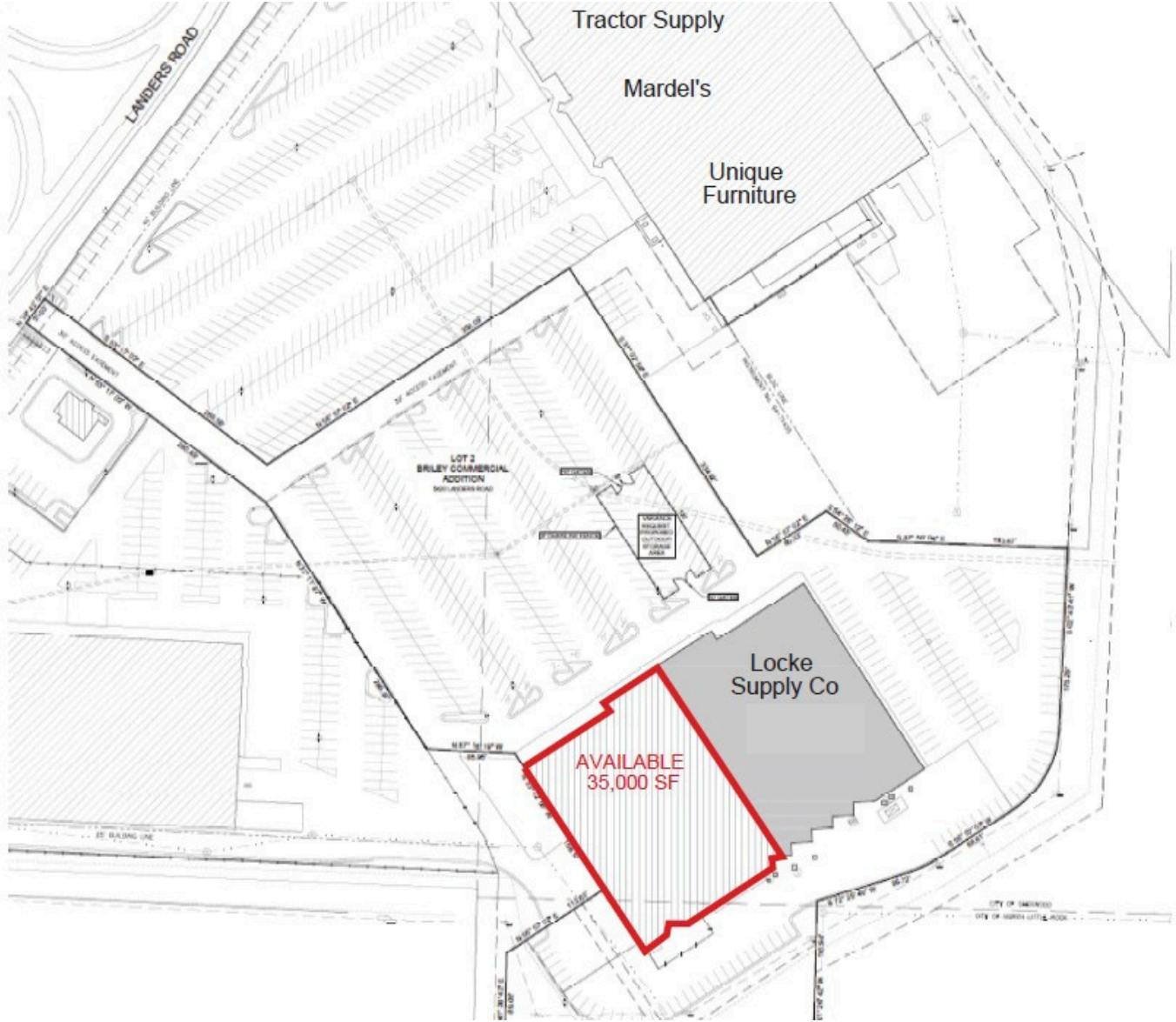



**JLL**

**Stan Myers, CCIM**

Senior Vice President

stan.myers@jll.com

+1 901 261 2618

**Jones Lang LaSalle Brokerage, Inc**

6410 Poplar Ave, Suite 350

Memphis, TN 38119

+1 901 261 2600

**Terry Moore & Associates**

**Randall Moore, CCIM**

Vice President

randall@terrymooreinc.com

+1 501 223 3800