

# SUNPORT COMMERCE CENTER I

230 SUNPORT LANE, ORLANDO, FL 32809



100% HVAC

CONVENIENT ACCESS  
TO SR 528 AND FLORIDA'S TURNPIKE

11,200 SF AVAILABLE  
SUITE 400

## SPACE HIGHLIGHTS

### ASKING RATE

\$16.25/SF NNN

### OPEX\*

\$3.23/PSF

### MONTHLY RATE

\$18,181.33/MO

### WAREHOUSE SF

9,514 SF

### OFFICE SF

1,686 SF

### CLEAR HEIGHT

16'

### LOADING DOORS

(4) DOCK DOORS

### ZONING

IND-4

### PARKING RATIO

1.63/1,000

### FIRE SUPPRESSION

CLASS IV

### YEAR BUILT

2000

### AVAILABILITY

30 DAYS

\*Denotes Estimated Operating Expenses for 2026

## CONTACT INFORMATION

### TAYLOR ZAMBITO

Senior Director  
+1 407 541 4409  
taylor.zambito@cushwake.com

### RYAN HUBBARD

Director  
+1 407 541 4390  
ryan.hubbard@cushwake.com



# FLOOR PLAN

## SUITE 400

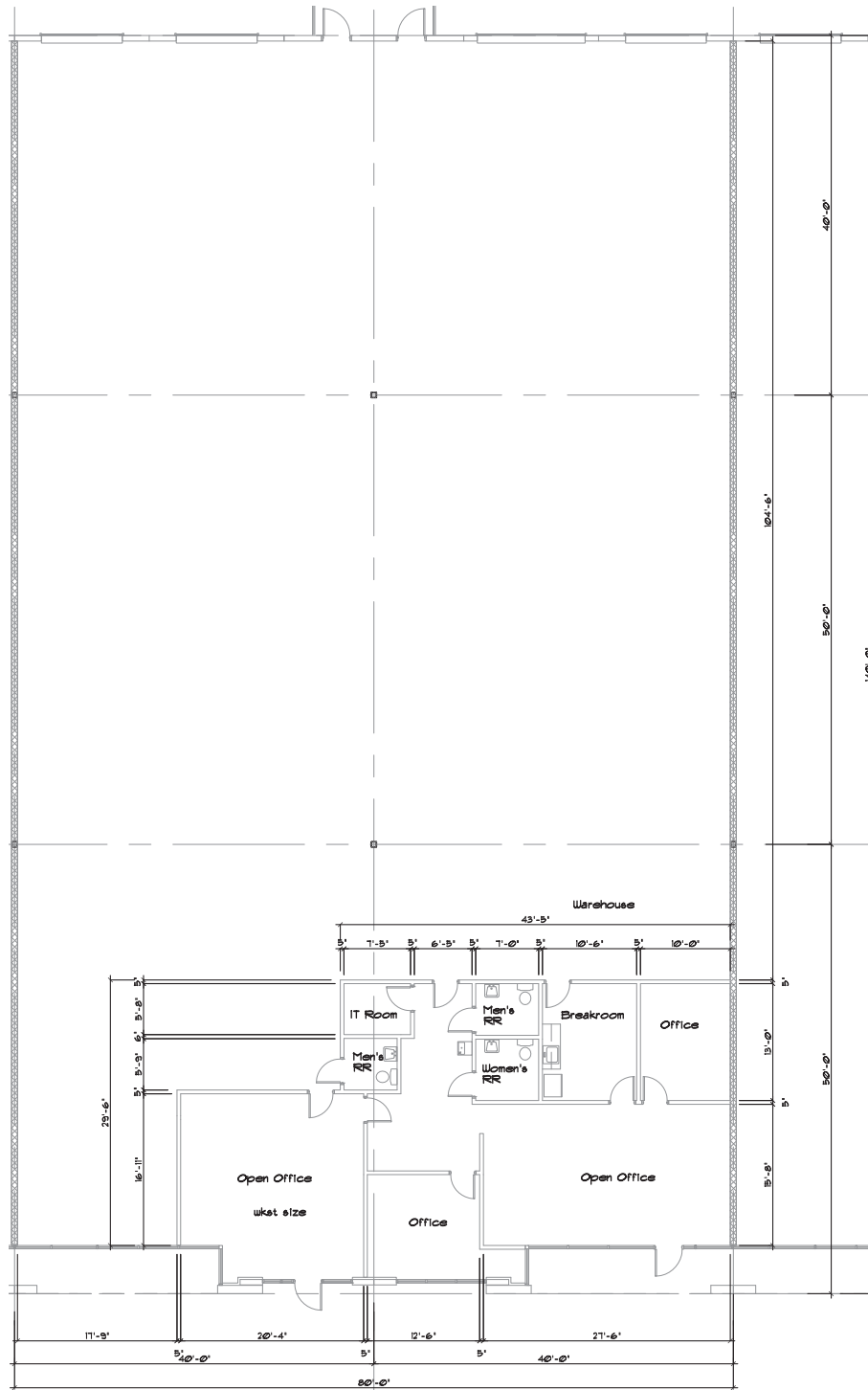

## CONTACT INFORMATION

### TAYLOR ZAMBITO

Senior Director  
 +1 407 541 4409  
 taylor.zambito@cushwake.com

### RYAN HUBBARD

Director  
 +1 407 541 4390  
 ryan.hubbard@cushwake.com

