



For Sublease

Space Available

- Suite 14446: 1,240 SF
- Term: 8/1/26 to 6/30/28
- 2026 CAM: \$2.44 PSF and Tax: \$5.50 PSF
- Lease Rate: \$19.50 PSF NNN

Contact us:

Laura Gill

Associate Vice President
+1 612 310 5399
laura.gill@colliers.com

Colliers

1600 Utica Avenue S, Suite 300
St. Louis Park, MN 55416
P: +1 952 897 7700
colliers.com/msp

Glen Lake Village

14400 Excelsior Blvd | Minnetonka, MN 55345

Grocery Anchored Retail Space

Highlights & Features

- Neighborhood center anchored by Lunds & Byerly's
- Great visibility and access from Excelsior Blvd
- Located in dense Glen Lake neighborhood
- Parking: 147 spaces
- Building signage
- Co-tenants Glen Lake Wine and Spirits, EZ on the Eyes, Acupressure Sun Spa, and Dragon Jade
- Area Tenants: Unmapped Brewing Company, Pet Stuff, Gina Marias Pizza, Studio 13, State Farm, E-Cig POD, Glen Lake Animal Hospital, BP, Tide Cleaners, Snap Fitness, Glen Lake Academy of Dance, Prestige Preschool Academy, Gold Nugget, Glen Lake Dental, Mobile Hair Proz salon, Health Source, and Gunstop

Copyright © 2025 Colliers International. Information herein has been obtained from sources deemed reliable, however its accuracy cannot be guaranteed. The user is required to conduct their own due diligence and verification.

Accelerating success.

Site Plan

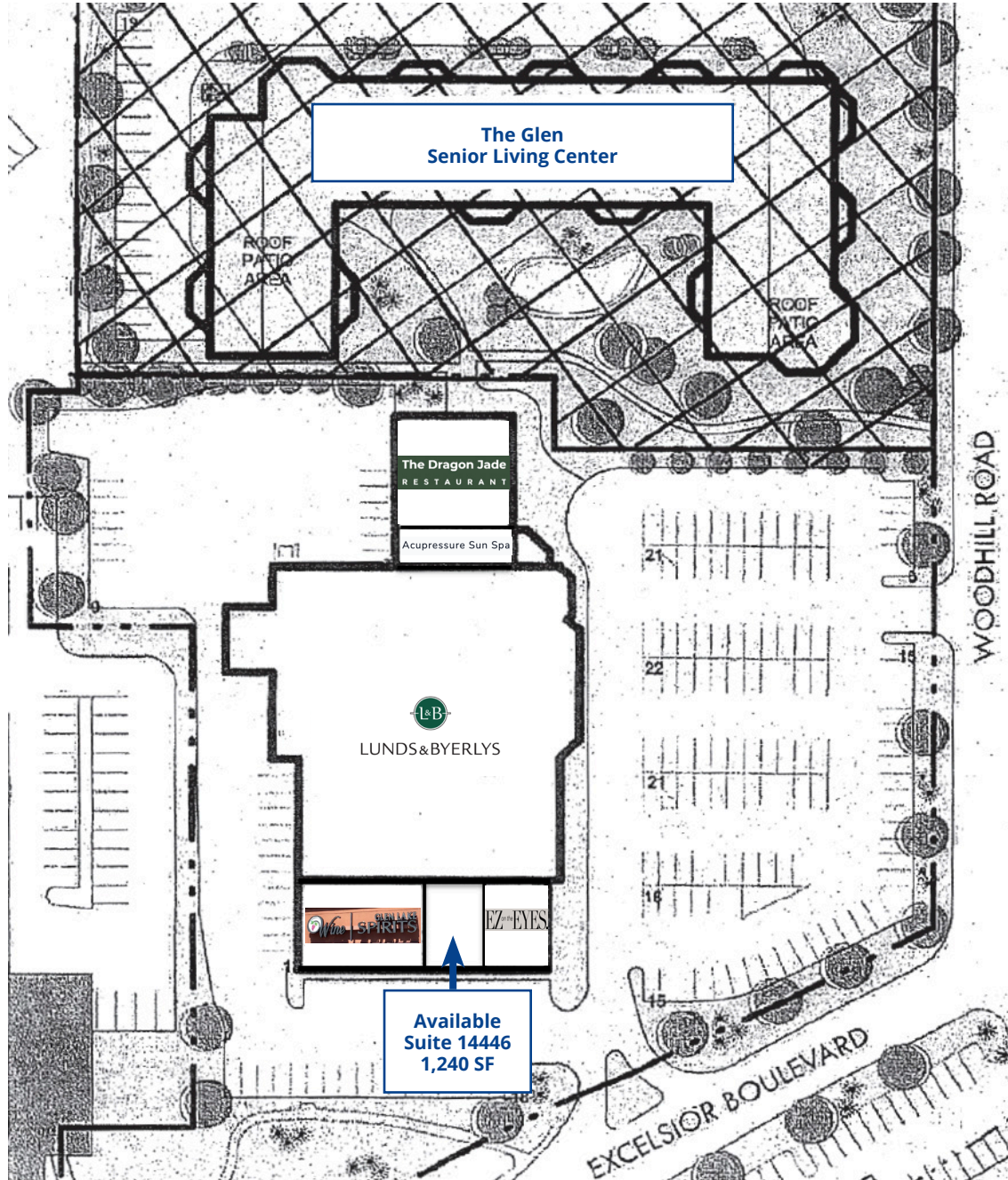

1600 Utica Avenue S, Suite 300
St. Louis Park, MN 55416
P: +1 952 897 7700

This document has been prepared by Colliers for advertising and general information only. Colliers makes no guarantees, representations or warranties of any kind, expressed or implied, regarding the information including, but not limited to, warranties of content, accuracy and reliability. Any interested party should undertake their own inquiries as to the accuracy of the information. Colliers excludes unequivocally all inferred or implied terms, conditions and warranties arising out of this document and excludes all liability for loss and damages arising there from. This publication is the copyrighted property of Colliers and /or its licensor(s). © 2025. All rights reserved. This communication is not intended to cause or induce breach of an existing listing agreement.

Location Overview

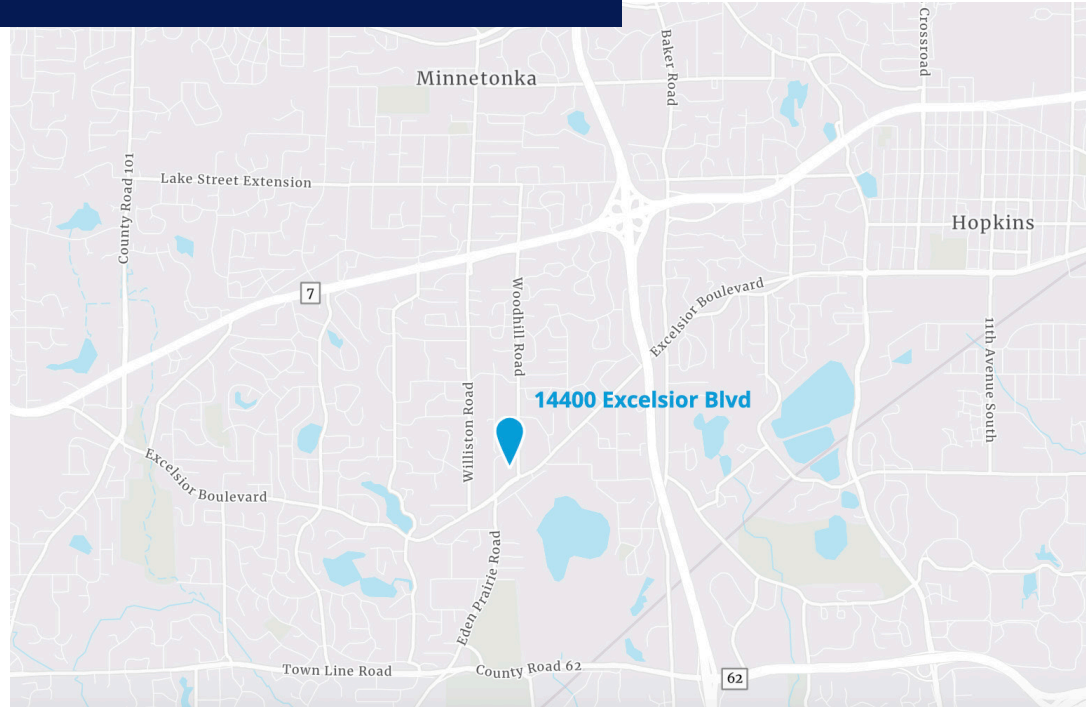

Demographics

Average Household Population

1 Mile	6,118
3 Miles	59,682
5 Miles	160,725

Average Household Income

1 Mile	\$152,758
3 Miles	\$128,617
5 Miles	\$136,643

Traffic Counts

- Excelsior Blvd W - 10,500 vpd
- Excelsior Blvd E - 10,100 vpd
- Eden Prairie Road - 7,300 vpd



1600 Utica Avenue S, Suite 300
St. Louis Park, MN 55416
P: +1 952 897 7700

This document has been prepared by Colliers for advertising and general information only. Colliers makes no guarantees, representations or warranties of any kind, expressed or implied, regarding the information including, but not limited to, warranties of content, accuracy and reliability. Any interested party should undertake their own inquiries as to the accuracy of the information. Colliers excludes unequivocally all inferred or implied terms, conditions and warranties arising out of this document and excludes all liability for loss and damages arising there from. This publication is the copyrighted property of Colliers and /or its licensor(s). © 2025. All rights reserved. This communication is not intended to cause or induce breach of an existing listing agreement.