

444 N IL Route 31 Unit 100  
Crystal Lake, IL 60014

For Lease

MLS #12420282

OFFICE SUITES



OFFICE SUITES 165 - 324 SF

\$400. - \$1,500./MO. (FULL SERVICE)

**Property Description**

Individual office spaces available at the Woods of Crystal Lake Office/Retail Complex on Route 31 just North of Route 176.

**Two spaces located on the lower garden level :**

- #2: 165 SF \$400/mo.
- #3: 171 SF \$400/mo.

**Two spaces located on the main level:**

- #4: 324 SF \$1500/mo. (window lined)
- #6: 180 SF \$600/mo.

Full service lease includes CAM, taxes, utilities and access to common areas : coffee bar, kitchenette/ break /conference room and restrooms on each level in this elevator equipped building.

**Specifications**

Building Size:	5,200 SF
Year Built:	2007
HVAC System:	GFA/ Central Air
Electrical:	220/240
Sprinklers:	No
Washrooms:	2 (main level) 1 (lower Level)
Ceiling Height:	+/-10 ft
Parking:	Common
Sewer/Water:	City
Zoning:	B2 PUD
Utilities:	Included
CAM & Taxes	Included
PIN #:	14-34-130-012

Demographics	1 Mile	3 Miles	5 Miles
Total Population	3,078	31,317	92,075
Average HH Income	\$146,266	\$132,433	\$129,546

[CLICK HERE TO VIEW OUR WEBSITE](#)

No warranty or representation is made as to the accuracy of the foregoing information. Terms of sale or lease and availability are subject to change or withdrawal without notice. This document is for information purposes only. No offer of sub-agency is being made.



**Sharon Glasshof**  
Senior Broker  
SharonG@PremierCommercialRealty.com  
O: 847.854.2300 x14 C: 847.533.6974

444 N IL Route 31 Unit 100  
Crystal Lake, IL 60014

For Lease

OFFICE SUITES

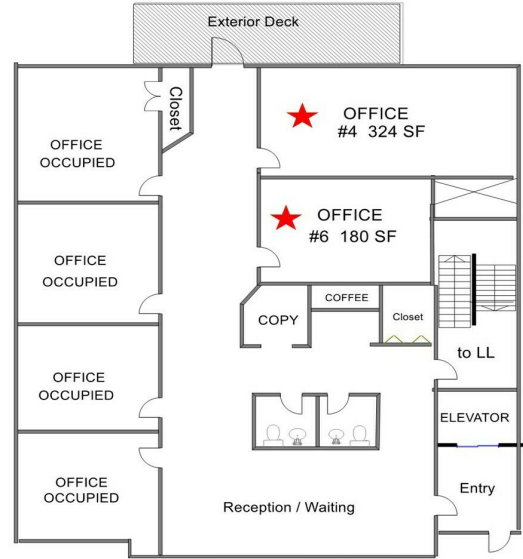

Measurements are Approximate

MAIN LEVEL

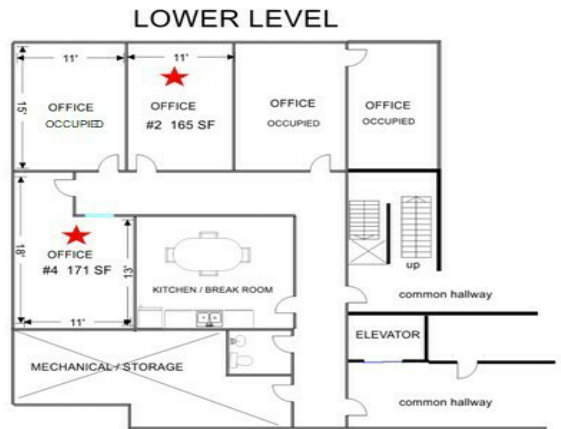

Measurements are Approximate

CLICK HERE TO VIEW OUR WEBSITE

No warranty or representation is made as to the accuracy of the foregoing information. Terms of sale or lease and availability are subject to change or withdrawal without notice. This document is for information purposes only. No offer of sub-agency is being made.



Sharon Glasshof  
Senior Broker  
SharonG@PremierCommercialRealty.com  
O: 847.854.2300 x14 C: 847.533.6974