



ARES  
INDUSTRIAL  
MANAGEMENT

# 1500 TRADEPORT DR.

ORLANDO, FL 32824

FOR LEASE | 46,405 SQ FT | Class A Warehouse Facility



**FOUNDRY**  
COMMERCIAL

**JUSTIN RUBY, SIOR, CCIM**

Partner  
407-865-0311

**JOEY WOODMAN, SIOR**

Partner  
407-748-5888

**OWNED BY**



ARES  
INDUSTRIAL  
MANAGEMENT

# Property FEATURES

- 5,370 Office SF
- 26' clear height
- 280' building depth
- Front Load
- 40' column spacing
- 7 Dock-High doors
- 1 Drive-In Door
- Wet Sprinkler
- 66 parking spots
- 120' truck court depth
- TPO Roof
- LED Lighting

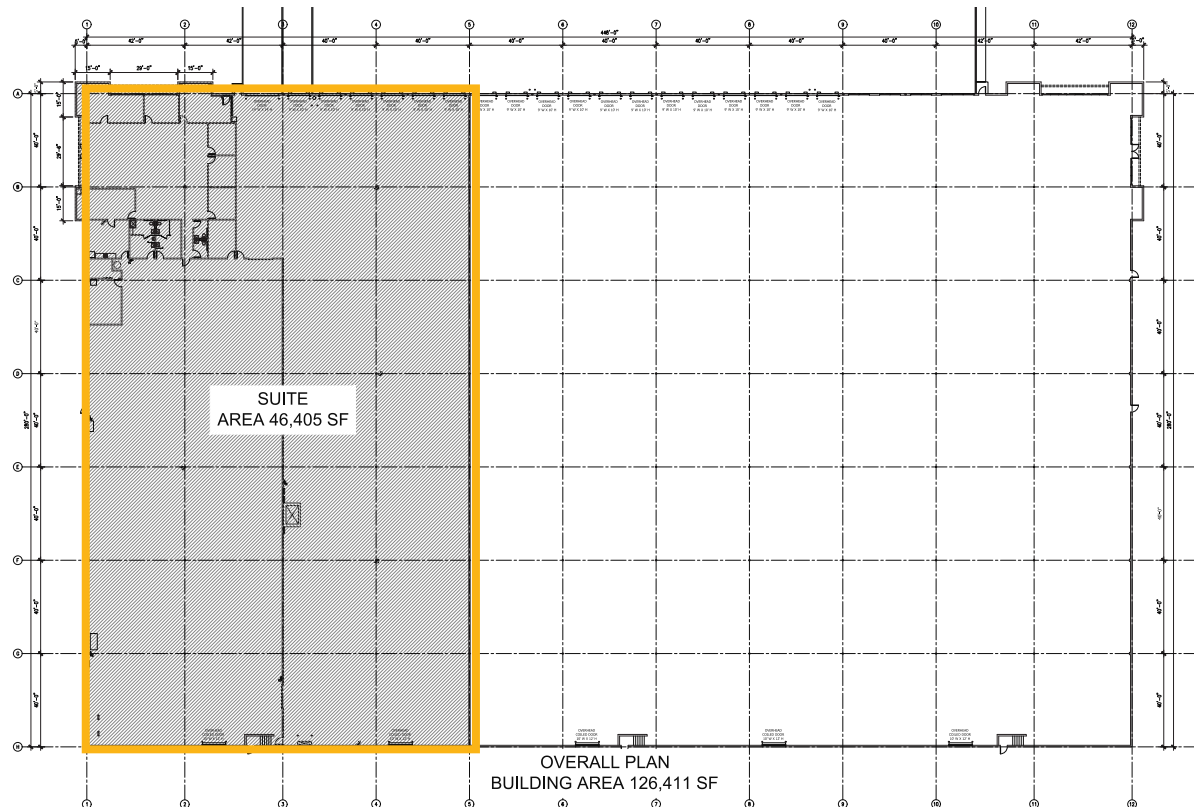

ARES  
INDUSTRIAL  
MANAGEMENT

# Location HIGHLIGHTS

- Located near the Orlando International Airport (MCO)
- 6 miles to SR 417 and the Florida Turnpike
- 7 miles to SR 528



ARES  
INDUSTRIAL  
MANAGEMENT

## ABOUT ARES MANAGEMENT CORPORATION

Ares Management Corporation (NYSE: ARES) is a leading global alternative investment manager offering clients complementary primary and secondary investment solutions across the credit, private equity, real estate and infrastructure asset classes. We seek to provide flexible capital to support businesses and create value for our stakeholders and within our communities. By collaborating across our investment groups, we aim to generate consistent and attractive investment returns throughout market cycles. For more information, please visit [www.aresmgmt.com](http://www.aresmgmt.com).



**FOUNDRY**  
COMMERCIAL

**JUSTIN RUBY, SIOR, CCIM**

Partner  
407-865-0311

**JOEY WOODMAN, SIOR**

Partner  
407-748-5888



**ARES  
INDUSTRIAL  
MANAGEMENT**