

1520 Industrial Dr. Unit D

Lake in the Hills, IL 60156

For Lease

MLS #12594290

INDUSTRIAL

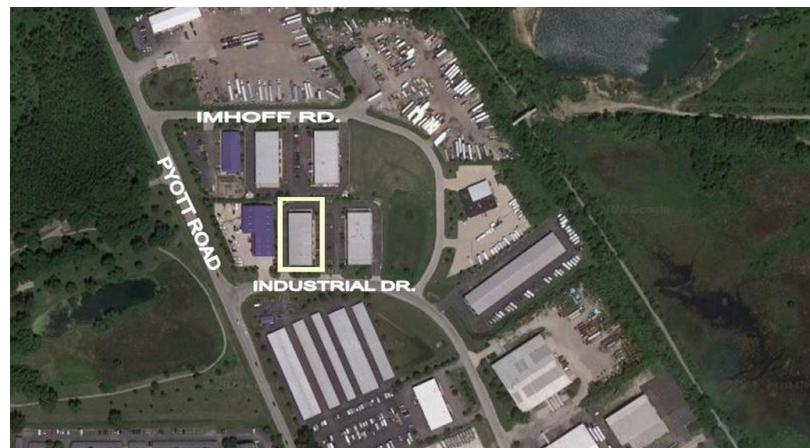

INDUSTRIAL 1,200 SF

\$1,300/MO. (GROSS) \$13 PSF

Property Description

INDUSTRIAL SPACE 1,200 SF

UNIT D: Rare 1,200 SF industrial space with 1 bath, one 10'x10' DID and triple basin drains.

Ideal unit for contractors/trades or to store toys. \$1,300/mo. Gross with CAM and taxes included.

Unit is part of a 14,400 SF building with common exterior dock, located in Cory South of the Larsen Industrial Park just off of Pyott Road.

Specifications

Building Size:	14,400
Year Built:	2004
Office Size:	None
HVAC System:	GFA
Sprinklers:	Yes
Washrooms:	1 ADA
Ceiling Height:	18 ft
Parking:	Common
DID's:	(1) 10'x10'
Dock:	1 Common
Sewer/Water:	City
Zoning:	M1
CAM & Taxes	Included
Electrical:	200 amp 240V, 3 Phase
PIN #:	19-21-127-002

[CLICK HERE TO VIEW OUR WEBSITE](#)

No warranty or representation is made as to the accuracy of the foregoing information. Terms of sale or lease and availability are subject to change or withdrawal without notice. This document is for information purposes only. No offer of sub-agency is being made.



Heather Schweitzer
President / Designated Managing Broker
HeatherS@PremierCommercialRealty.com
O: 847.854.2300 x15 C: 815.236.9816

Austin Schweitzer
Associate Broker
AustinS@PremierCommercialRealty.com
O: 847.854.2300 x16 C: 815.236.9972

1520 Industrial Dr. Unit D

Lake in the Hills, IL 60156

For Lease

INDUSTRIAL

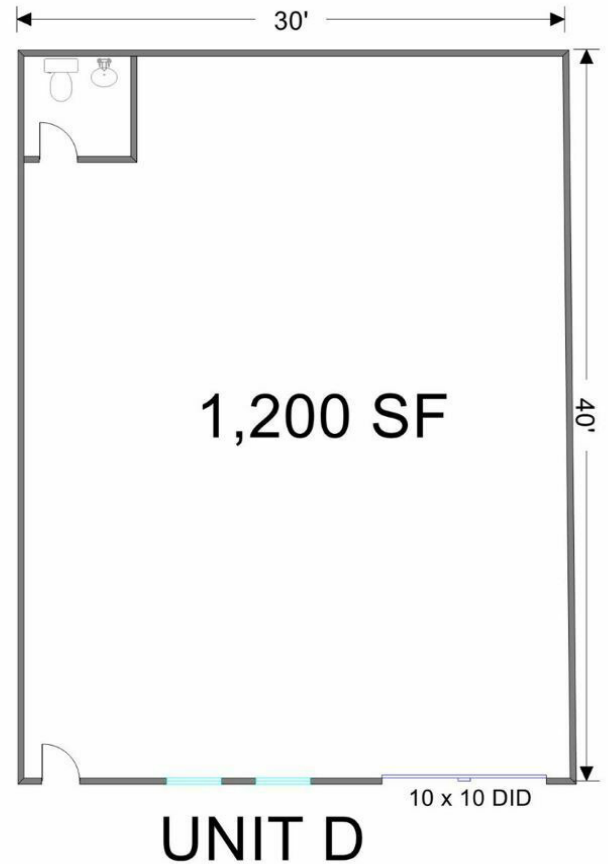

		1,200 SF I	1,200 SF H	1,200 SF G	
2,400 SF A	2,400 SF B	1,200 SF C	1,200 SF D	1,200 SF E	2,400 SF F

1520 Industrial Drive

[CLICK HERE TO VIEW OUR WEBSITE](#)

No warranty or representation is made as to the accuracy of the foregoing information. Terms of sale or lease and availability are subject to change or withdrawal without notice. This document is for information purposes only. No offer of sub-agency is being made.



Heather Schweitzer
 President / Designated Managing Broker
 HeatherS@PremierCommercialRealty.com
 O: 847.854.2300 x15 C: 815.236.9816

Austin Schweitzer
 Associate Broker
 AustinS@PremierCommercialRealty.com
 O: 847.854.2300 x16 C: 815.236.9972