



PROPERTY DESCRIPTION

Newer flex / warehouse construction available at Airport Commerce Park, strategically located near I-4, the Lakeland airport, Polk Parkway, Publix HQ, Amazon and in one of the "fastest growing cities" in the US.

Single bay available for a total of 1,900 SF with 390 SF of office and one grade level door.

Exterior walls are tilt-up concrete, the floor is 5' thick, electrical service is 3 phase - 120/240v, total of 25 parking per building (2.19/1000 SF), total of 6 drive-in (12' x 14') per buildings (1/1,900 SF), 20' clear height and column spacing of 36' x 50'.

The property is located in the office and industrial HUB of the international airport of Lakeland. Easy access to Polk Parkway, I-4 and 6 miles from downtown Lakeland.

OFFERING SUMMARY

Available SF:	1,900 SF
Lot Size:	3.26 Acres
Total Building Size:	34,200 SF
Built:	2022
Power:	3 phase - 120/240v
Clear Height:	20 ft
Loading:	Grade Level Access (12'x14')
Market:	Tampa / St Petersburg
Submarket:	Lakeland MSA

DEMOGRAPHICS	5 MILES	15 MILES	30 MILES
Total Households	38,830	156,541	461,477
Total Population	99,880	423,671	1,242,217
Average HH Income	\$75,909	\$60,315	\$62,011

LAKELAND IS AN IDEAL LOCATION
FOR DISTRIBUTION

11 million people within 100 miles
21 million people within 200 miles

Need Warehouse Space?
Call the Ruthvens!



Central Florida's
Warehouse Specialist

AIRPORT COMMERCE PARK

3625 - 3685 AIRPORT COMMERCE DR, LAKELAND, FL 33811

FOR LEASE

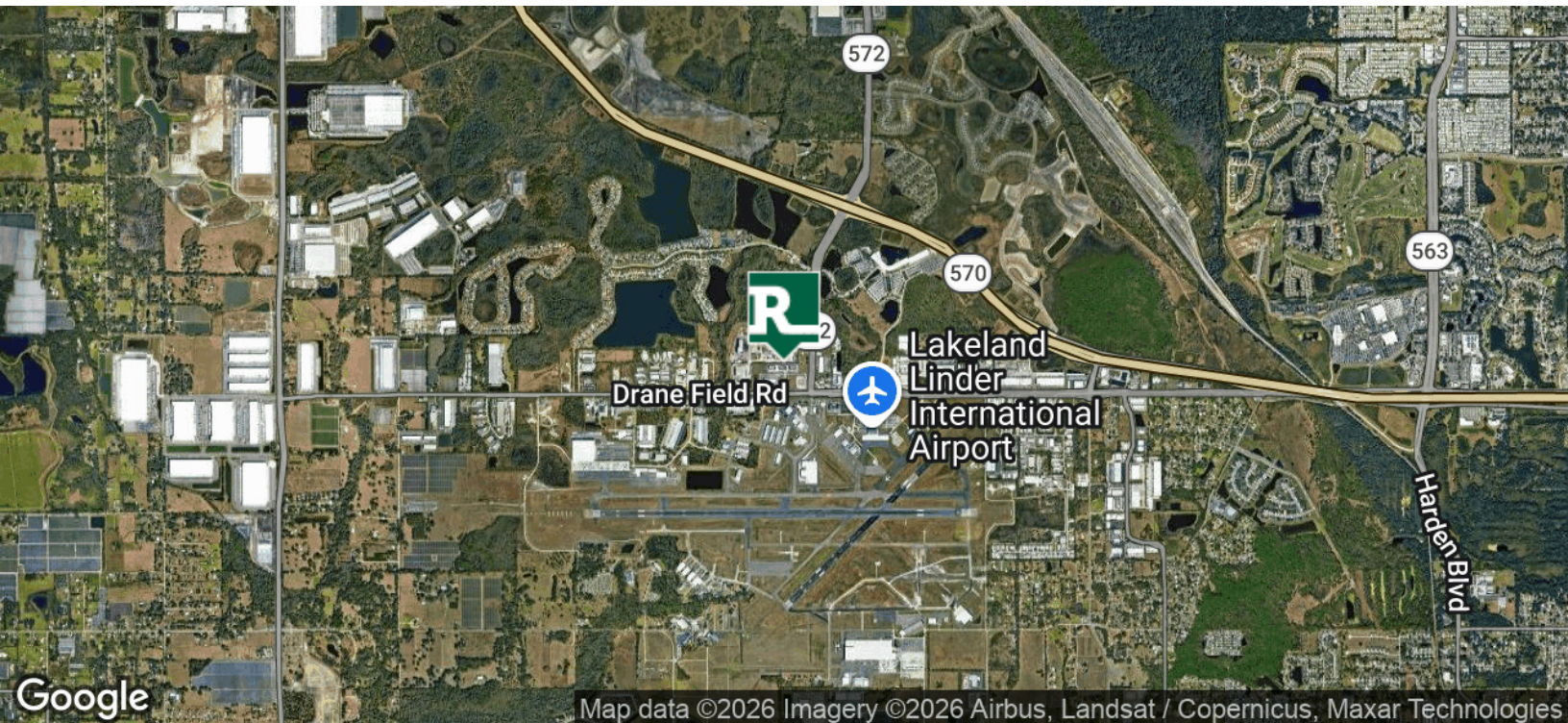
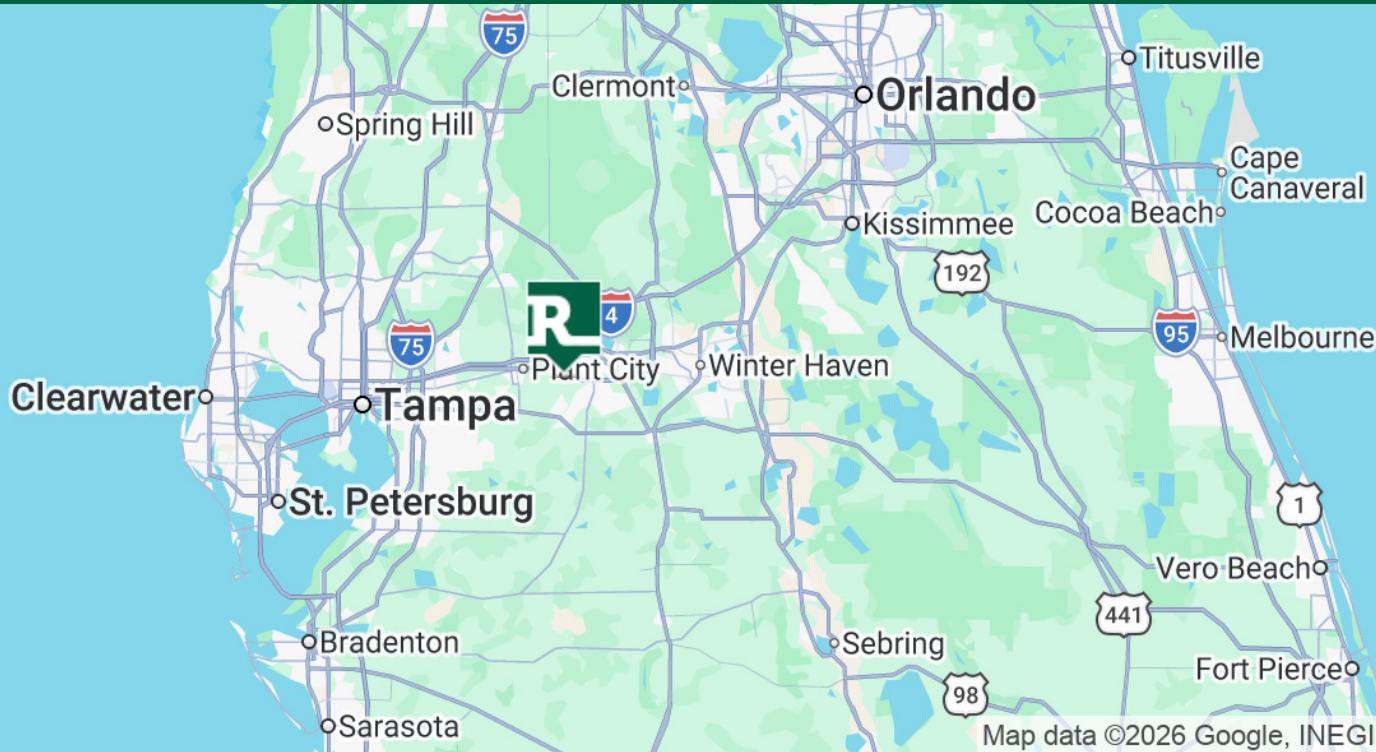

ALEX DELANNOY, SIOR

863.250.2502
adelannoy@ruthvens.com

[View Property Website](#)



Central Florida's
Warehouse Specialist

AIRPORT COMMERCE PARK

3625 - 3685 AIRPORT COMMERCE DR, LAKELAND, FL 33811

FOR LEASE



CITY OF LAKELAND

Lakeland has always been a hub of innovation and progressive ideas. Today, the City continues to thrive as population and business expansions are attracted to this area, the geographic center of Florida. Lakeland's economic base consists of warehouse, transportation and distribution, education, health care, manufacturing and retail.

Lakeland has received the distinction of being on Money Magazine's "Best Place to Live in America" list. In addition, Lakeland is home to Publix Supermarkets, Amazon, Florida Southern College and is the winter home to the Detroit Tigers.



LARGEST EMPLOYERS IN LAKELAND NEARBY

Headquartered within one mile from subject property in Lakeland, Publix is Florida's largest private employer. In 2018, they announced it would hire those additional 700 employees to fill a 190,000 square foot office addition bringing their total employment in Lakeland to over 8,000.

On top of their current corporate offices located within a couple of miles of subject property, Geico recently expanded their regional office by another 50,000 square feet. This expansion resulted in a \$12 million capital investment 500 new High-Skill, High-Wage jobs, bringing their Lakeland employment to 3,700.



AMAZON FULFILLMENT AND PRIME AIR HUB

In 2014, Amazon constructed and opened a new 1,000,000+ square foot fulfillment center located on County Line Road with 900+ employees, since then Amazon continued to chose Lakeland and not only quadruple their size in Polk County but relocated their Amazon Air HUB in 2020 to Lakeland International Airport from Tampa with a new 285,000 square foot facility creating thousands of jobs.

In 2021, they announce an expansion that will more than double their capacity making it the largest Amazon facility in the Southeast in 2022 with another 464,000 square feet and hundreds of new jobs

ALEX DELANNOY, SIOR

863.250.2502
adelannoy@ruthvens.com

View Property
Website



Year Built: 2022



Building Size: 11,400 SF



Building Dimensions: 150' x 76'



Parking Spaces: 25 / building (2.9/1000 SF)



Drive-in Doors: 6 (12' x 14') / building (1/1,900 SF)



Clear Height: 20'



Column Spacing: 36' x 50'



Exterior Walls: Load-Bearing Tilt-up Concrete



Floor: 5" thickness



Electrical Service: 3 phase - 120/204v



Signage: Available on Building & Windows



Utilities: City of Lakeland

ALEX DELANNOY, SIOR

863.250.2502

adelannoy@ruthvens.com

View Property
Website

LEGEND

Available

Available Soon

Unavailable

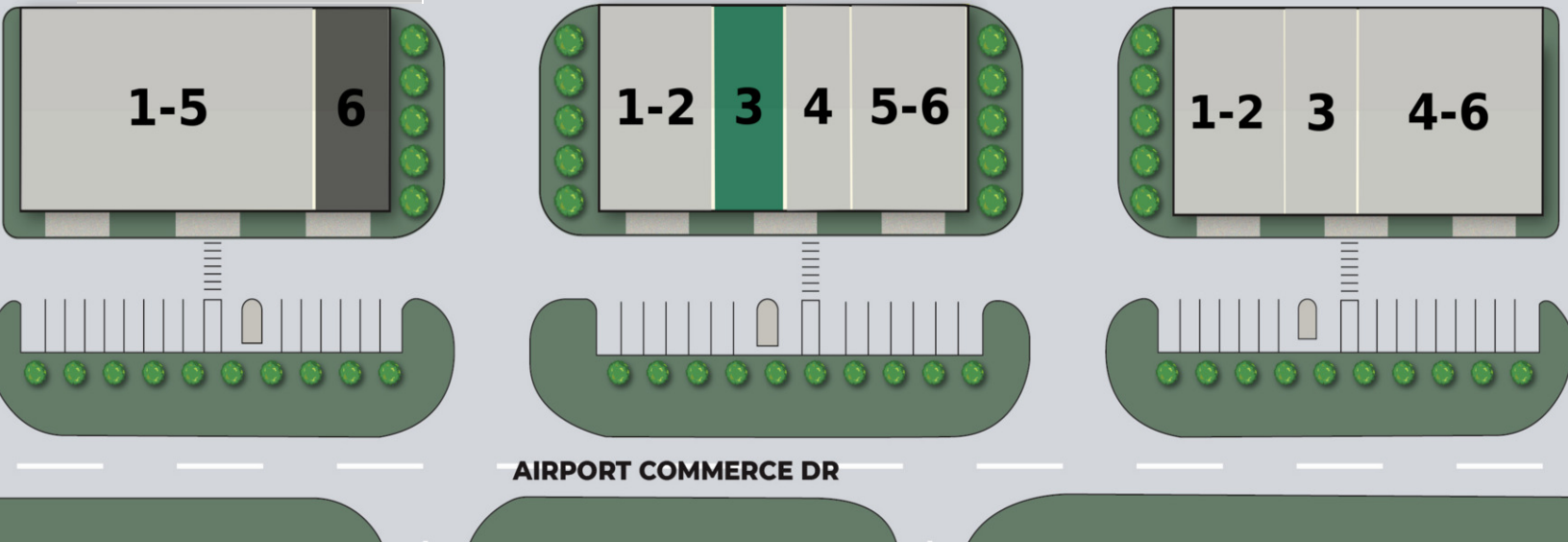

LEASE INFORMATION

Lease Type:	NNN
Total Space:	1,900 SF

Lease Term:	Negotiable
Lease Rate:	Call 863-250-2502 for pricing

AVAILABLE SPACES

SUITE	TENANT	SIZE	TYPE	RATE
3	Available	1,900 SF	NNN	Call 863-250-2502 for pricing
6	Available Soon	1,900 SF	NNN	Call 863-250-2502 for pricing

ALEX DELANNOY, SIOR

863.250.2502
adelannoy@ruthvens.com

View Property
Website



LEASE INFORMATION

Lease Type:	NNN	Lease Term:	Negotiable
Total Space:	1,900 SF	Lease Rate:	Call 863-250-2502 for pricing

AVAILABLE SPACES

SUITE	TENANT	SIZE	TYPE	RATE
3	Available	1,900 SF	NNN	Call 863-250-2502 for pricing

ALEX DELANNOY, SIOR

863.250.2502
adelannoy@ruthvens.com

View Property
Website

3645 - BAY 3

- Total of 1,900 SF
- 390 SF of office
- One reception/office and one private office
- One restroom
- 20' clear height
- One grade level door (12' x 14')
- 3 phase - 120/240v
- Signage available

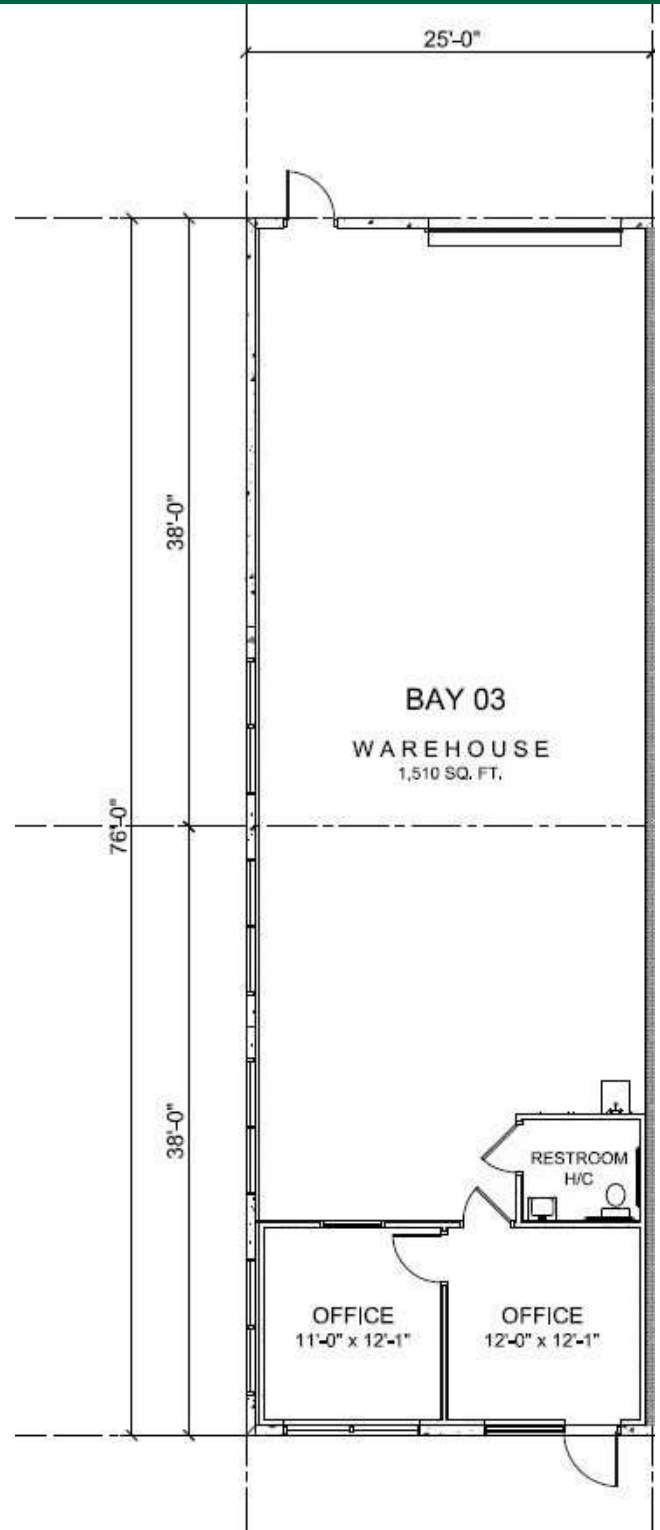

ALEX DELANNOY, SIOR

863.250.2502
adelannoy@ruthvens.com

View Property
Website

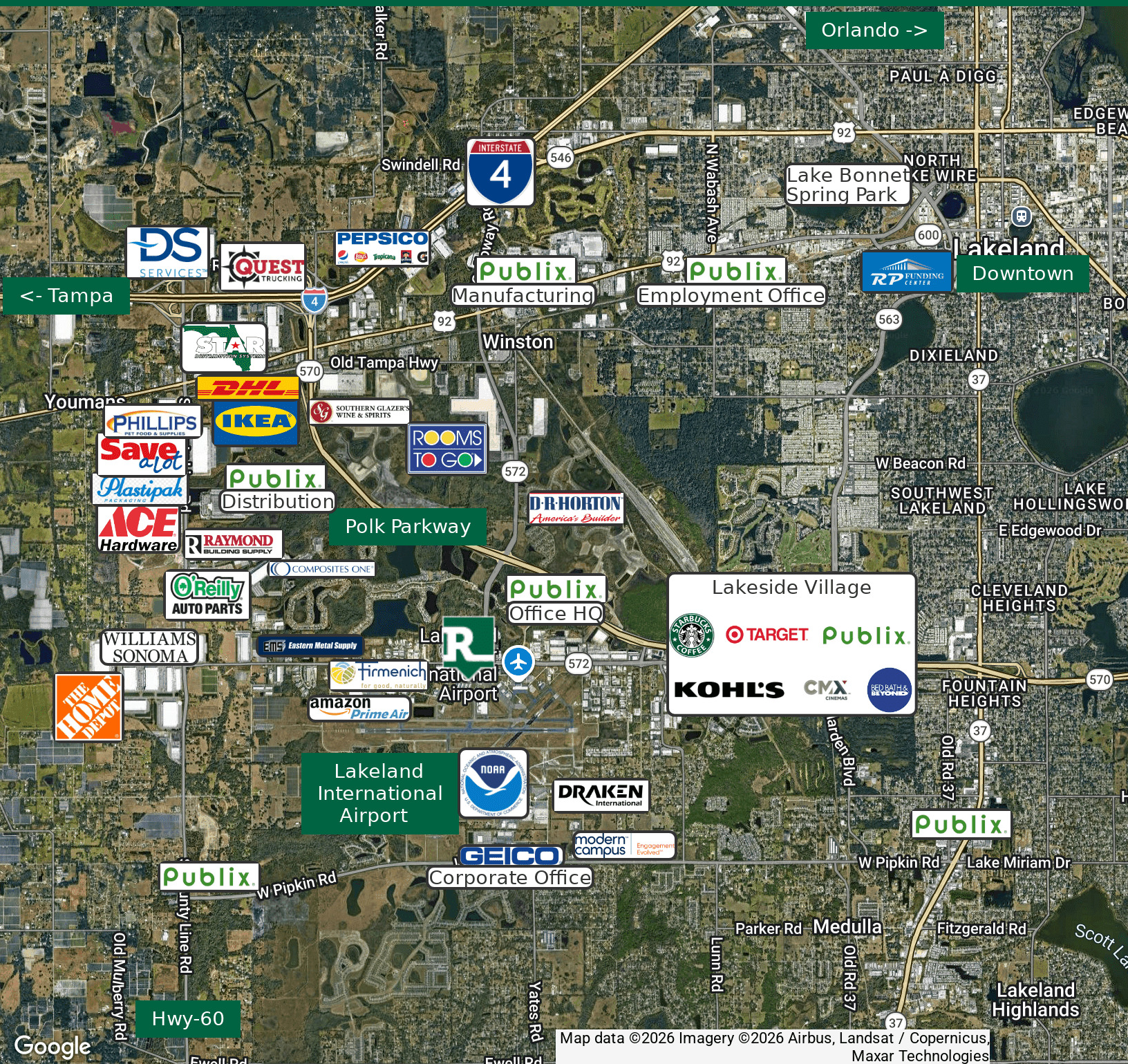

ALEX DELANNOY, SIOR

863.250.2502
adelannoy@ruthvens.com

View Property
Website

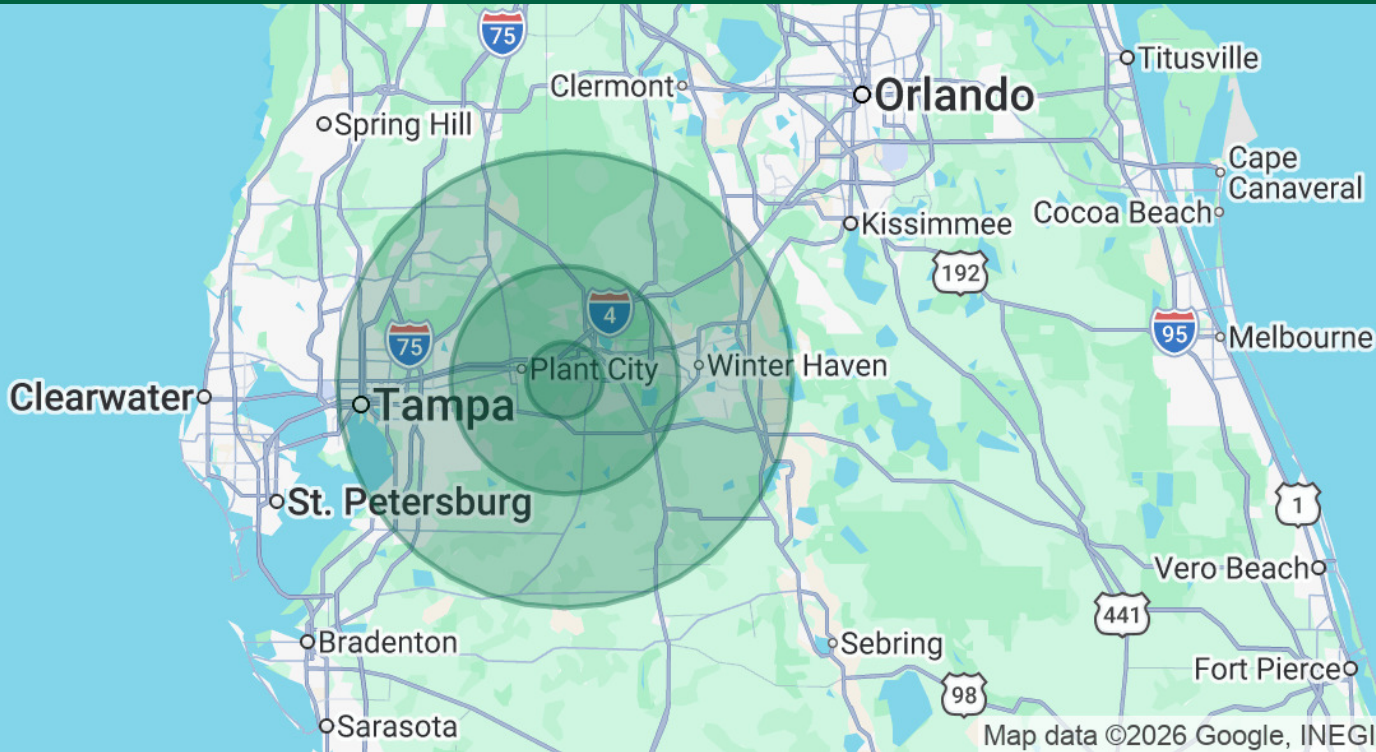

POPULATION

	5 MILES	15 MILES	30 MILES
Total Population	99,880	423,671	1,242,217
Average Age	40.4	37.7	38.2
Average Age (Male)	39.5	36.2	37.2
Average Age (Female)	41.5	39.0	39.0

HOUSEHOLDS & INCOME

	5 MILES	15 MILES	30 MILES
Total Households	38,830	156,541	461,477
# of Persons per HH	2.6	2.7	2.7
Average HH Income	\$75,909	\$60,315	\$62,011
Average House Value	\$209,715	\$182,373	\$194,754

TRAFFIC COUNTS

Airport Rd	10,500/day
Drane Field Rd	8,300/day

* Demographic data derived from 2020 ACS - US Census

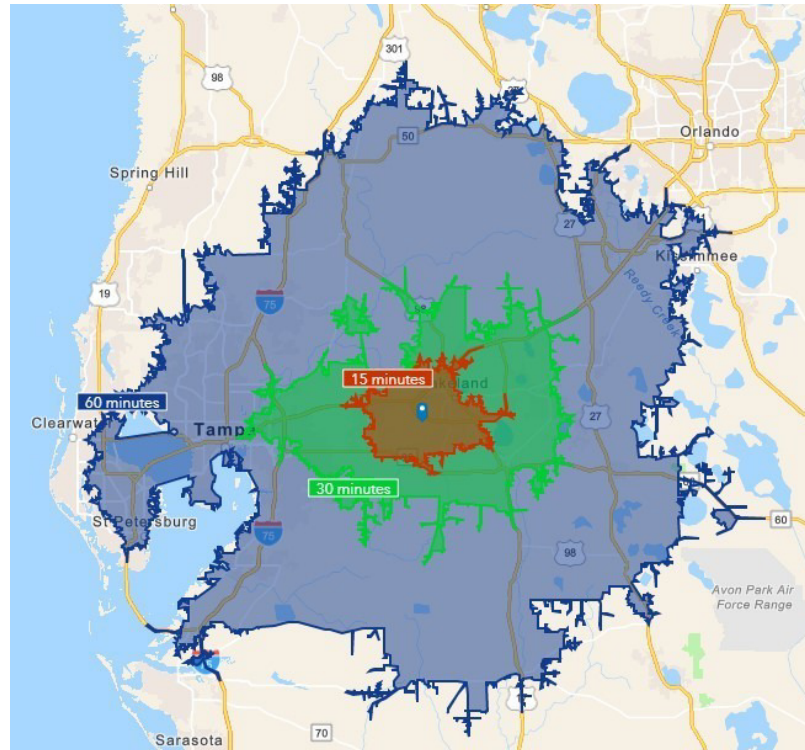

ALEX DELANNOY, SIOR

863.250.2502
adelannoy@ruthvens.com

View Property
Website



ALEX DELANNOY, SIOR

Vice President of Brokerage

adelannoy@ruthvens.com

Direct: 863.250.2502 | **Cell:** 863.250.2502

PROFESSIONAL BACKGROUND

Alex Delannoy was born and raised in Toulouse, France, with a strong drive and burning desire to discover new experiences and knowledge. His travels through Europe and throughout the world have created a great passion for the diversity and culture he experienced.

Alex became a professional paintball player and came to the United States in 2010 when he joined one of the top teams in the league in the Tampa, FL area. After spending a few years with the team, his entrepreneurial spirit drove him to start his own business in Winter Haven, FL called Action Paintball & Laser Tag. The facility included a retail pro-shop, more than 30 trained employees, room for five different onsite activities, and became a thriving business with more than 35,000 players over the years. The business was purchased by an investor in early 2017.

He joined The Ruthvens in 2022 and leads the charge on our brokerage properties and services. He made a successful name for himself as a senior advisor at KW Commercial, where he built a book of commercial real estate business and managed brokerage assets in the Central Florida area for five years. Alex is known for providing results by creating opportunities through analyzing a problem and finding a durable solution by using all resources available. Alex is always looking at new ways to add value and skills, and his experience in his craft and in the community is a big reason he's a trusted resource to head up the brokerage properties division at The Ruthvens.

EDUCATION

FGCAR Commercial Real Estate University Courses

Lipsey School of Real Estate - Commercial MICP Designation

MEMBERSHIPS

Society of Industrial and Office Realtors (SIOR), Florida Regional Director & Tech Chair

Certified Commercial Investment Member Institute (CCIM), Candidate

Manufacturing & Supply Chain of Mid Florida

NAIOP Member of Central Florida

National Realtor Association

Lakeland Realtor Association

ALEX DELANNOY, SIOR

863.250.2502

adelannoy@ruthvens.com

View Property
Website