

**27992 W State Route 120**  
Lakemoor, IL 60051

**For Lease**

MLS #12538100

**LIGHT INDUSTRIAL**



**LIGHT INDUSTRIAL UNIT 1,200 SF**

**\$1,200. PER MONTH (MG)**

**Industrial Units 720 SF – 4,000 SF**

Outrig Commerce Park – Lakes Region is a professionally maintained, multi-building industrial incubator property offering flexible space for lease, conveniently located off Route 120 near Route 12. This seven-building complex provides excellent access for local and regional users.

Units range from approximately 720 SF up to 4,000 SF, allowing tenants to scale as their business grows. Each unit is heated and features 200 amps of electrical service, 12'x12' or 12'x14' doors, and one restroom. Some units have offices, triple basin floor drains, lofts with stairs, drive-thru access and additional bathrooms, making the property well-suited for a wide range of uses.

Lease terms are \$12.00 PSF modified gross, with tenants responsible for utilities. The property is ideal for small trades, contractors, service providers, hobbyists, and users seeking secure space for equipment or recreational storage.

Outrig Commerce Park – Lakes Region offers an affordable, flexible solution for users seeking functional industrial space in Lake County.

**AVAILABLE NOW**

**Unit 79 (Bldg. 3): 1,200 SF unit, 1 office, bathroom, utility sink, 12'x14' DID. \$1,200/mo. plus utilities.**

**Specifications**

Land Size:	15.65 Acres
Year Built:	2004
No. of Buildings:	7 Total 205,280 SF
HVAC System:	GFA
Electrical:	200 amp
Washrooms:	1-2 per Unit
Ceiling Height:	Varies per Bldg.
Parking:	Common
DID's:	12'x12" and 12'x14'
Sewer/Water:	City
Zoning:	I1 (CUP)
Utilities:	Tenant Responsibility
CAM & Taxes	Included
PIN #:	09-03-100-022 09-04-200-003

[CLICK HERE TO VIEW OUR WEBSITE](#)

No warranty or representation is made as to the accuracy of the foregoing information. Terms of sale or lease and availability are subject to change or withdrawal without notice. This document is for information purposes only. No offer of sub-agency is being made.



**Heather Schweitzer**  
President / Designated Managing Broker  
HeatherS@PremierCommercialRealty.com  
O: 847.854.2300 x15 C: 815.236.9816

**Austin Schweitzer**  
Associate Broker  
AustinS@PremierCommercialRealty.com  
O: 847.854.2300 x16 C: 815.236.9972

[www.PremierCommercialRealty.com](http://www.PremierCommercialRealty.com) | 847.854.2300 | 9225 S. Route 31, Lake in the Hills, IL 60156

LIGHT INDUSTRIAL

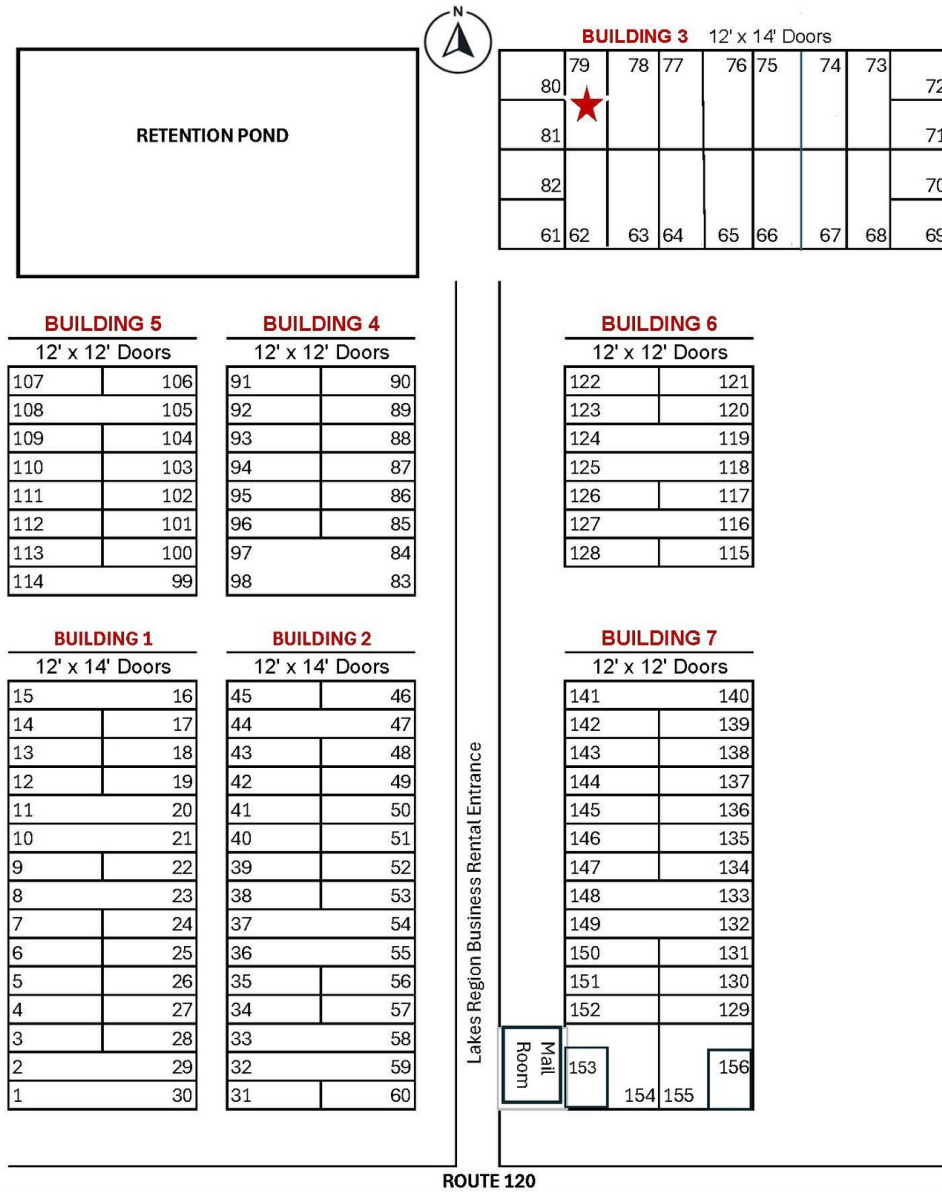

★ AVAILABLE

[CLICK HERE TO VIEW OUR WEBSITE](#)

No warranty or representation is made as to the accuracy of the foregoing information. Terms of sale or lease and availability are subject to change or withdrawal without notice. This document is for information purposes only. No offer of sub-agency is being made.



**Heather Schweitzer**  
President / Designated Managing Broker  
HeatherS@PremierCommercialRealty.com  
O: 847.854.2300 x15 C: 815.236.9816

**Austin Schweitzer**  
Associate Broker  
AustinS@PremierCommercialRealty.com  
O: 847.854.2300 x16 C: 815.236.9972

# 27992 W State Route 120

Lakemoor, IL 60051

## For Lease

**LIGHT INDUSTRIAL**

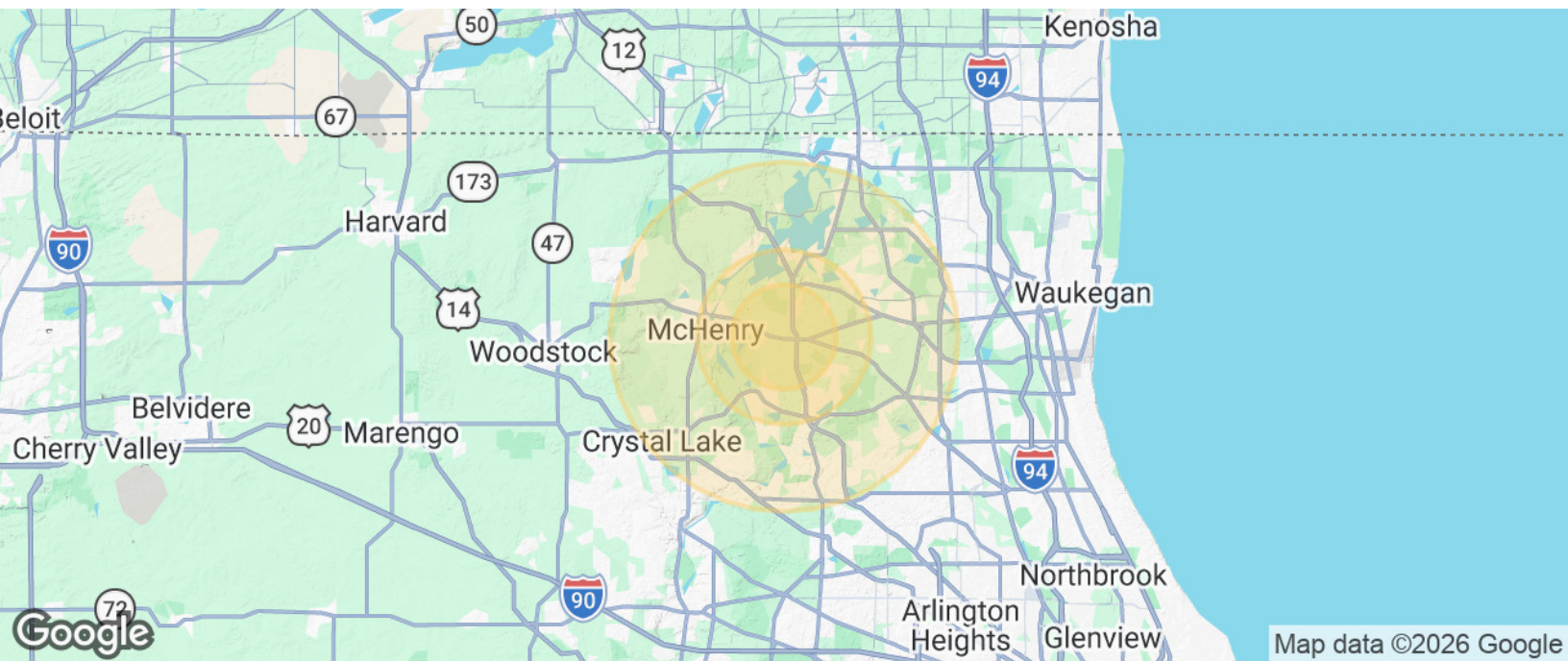

Population	3 Miles	5 Miles	10 Miles
Total Population	20,982	97,449	301,623
Average Age	38	40	41
Average Age (Male)	38	39	40
Average Age (Female)	39	41	42

Households & Income	3 Miles	5 Miles	10 Miles
Total Households	7,818	36,149	112,736
# of Persons per HH	2.7	2.7	2.7
Average HH Income	\$137,758	\$117,859	\$130,428
Average House Value	\$298,553	\$283,980	\$318,298

*Demographics data derived from AlphaMap*

[CLICK HERE TO VIEW OUR WEBSITE](#)

No warranty or representation is made as to the accuracy of the foregoing information. Terms of sale or lease and availability are subject to change or withdrawal without notice. This document is for information purposes only. No offer of sub-agency is being made.



**Heather Schweitzer**  
President / Designated Managing Broker  
HeatherS@PremierCommercialRealty.com  
O: 847.854.2300 x15 C: 815.236.9816

**Austin Schweitzer**  
Associate Broker  
AustinS@PremierCommercialRealty.com  
O: 847.854.2300 x16 C: 815.236.9972