



NEW CONSTRUCTION RETAIL/OFFICE

4001 Tulane Ave, New Orleans, LA 70119

MATT EATON, CCIM • PARTNER
OFFICE: 504.414.0703
MOBILE: 504.339.2136
matt@matteatonccim.com

MARTIN O. MILLER III, CCIM, SIOR • PARTNER
OFFICE: 504.414.0703
MOBILE: 504.616.5700
momiller@ccim.net



PROPERTY DESCRIPTION

PRIME RETAIL or OFFICE OPPORTUNITY: Newly constructed modern commercial center positioned at the intersection of Tulane Avenue and South Pierce Street. This premium development features two interconnected buildings offering versatile space configurations suitable for single-tenant occupancy or multi-tenant division. Building A provides 2,810 SF of retail space, while Building B offers 1,950 SF. Ideal for businesses seeking a sophisticated presence in this high-visibility corridor.

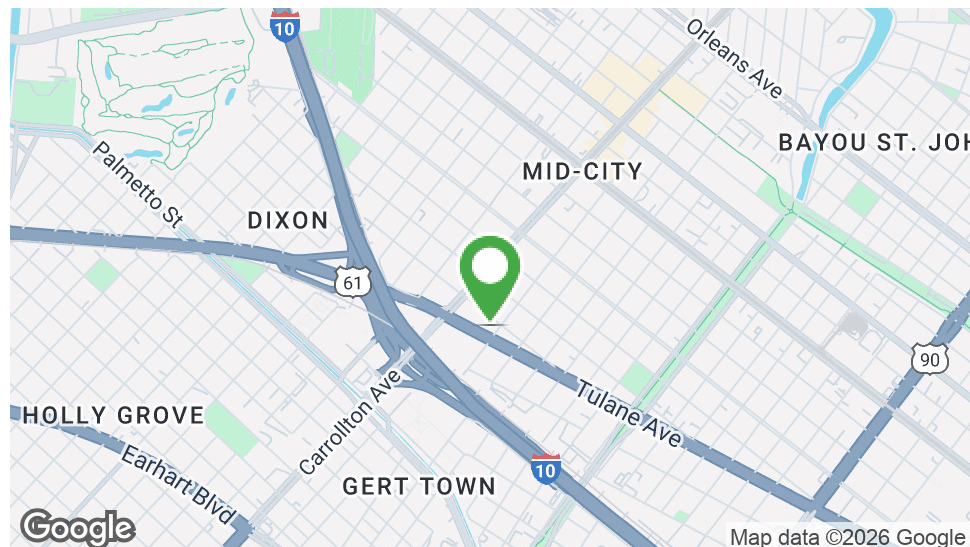

OFFERING SUMMARY

Sale Price:	\$1,800,000
Lease Price:	\$22 PSF (NNN)
Lot Size:	0.24 Acres
Combined Building Size:	4,760 SF

DEMOGRAPHICS	1 MILE	3 MILES	5 MILES
Total Households	10,728	78,397	156,423
Total Population	24,467	170,027	339,227
Average HH Income	\$69,366	\$95,210	\$94,246

RETAIL PROPERTY FOR LEASE OR SALE

PROPERTY SUMMARY





NEW CONSTRUCTION RETAIL/OFFICE

4001 Tulane Ave, New Orleans, LA 70119

MATT EATON, CCIM • PARTNER
OFFICE: 504.414.0703
MOBILE: 504.339.2136
matt@matteatonccim.com

MARTIN O. MILLER III, CCIM, SIOR • PARTNER
OFFICE: 504.414.0703
MOBILE: 504.616.5700
momiller@ccim.net

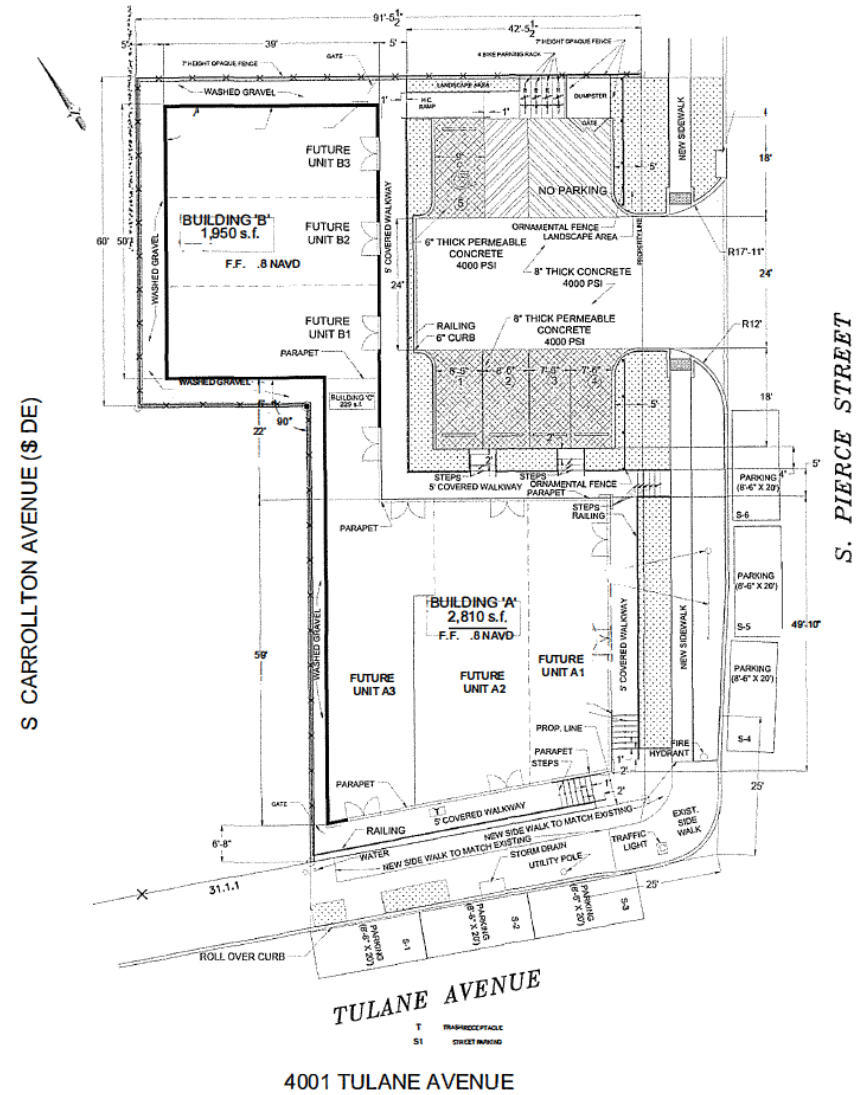

RETAIL PROPERTY FOR LEASE OR SALE

ADDITIONAL PHOTOS





NEW CONSTRUCTION RETAIL/OFFICE

4001 Tulane Ave, New Orleans, LA 70119

MATT EATON, CCIM • PARTNER

OFFICE: 504.414.0703

MOBILE: 504.339.2136

matt@matteatonccim.com

MARTIN O. MILLER III, CCIM, SIOR • PARTNER

OFFICE: 504.414.0703

MOBILE: 504.616.5700

momiller@ccim.net



RETAIL PROPERTY FOR LEASE OR SALE

RETAILER MAP



SOUTHEAST
COMMERCIAL
REAL ESTATE



NEW CONSTRUCTION RETAIL/OFFICE

4001 Tulane Ave, New Orleans, LA 70119

MATT EATON, CCIM • PARTNER
OFFICE: 504.414.0703
MOBILE: 504.339.2136
matt@matteatonccim.com

MARTIN O. MILLER III, CCIM, SIOR • PARTNER
OFFICE: 504.414.0703
MOBILE: 504.616.5700
momiller@ccim.net

POPULATION	1 MILE	3 MILES	5 MILES
Total Population	24,467	170,027	339,227
Average Age	38	40	41
Average Age (Male)	38	39	40
Average Age (Female)	39	41	42

HOUSEHOLDS & INCOME	1 MILE	3 MILES	5 MILES
Total Households	10,728	78,397	156,423
# of Persons per HH	2.3	2.2	2.2
Average HH Income	\$69,366	\$95,210	\$94,246
Average House Value	\$368,614	\$527,034	\$468,668

Demographics data derived from AlphaMap

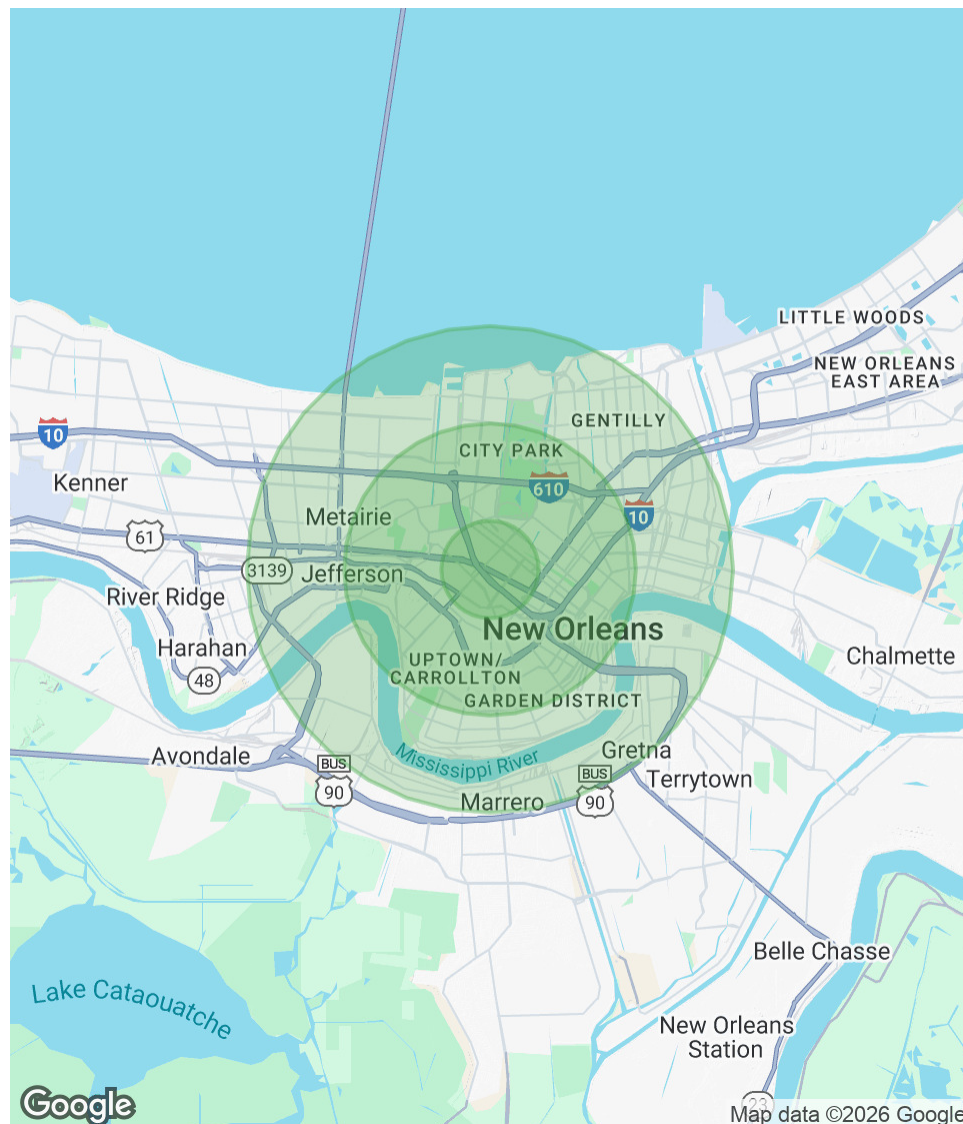

RETAIL PROPERTY FOR LEASE OR SALE

DEMOGRAPHICS MAP & REPORT

