

Office Space For Lease



ReNew Town Center

12100 Singletree Ln, Eden Prairie, MN 55344

Office Space at Multifamily/Mid-Rise Building

- Conveniently located near Interstate 494, Hwy 62, and Eden Prairie Center
- Co-tenants: Adelman Massage, Baker and Baker, Beginning Now, Better Living Hypnosis, CLX Delivery, Cascade at Town Center, Counsel Retirement Plans, David W. Haase DC, Eden Prairie Emergency Veterinarian Services, Eden Prairie Taxi, Health Images LLC, Ivonne Delgado Kuri Realtor, Katherine T Johnson, Martin Azarian Criminal Defense, Mindy Ash Hypnosis Centers, Multiventure Properties, Naiku, Noble Reliable Care, Open Mind LLC, and Mothers Tutoring Academy

Contact us:

Emily Massie

Associate
+1 612 750 6480
emily.massie@colliers.com

Lisa Christianson

Senior Vice President
+1 952 393 1212
lisa.christianson@colliers.com

1600 Utica Avenue S, Suite 300
Minneapolis, MN 55416
P: +1 952 897 7700
colliers.com/msp

Copyright © 2025 Colliers International. Information herein has been obtained from sources deemed reliable, however its accuracy cannot be guaranteed. The user is required to conduct their own due diligence and verification.

For Lease

Building Highlights

Address:	12100 Singletree Ln, Eden Prairie, MN 55344		
Year Built:	2022		
Building Size:	429,988 SF		
Class:	A		
Available Spaces:	C175-179	621 SF	Negotiable (available 6/1/26)
	C188-192	550 SF	Negotiable
	C197	832 SF	Negotiable



Average Household Population

1 mile	5,151
3 miles	30,383
5 miles	78,353

Average Household Income

1 mile	\$75,330
3 miles	\$98,104
5 miles	\$106,682



Traffic Counts

Flying Cloud Dr - 26,500 vpd
Singletree Lane - 8,900 vpd
I-494 - 97,000 vpd

Floor Plan

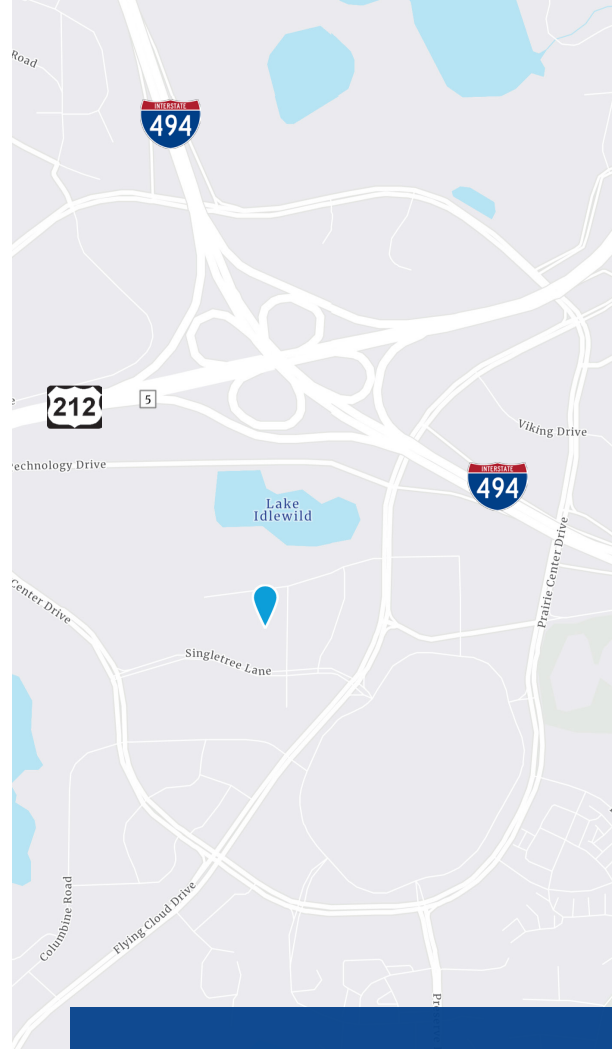
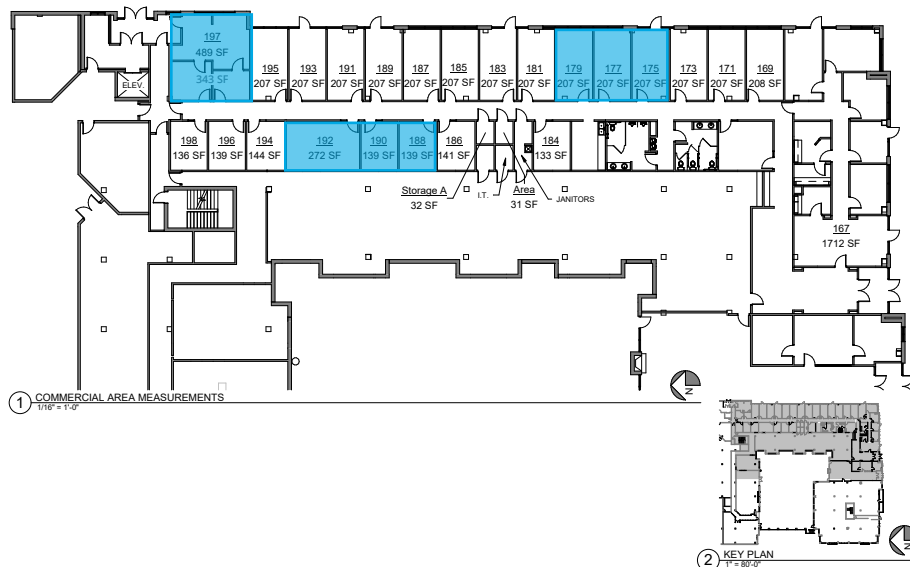

Contact:

Emily Massie

Associate
+1 612 750 6480
emily.massie@colliers.com

Lisa Christianson

Senior Vice President
+1 952 393 1212
lisa.christianson@colliers.com

Colliers

1600 Utica Avenue S, Suite 300
Minneapolis, MN 55416
P: +1 952 897 7700