



RETAIL / OFFICE SPACE FOR LEASE

5535 Cypress Gardens Blvd, Winter Haven, FL 33884

Contact: Trey Gravenstein
Vice President of Brokerage Services

E: Trey@FCPG.com
P: 407.872.0177 ext. 119

Contact: Michael Castrilli
Vice President of Brokerage Services

E: Michael@FCPG.com
P: 407.872.0177 ext. 130

FOR LEASE:

2nd Floor: \$ 16.00 / SF, NNN

Parking Ratio: 4.7 / 1,000 SF

AVAILABILITY:

Suite 210: ± 1,200 SF

Suite 270: ± 2,800 SF



18,443 (10 min)
Total Housing Units



42,500 AADT
Cypress Garden Blvd



40,899 (10 min)
Daytime Population

Class "A" Retail, Office & Medical Space in Winter Haven's fastest growing commercial corridor

Direct site lines on Cypress Garden Blvd. with over 300 ft frontage

2nd floor build-out allowance available

Less than 1 mile from Legoland Florida Theme Park

Located at signalized intersection with 3 access points

Building façade & large digital monument signage available

DEMOGRAPHICS

2025



Total Population

5 Mins

13,769

10 Mins

43,545

15 Mins

88,407



Total Households

5,843

18,443

35,303



Average HH Income

\$91,885

\$96,891

\$88,923

615 E. Colonial Dr., Orlando, FL 32803 Phone: 407.872.0209 www.FCPG.com

Information furnished regarding the subject property is believed to be accurate, but no guarantee or representation is made. References to square footage are approximate. This offering is subject to errors, omissions, prior sale or lease or withdrawal without notice. ©2025 First Capital Property Group, Licensed Real Estate Brokers & Managers.

THE NEIGHBORHOOD

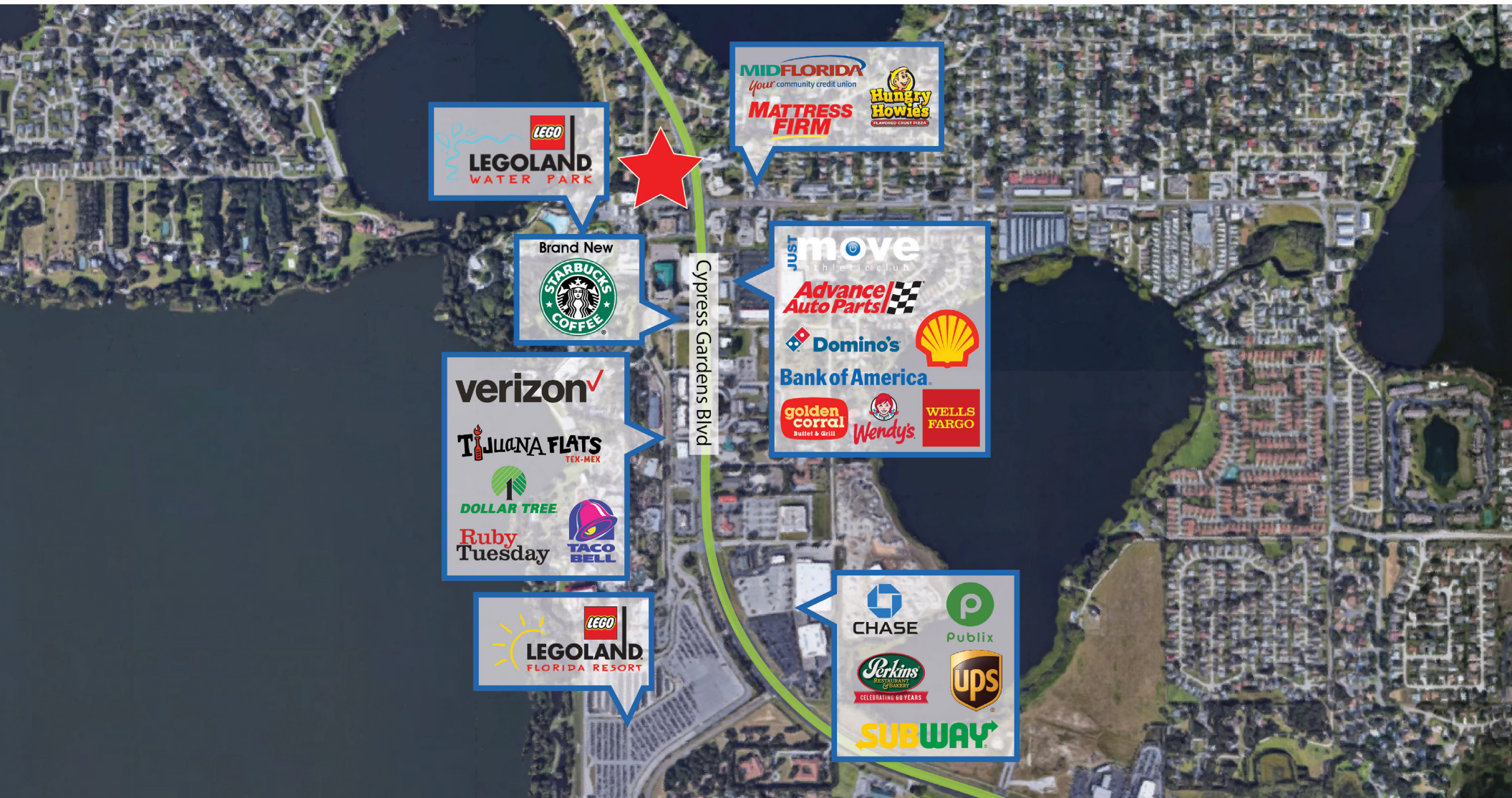

■ 615 E. Colonial Dr., Orlando, FL 32803 ■ Phone: 407.872.0209 ■ www.FCPG.com ■

Information furnished regarding the subject property is believed to be accurate, but no guarantee or representation is made. References to square footage are approximate. This offering is subject to errors, omissions, prior sale or lease or withdrawal without notice. ©2025 First Capital Property Group, Licensed Real Estate Brokers & Managers.

SITE MAP

AVAILABILITY

SECOND FLOOR

OFFICE SPACE - \$16.00 / SF, NNN

Suite 210: ± 1,200 SF | NOW

Suite 270: ± 2,800 SF | 3.1.2026

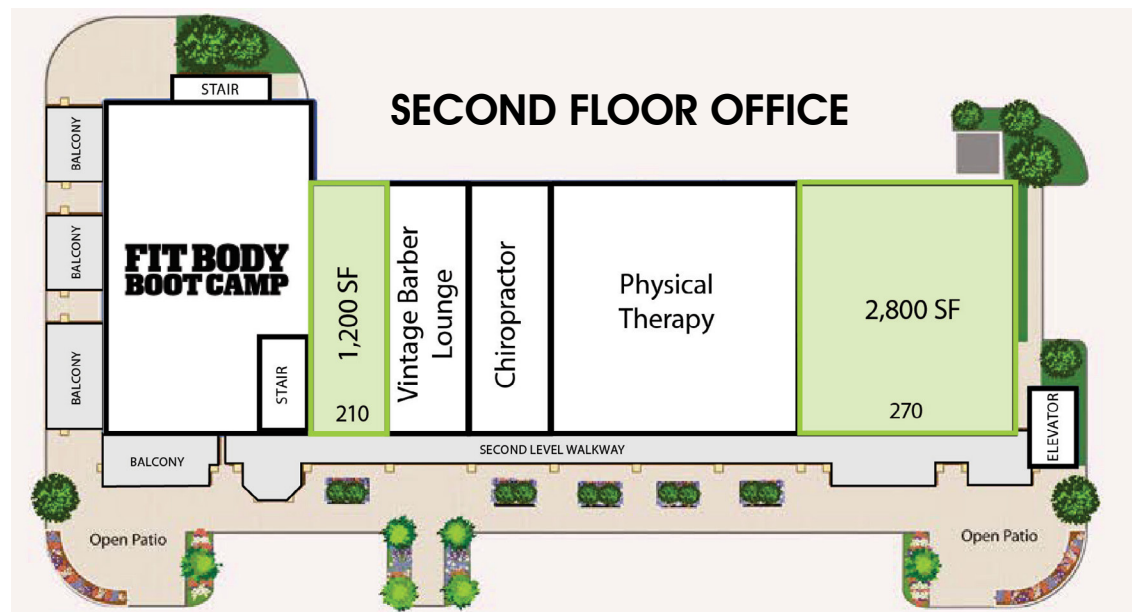

■ 615 E. Colonial Dr., Orlando, FL 32803 ■ Phone: 407.872.0209 ■ www.FCPG.com ■

Information furnished regarding the subject property is believed to be accurate, but no guarantee or representation is made. References to square footage are approximate. This offering is subject to errors, omissions, prior sale or lease or withdrawal without notice. ©2025 First Capital Property Group, Licensed Real Estate Brokers & Managers.