

Titusville Office Space

3380 S. Park Ave, STE 08-09, Titusville, FL 32780

Palkiper
Commercial Real Estate Services
Licensed Real Estate Broker



Lease Rate: \$13psf/yr MG

LOCATION DETAILS

This property is situated across from the Royal Oaks community on S Park Ave with a traffic count of 5,500 cars per day. It is conveniently located less than 1 mile east of South Street (SR 405) and 1 mile west of Barna Ave. Additionally, it's a 6-minute drive from both the I-95 and SR 50 interchange, and from US Hwy 1.

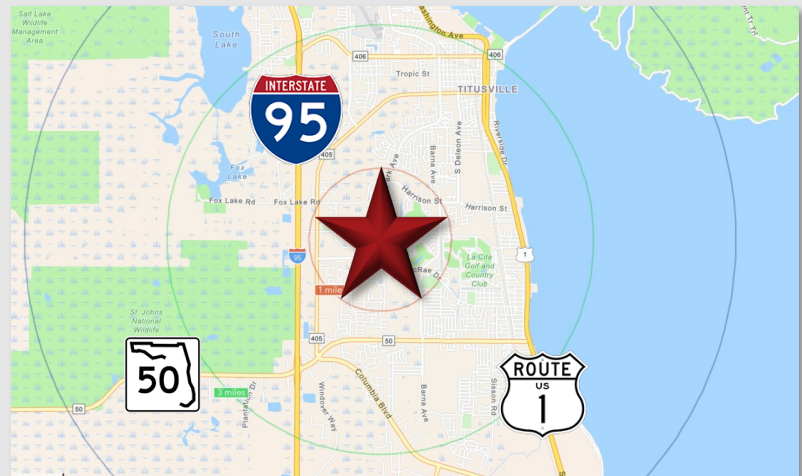

LISTING DETAILS

- **±1,480 SF** office space available for immediate occupancy
- **Full build-out** includes reception/lounge area, kitchen with refrigerator, dishwasher, and microwave, open conference area, two private offices, and two ADA-compliant restrooms.
- Monument signage available
- 2 dedicated parking spaces + shared overflow parking

2025 DEMOGRAPHICS	1-MILE	3-MILE	5-MILE
Population	6,012	41,538	58,037
Average HH Income	\$95,043	\$92,972	\$93,280
Median HH Income	\$76,760	\$71,835	\$73,256

CONTACT FOR MORE INFORMATION

Rebecca Craddock

(407) 227-1197

RebeccaR@palkiper.com

Marie Shorey, CCIM

(407) 383-8142

Marie@palkiper.com

Titusville Office Space

3380 S. Park Ave, STE 08-09, Titusville, FL 32780

 **Palkiper**
Commercial Real Estate Services
Licensed Real Estate Broker



CONTACT FOR MORE INFORMATION

Rebecca Craddock

(407) 227-1197

RebeccaR@palkiper.com

Marie Shorey, CCIM

(407) 383-8142

Marie@palkiper.com

Palkiper has made every effort to obtain the information regarding this property from sources deemed reliable. However, we cannot warrant the complete accuracy thereof subject to errors, omissions, change of price, rental, or other conditions, prior sale, lease or financing or withdrawal without notice.
Licensed Real Estate Broker.

11/17/25 12:07

Titusville Office Space

3380 S. Park Ave, STE 08-09, Titusville, FL 32780

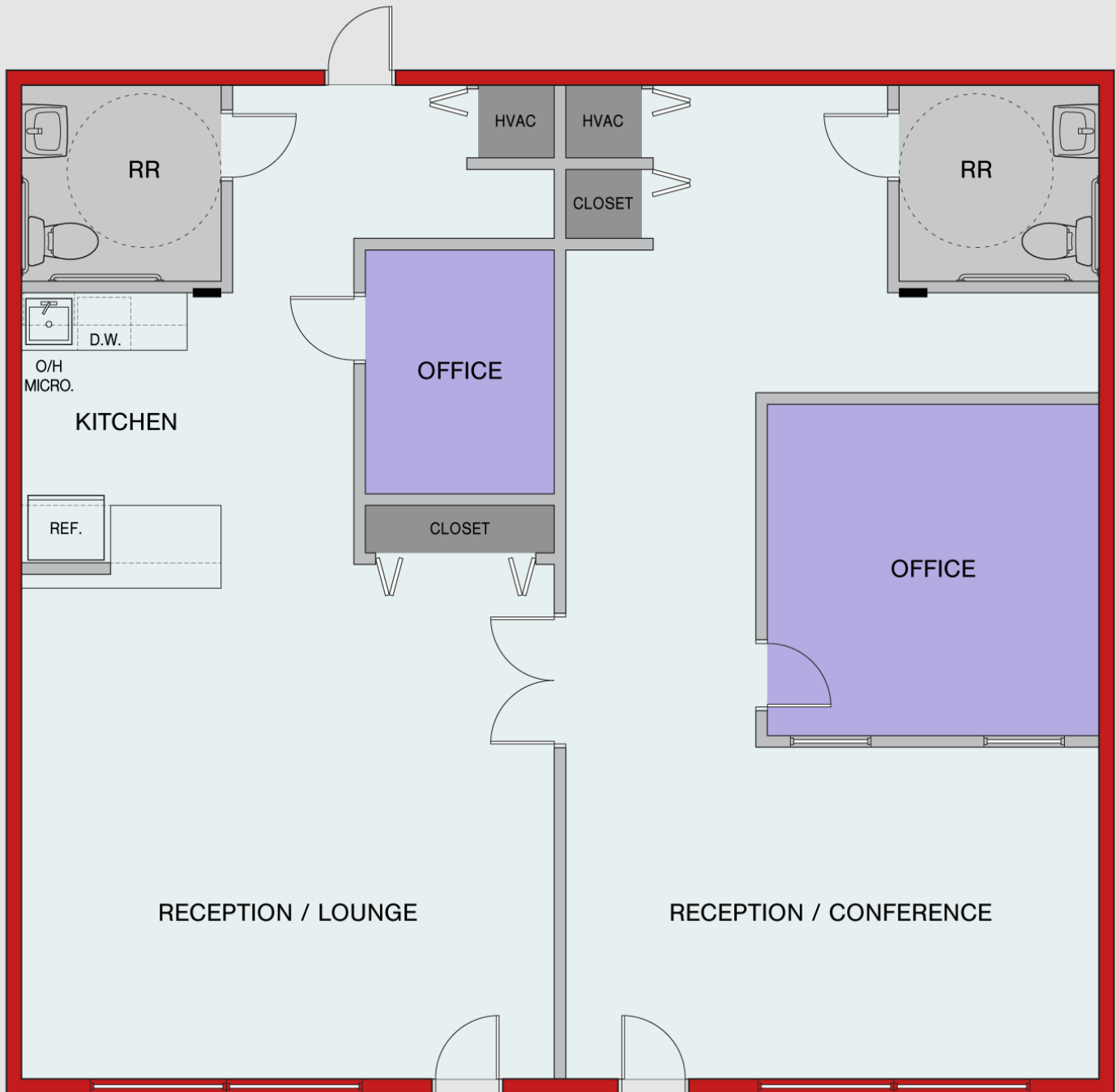

NOT TO SCALE: Illustrated for marketing purposes only.

Any measurements, sizes, and/or dimensions are approximate.

Layout and furnishes shown may vary. Subject to continued revisions.



CONTACT FOR MORE INFORMATION

Rebecca Craddock

(407) 227-1197

RebeccaR@palkiper.com

Marie Shorey, CCIM

(407) 383-8142

Marie@palkiper.com