



Fully Airconditioned Warehouse

LISTING DATA

Available SF: 2,489 SF
Office SF: 403 SF
Doors: One (1) 12'x14' Grade level door
Clear Height: 20'
Power: 3-Phase, 208 Volt
Parking: 2.05/1,000 SF

Comments: This space includes one small private office, reception area, break room with sink, and restroom. The property offers functional space suitable for a wide range of industrial, warehouse, and distribution uses, with convenient access to major Orlando thoroughfares including I-4, Florida's Turnpike, and Orange Avenue.

ECONOMIC DATA

Lease Rate: \$17.00 SF/yr (NNN)

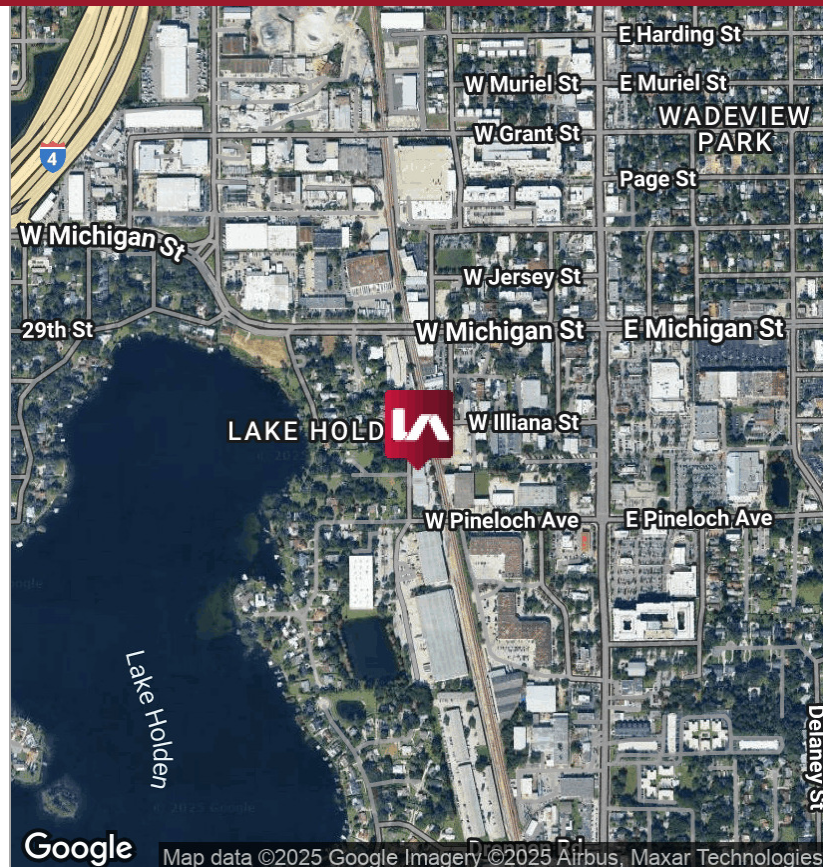

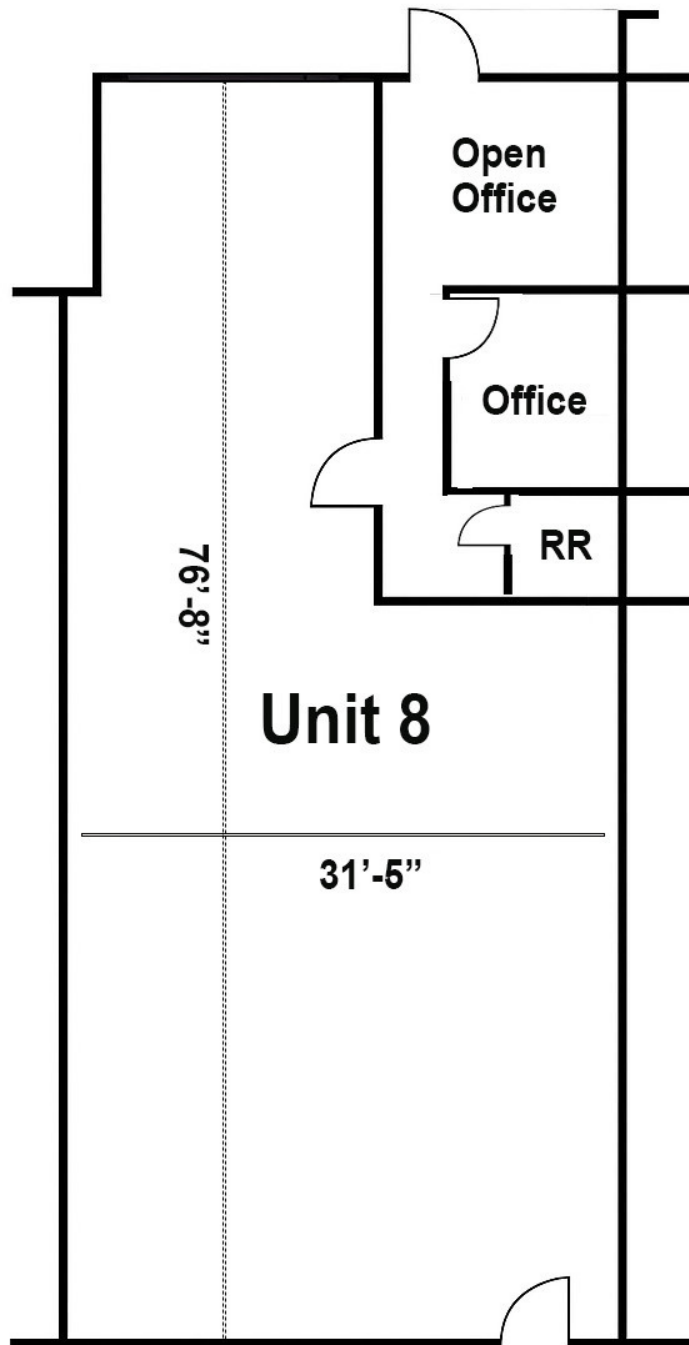

OFFICE AREA = 403 SF
WAREHOUSE AREA = 2,086 SF

