

For Lease

Renovated Office Space

1,975 SF | \$17.50 / SF



Legacy Park

1256-1280 Upsala Road, Sanford, Florida 32771

Property Highlights

- Legacy Park is a recently renovated, three-story office building totaling 23,700± SF
- Each suite offers a private kitchen with refrigerator, in-suite restroom, secure keypad access, and monitored common areas for added safety
- Modernized in 2019 with redesigned lobby, upgraded bathrooms, new lighting, carpet, paint, and kitchens in every suite
- Prime location at SR 46 & Upsala Rd—just minutes to I-4, SR 417 & SR 429, offering easy access to entire Central Florida area
- Situated among abundant retail, restaurants, and upscale residential neighborhoods
- Monument signage on busy Upsala Road
- CAM charges: \$4.27/SF

AVAILABLE SPACES

Space	Lease Rate	Size (SF)
1274	\$17.50/SF NNN	1,975



For more information

Stian Funk

O: 407 949 0747
sfunk@realvest.com

Lease Spaces

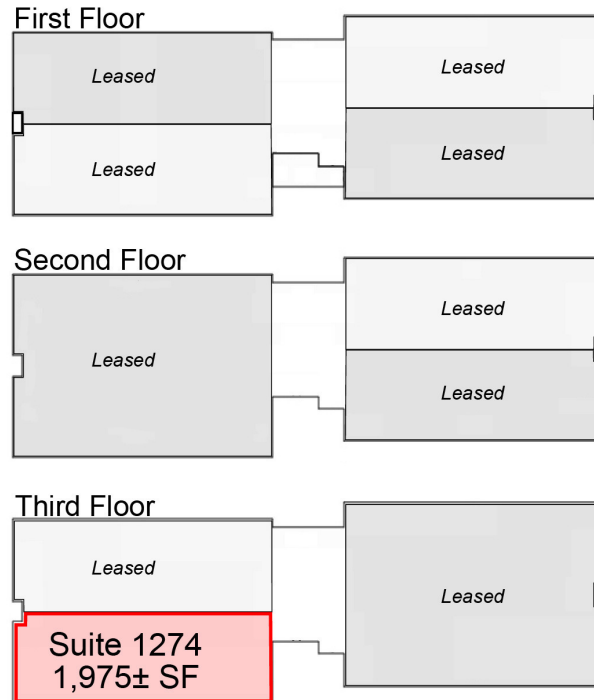

AVAILABLE SPACES

SUITE	SIZE (SF)	LEASE TYPE	LEASE RATE	DESCRIPTION
1274	1,975 SF	NNN	\$17.50 SF/yr	Available Now

Suite 1274 - 1,975± SF (3rd Floor)

[Click Here for 3D Tour](#)

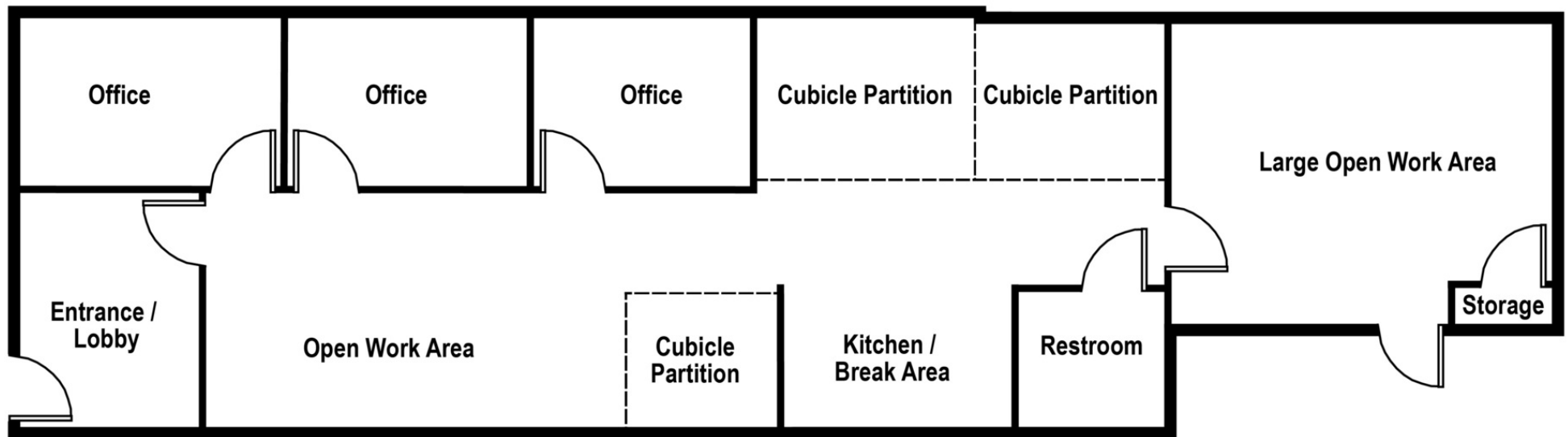

Property Photos



Location Maps

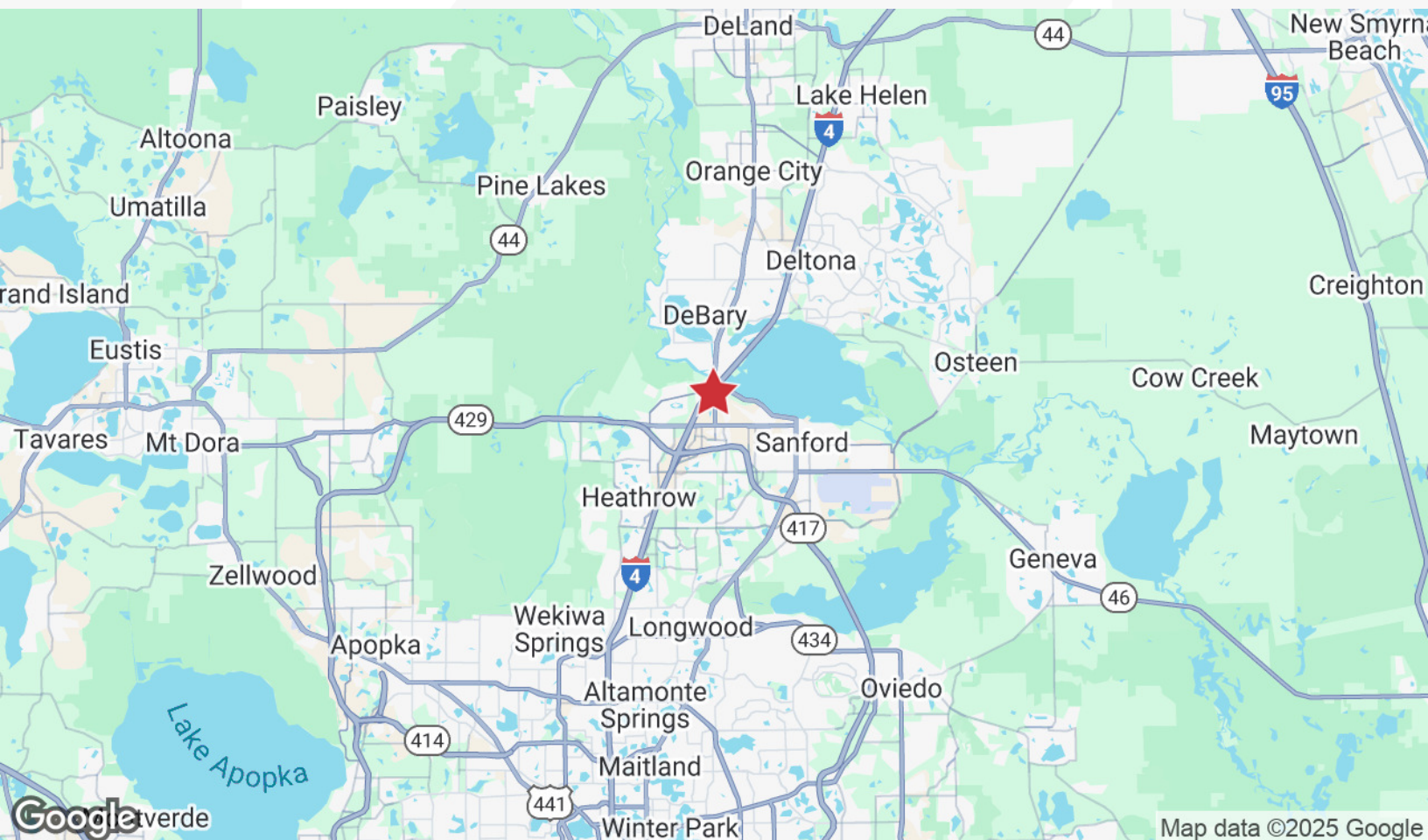
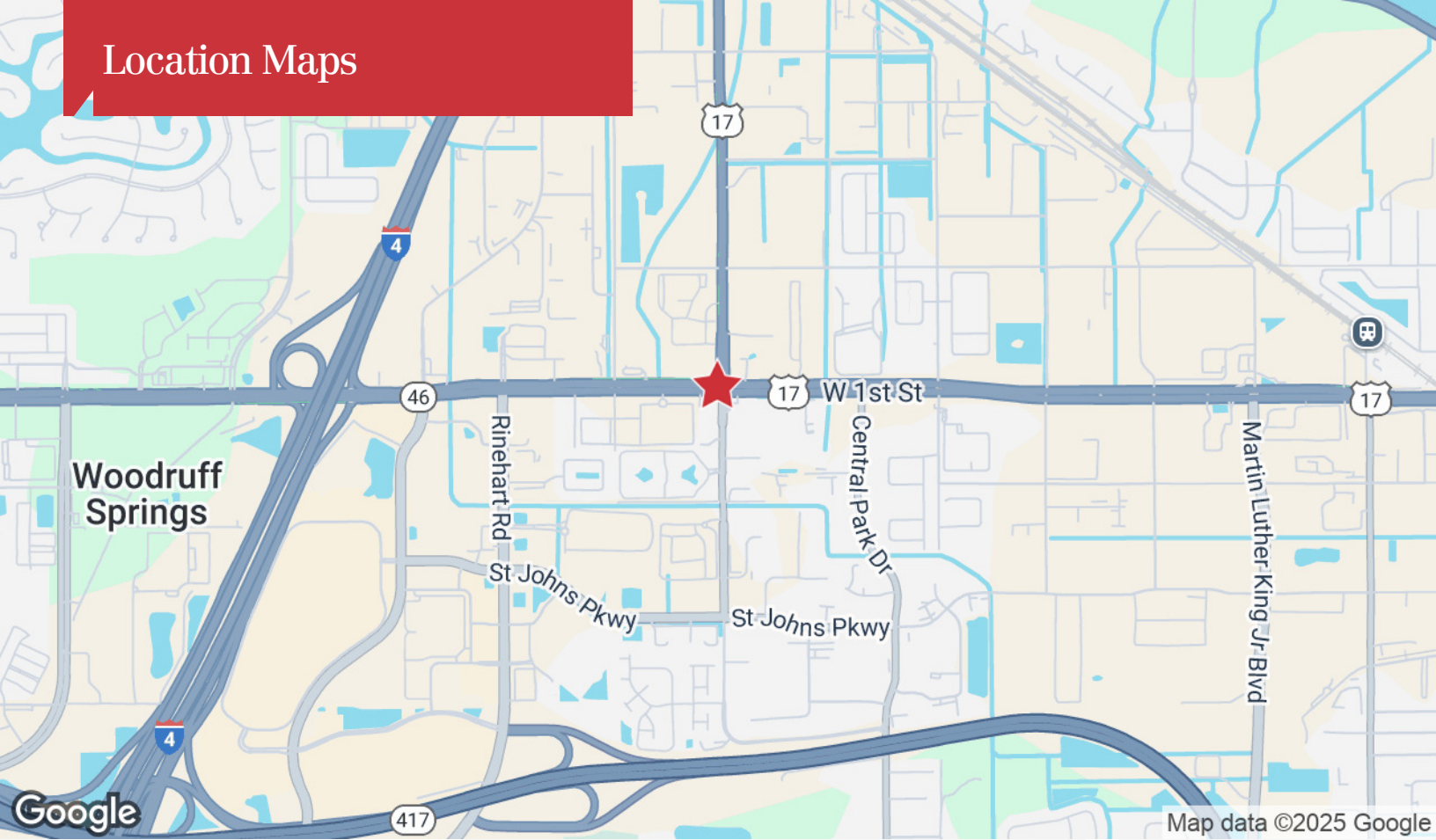

Demographics

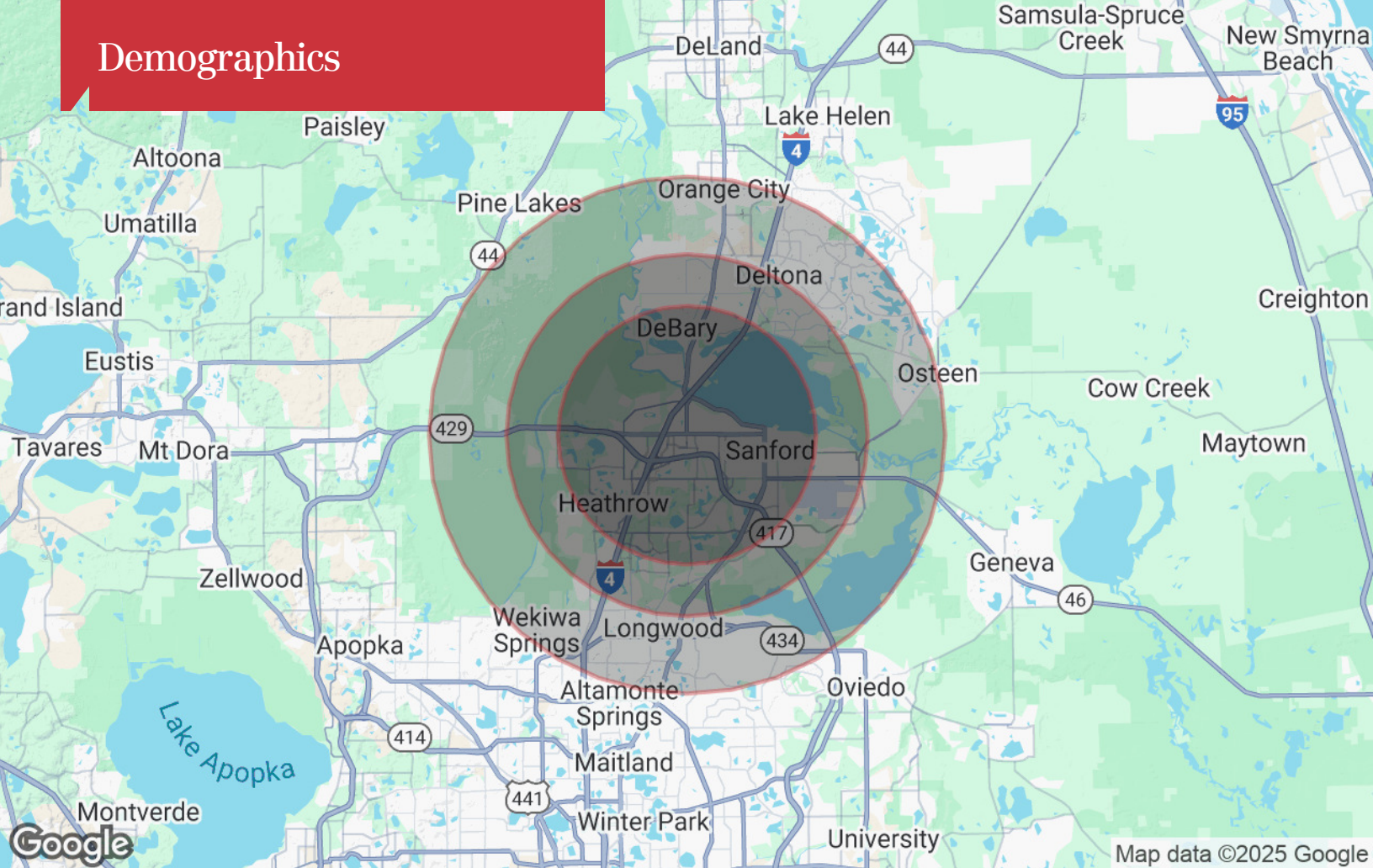

Population

	5 Miles	7 Miles	10 Miles
TOTAL POPULATION	126,942	196,032	321,010
MEDIAN AGE	40	41	42
MEDIAN AGE (MALE)	39	40	40
MEDIAN AGE (FEMALE)	41	42	43

Households & Income

	5 Miles	7 Miles	10 Miles
TOTAL HOUSEHOLDS	48,888	75,091	122,511
# OF PERSONS PER HH	2.6	2.6	2.6
AVERAGE HH INCOME	\$108,357	\$111,181	\$107,021
AVERAGE HOUSE VALUE	\$406,012	\$406,947	\$386,028

* Demographic data derived from 2020 ACS - US Census